



Post Office Box 10279
Wilmington, NC 28404-0279

Phone (910) 452-5861
Fax (910) 452-7563
www.catlinusa.com

July 21, 2008

NAVFAC Mid-Atlantic
Marine Corps North Carolina IPT
Environmental Business Line
Code OPCEV3MA
Attention: Mr. Melvin Acree
6506 Hampton Boulevard
Bldg. C, Room 314
Norfolk, Virginia 23508-1278

Re: **Probe 52**
No Further Action Request - FINAL
Marine Corps Base, Camp Lejeune, North Carolina
NCDENR UST Incident No. 32238
CATLIN Project No. 205-077

Dear Mr. Acree:

Please find below the information required to make a request for No Further Action (NFA) at the Probe 52 project site.

Background

In 2005, Camp Lejeune was requested by North Carolina Department of Environmental and Natural Resources (NCDENR) Underground Storage Tank (UST) Section to perform a Limited Site Assessment (LSA) at the Probe 52 project site along White Street aboard Marine Corps Air Station (MCAS) New River. Figure 1 shows the general location of the Probe 52 site. Due to the close proximity of the Probe 52 project site to the Building AS-4141 project site, in addition to the timing of activities, it was decided to incorporate the LSA information into the Building AS-4141 Remedial Action Optimization (RAO) and Revised Corrective Action Plan Addendum (RCAPA) Report completed by CATLIN Engineers and Scientists (CATLIN).

Monitoring well USTAS4141-MW15 and soil boring JP5SB-01 were installed as part of the Probe 52 LSA activities. The results from soil sample JP5SB-01 collected in December 2005 by CATLIN personnel indicated no contaminant concentrations above the NCDENR Soil-to-Groundwater, Industrial/Commercial or Residential Maximum Soil Contaminant Concentrations (MSCCs) at the Probe 52 project site (See Appendix A). Groundwater samples collected from monitoring well USTAS4141-MW15 in December 2005 by Shaw Environment and Infrastructure, Inc. (Shaw) indicated 1-Methylnaphthalene, 2-Methylnaphthalene and Lead concentrations in excess of the North Carolina 2L Groundwater Quality Standards (2L GWQS). Lead was detected at a concentration of 19.9 µg/L and has an established 2L GWQS of 15 µg/L. 1-Methylnaphthalene and 2-Methylnaphthalene were detected at a concentrations of 38.9

ug/L and 36.2 µg/L, respectively and the established 2L GWQS for these compounds is 14 µg/L (See Figure 2).

CATLIN concluded that the Probe 52 project site met the criteria for Industrial/Commercial Land Use and a Low Risk classification. Therefore, the site met the requirements for No Further Action (NFA) status with respect to soil contamination. However, because groundwater contamination was present in excess of the 2L GWQS, NFA with a Land Use Restriction (LUR) would be applicable at the subject site.

Subsequent Groundwater Sampling

As part of the monitoring activities associated with the Building AS-4141 project site, Shaw collected groundwater samples from monitoring well USTAS4141-MW15 in 2006, 2007 and 2008. As shown on Table 1 (See insert in top left corner of Figure 2), this monitoring well was sampled four times since the LSA activities in 2005 and the analytical results from this subsequent sampling revealed that no contaminants were detected in excess of the 2L GWQS.

Appendix B contains the laboratory reports and chain-of-custody documentation for the groundwater samples collected from monitoring well USTAS4141-MW15 by Shaw.

Recommendations

The following recommendations are based on CATLIN personnel evaluating site findings in accordance with the 2001 Guidelines. The past four sampling events revealed that no contaminant concentrations were in excess of the 2L GWQSs at the Probe 52 project site. Therefore, it is recommended that the site be considered for NFA status. However, CATLIN would recommend that monitoring well USTAS4141-MW15 not be abandoned as this well could be used for plume boundary definition for the Building AS-4141 project site.

Please feel free to contact our office at (910) 452-5861 if you have any questions or require any additional information.

Sincerely,

Shane A. Chasteen
Project Scientist



Michael E. Mason, P.E.
Program Manager

Attachments

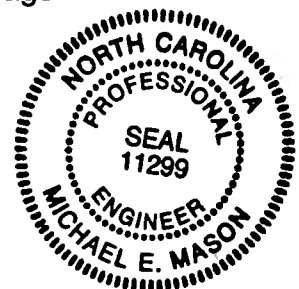
cc: Commanding Officer, Attn: Director I&E/EMD/EQB (w/ encl.)

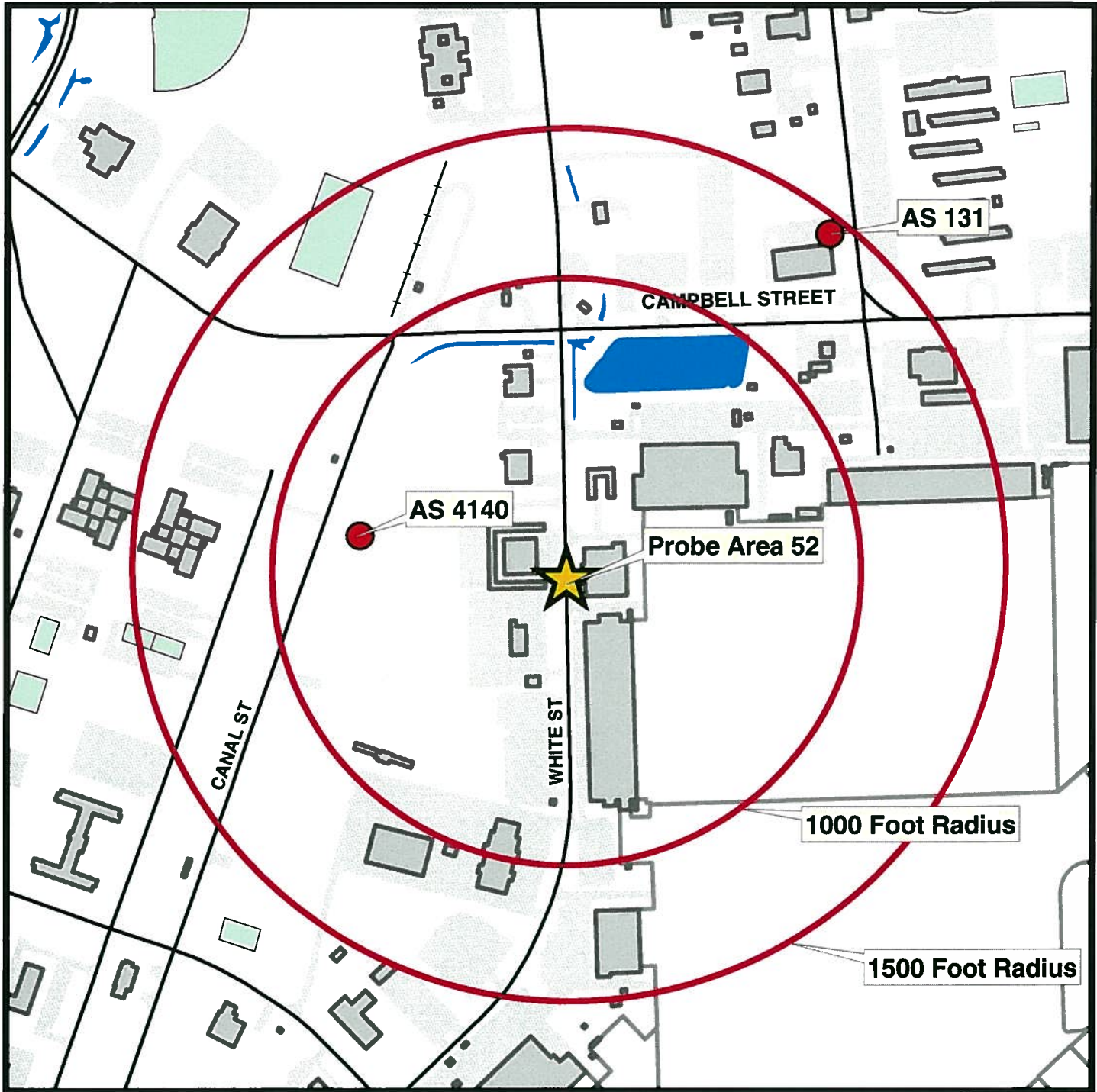

FIGURES



LEGEND

- Water Supply Wells
- ACTIVE
- CLOSED
- INACTIVE
- PENDING
- ▬ Roads
- ▬ Railroads
- ▬ Recreational Horse Trail
- ▭ Buildings and Structures
- ▭ Parking Lots
- ▭ Playgrounds
- ▭ Driveways
- ▭ Athletic Fields
- ▭ Athletic Courts
- ▭ Surface Water
- ▬ Creeks
- ▬ Surface Water



DRAWN BY:	CHECK BY:	APPROVED BY:
SAC	JKB	MEM
CATLIN PROJECT No.: 205-077		

SITE LOCATION MAP

PROBE AREA 52
1500ft. RADIUS WITH RECEPTORS

FIGURE
1

TABLE 1
SUMMARY OF GROUNDWATER LABORATORY RESULTS
EPA METHODS 602, 625 AND 6010B

Incident Name and No.: Probe 52 - 32238

Well ID	EPA Method		602				625				6010B
	Sample ID	Date Collected	Ethylbenzene	1,2-Dichlorobenzene	Methyl-tert butyl ether (MTBE)	All EPA Method 602 Analytes	1-Methylnaphthalene	2-Methylnaphthalene	Naphthalene	All Other EPA Method 625 Analytes	Lead
2L GWQS (µg/L)			550	24	200	Varies	14	14	21	Varies	15
USTAS4141-MW15	USTAS4141-MW15*	12/22/2005**	1.60	NA	NA	BMDL	38.90	36.20	18.10	BMDL	19.90
USTAS4141-MW15	USTAS4141-MW15*	10/20/2006	BMDL	2.60	0.55	BMDL	BMDL	2.20	1.10	BMDL	BMDL
USTAS4141-MW15	USTAS4141-MW15*	3/13/2007	BMDL	5.90	0.52	BMDL	1.40	1.60	BMDL	BMDL	BMDL
USTAS4141-MW15	USTAS4141-MW15*	10/25/2007	BMDL	BMDL	BMDL	BMDL	4.20	4.30	BMDL	BMDL	BMDL
USTAS4141-MW15	USTAS4141-MW15*	3/27/2008	BMDL	BMDL	BMDL	BMDL	2.40	3.00	BMDL	BMDL	BMDL

All results in micrograms per liter (µg/L).

BMDL = Below Method Detection Limit

NA = Not Analyzed

2L GWQS = NCAC T15A:02L Groundwater Quality Standards

Bold results indicate concentrations above 2L GWQS.

* = Samples collected by Shaw

** = Samples analyzed per EPA Method 8260B and 8270C in lieu of 602 and 625

PROBE 52
NO FURTHER ACTION REQUEST
MCAS NEW RIVER



LEGEND

- Monitoring Wells**
 - Type I
 - Type II
 - Type III
 - Pumping Well
 - Unknown Well Type
 - Water Supply Wells
 - Above Ground Storage Tank
 - Underground Storage Tank
 - Railroad Tracks
- Buildings and Structures**
 - Buildings and Structures
 - Demolished Structures
 - Oil/Water Separators
 - Slabs
 - Roads
 - Driveways
 - Parking Lots
 - Surface Water Bodies
 - Creeks and Streams
 - Groundwater Flow Direction
- Vegetation Cover**
 - Forestland
 - Scrubland
 - Wetland
- Airfield Pavement**
 - HELIPAD
 - RAMP
 - RUNWAY
 - SHLDR_OVERRUN
 - TAXIWAY
- Walls and Fences**
 - FENCE
 - GATE
 - WALL

NOTES

- GIS Data Layers provided by MCB Camp Lejeune GIS Department.



SITE MAP WITH GROUNDWATER ANALYTICAL RESULTS

FIGURE

2

Job No.: 205-077 Date: JULY 2008 Scale: AS SHOWN Drawn By: SAC Checked By: MEM

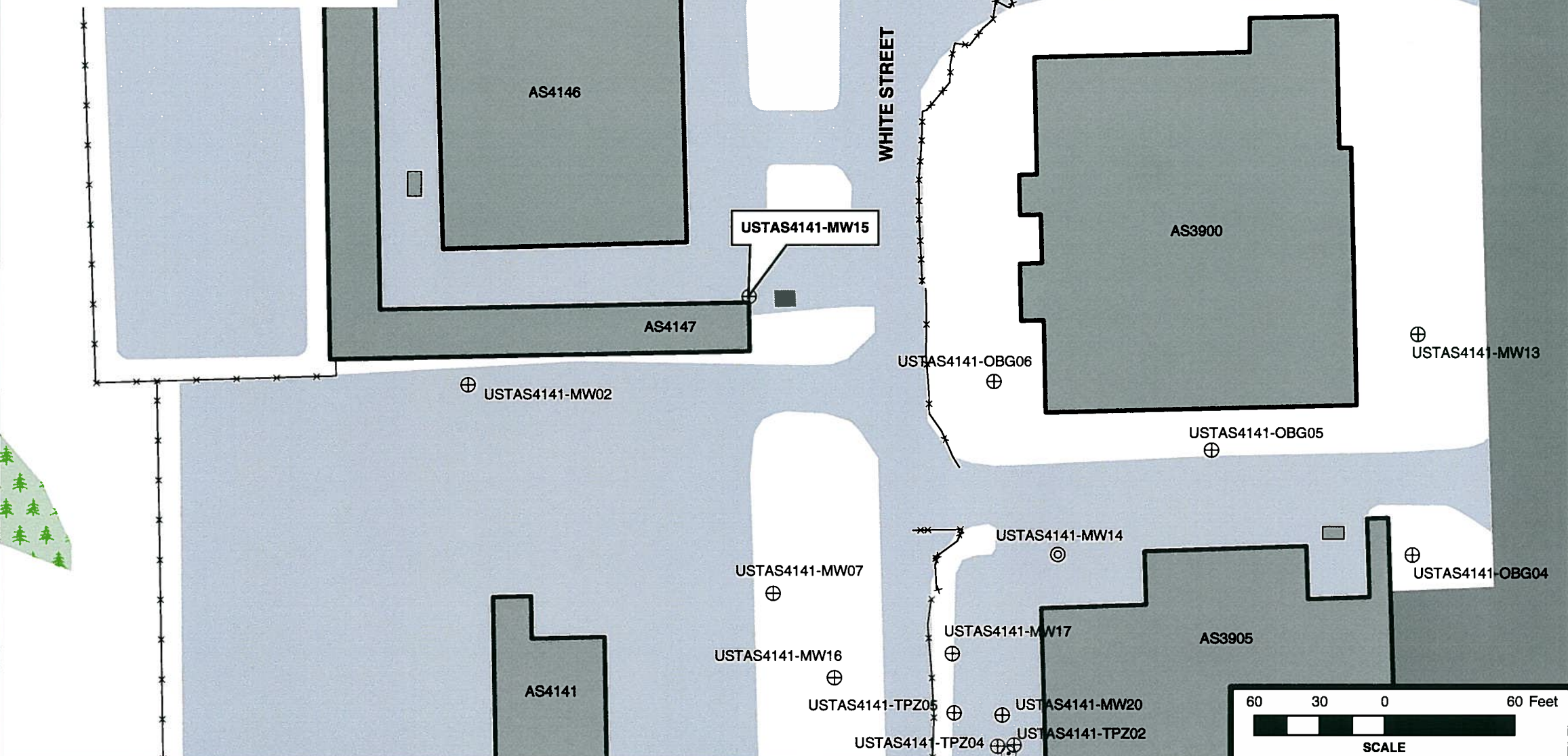

APPENDIX A

**LSA SOIL SAMPLING RESULTS AS PROVIDED IN FIGURES 3, 4 AND 5 OF THE
ADDENDUM RCAP FOR AS-4141 DATED JUNE 12, 2006**

NOTE:

1. SITE MAP ADAPTED FROM SHAW ENVIRONMENTAL, INC. ANNUAL MONITORING REPORT, DATED JANUARY 2004, LEJEUNE GIS DATABASE AND FIELD MEASUREMENTS BY CATLIN IN DECEMBER 2005.
2. JP-5 PIPELINE LOCATION OBTAINED FROM AS-BUILT DRAWING NO. M2, TITLED REPLACE JP-5 FUEL LINE, DATED NOVEMBER 16, 2000. LOCATION SHOULD BE CONSIDERED APPROXIMATE.

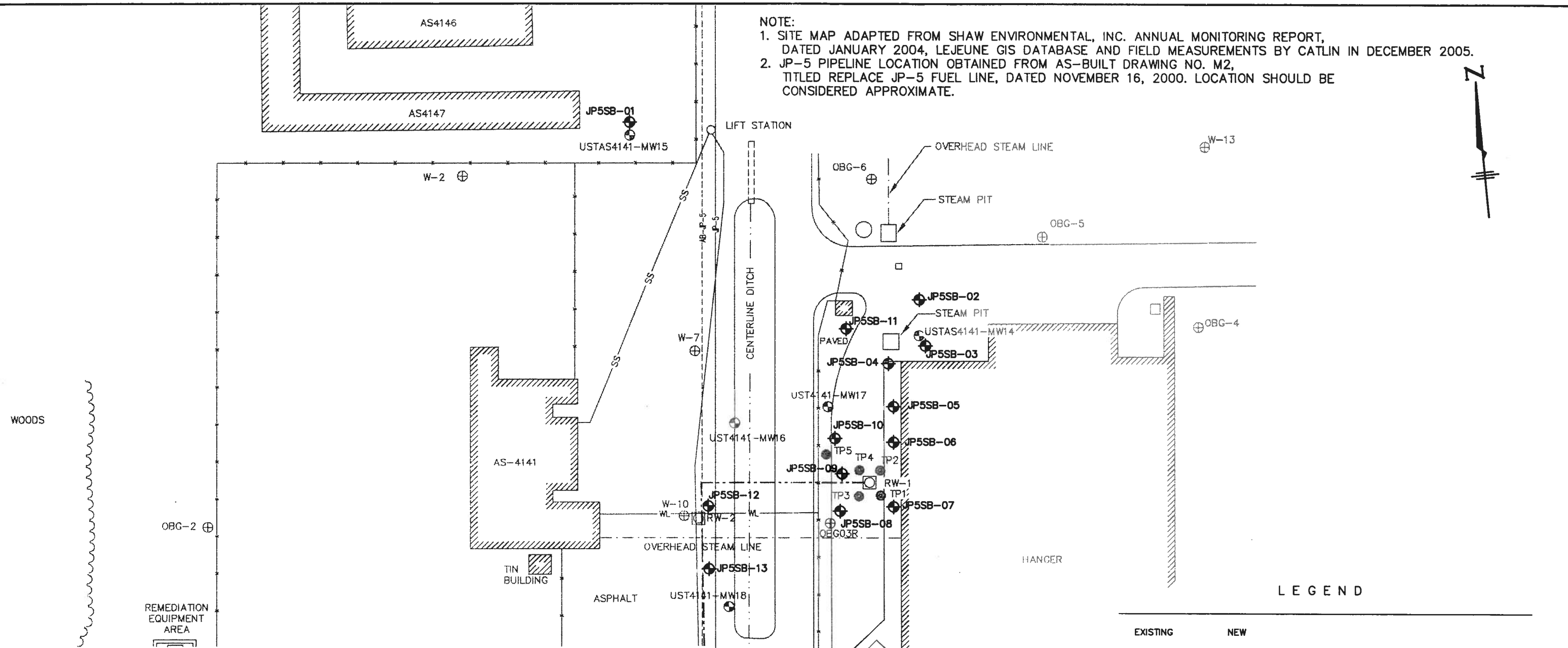

Sample ID	Contaminant of Concern														
	Date Collected	Sample Depth (ft. BLS)	Acetone	2-Butanone	n-Butylbenzene	sec-Butylbenzene	Carbon disulfide	Ethylbenzene	Isopropylbenzene	4-Isopropyltoluene	Methylene chloride	Naphthalene	n-Propyl benzene	1,1,2-Trichloroethane	1,2,4-Trimethylbenzene
Residential MSCC (mg/kg)			1,564	NE	156	156	1564	1,564	1,564	NE	85	63	156	NE	782
Industrial/Commercial MSCC (mg/kg)			40,880	NE	4,088	4,088	40,880	40,000	40,880	NE	763	1,635	4,088	NE	20,440
Soil to Groundwater MSCC (mg/kg)			3	NE	4	3	4	0.24	2	NE	0.02	0.58	2	NE	8
JP5SB-01	12/8/2005	(2-3)	0.0136 J	<0.00289	<0.00313	<0.00327	<0.00246	<0.00284	<0.00301	<0.00318	0.00276 J	<0.00188	<0.003	<0.00241	<0.00262
JP5SB-02	12/1/2005	(2-3)	<1.39	<0.0666	2.90	1.06	<0.0847	0.0905 J	0.132 J	2.50	0.210 J	4.79	0.382 J	<0.110	4.35
JP5SB-03	12/1/2005	(5-6)	<0.175	<0.0566	<0.0141	0.0779	<0.0107	<0.0107	<0.0107	0.0675	0.0483 J	<0.0145	0.0280 J	0.0140 J	<0.0104
JP5SB-04	12/1/2005	(3-4)	0.0107 J	<0.00243	<0.00282	<0.00295	<0.00222	<0.00256	<0.00271	<0.00286	0.00279 J	<0.00169	<0.00270	<0.00217	<0.00236
JP5SB-05	12/1/2005	(3-4)	<1.25	<0.403	2.12	0.789	<0.0762	0.268 J	0.226 J	0.806	0.211 J	5.77	0.566	<0.0988	6.13
JP5SB-06	12/1/2005	(1-2)	<0.00305	<0.00298	<0.00347	<0.00363	<0.00272	<0.00315	<0.00334	<0.00352	<0.00296	<0.00208	<0.00333	<0.00267	<0.00290
JP5SB-07	12/1/2005	(3-4)	<0.277	<0.0896	0.856	0.306	<0.0169	0.0230 J	0.0641 J	0.495	0.0707 J	1.10	0.150	<0.0219	0.902
JP5SB-08	11/30/2005	(3-3.5)	<0.831	<0.269	3.02	1.16	<0.0508	0.116 J	0.313	1.15	0.198 J	7.97	0.715	<0.0658	5.17
JP5SB-09	11/30/2005	(2-3)	0.0354 J	<0.00258	<0.00301	<0.00314	<0.00236	<0.00273	<0.00289	<0.00305	<0.00257	0.00332 J	<0.00288	<0.00231	<0.00251
JP5SB-10	12/1/2005	(0-1)	0.0336 J	0.00397 J	<0.00340	<0.00356	<0.00267	<0.00309	<0.00327	<0.00345	<0.00291	<0.00204	<0.00326	<0.00262	<0.00284
JP5SB-11	12/8/2005	(2-3)	0.0229 J	0.00401 J	<0.00412	<0.00431	0.00356 J	<0.00374	<0.00396	<0.00419	<0.00352	<0.00247	<0.00395	<0.00318	<0.00345
JP5SB-12	12/1/2005	(2-3)	<3.14	<1.02	11.3	3.67	<0.192	0.484 J	0.970	4.13	0.676 J	20.3	2.30	<0.249	25.8
JP5SB-13	12/1/2005	(3-3.75)	0.0190 J	0.00325 J	<0.00316	<0.00330	<0.00248	<0.00286	<0.00303	<0.00320	0.00376 J	<0.00189	<0.00302	<0.00243	<0.00264

All results in mg/kg
 ft. BLS = feet below land surface
 NE = None Established
 J = Estimated concentration, below calibration range and above MDL
 Shaded concentrations exceed the lowest applicable standard

 WILMINGTON, NORTH CAROLINA	PROJECT: BUILDING AS - 4141 ADDENDUM REPORT MARINE CORPS AIR STATION NEW RIVER, N.C.	TITLE: LABORATORY ANALYTICAL RESULTS - SOIL 8260 - DECEMBER 2005	FIGURE: 3
	JOB NO. 204-103 DATE: JUNE 2005	SCALE: 1"=60'	DRAWN BY: KAWS CHECKED BY: JKB

NOTE:
 1. SITE MAP ADAPTED FROM SHAW ENVIRONMENTAL, INC. ANNUAL MONITORING REPORT, DATED JANUARY 2004, LEJEUNE GIS DATABASE AND FIELD MEASUREMENTS BY CATLIN IN DECEMBER 2005.
 2. JP-5 PIPELINE LOCATION OBTAINED FROM AS-BUILT DRAWING NO. M2, TITLED REPLACE JP-5 FUEL LINE, DATED NOVEMBER 16, 2000. LOCATION SHOULD BE CONSIDERED APPROXIMATE.

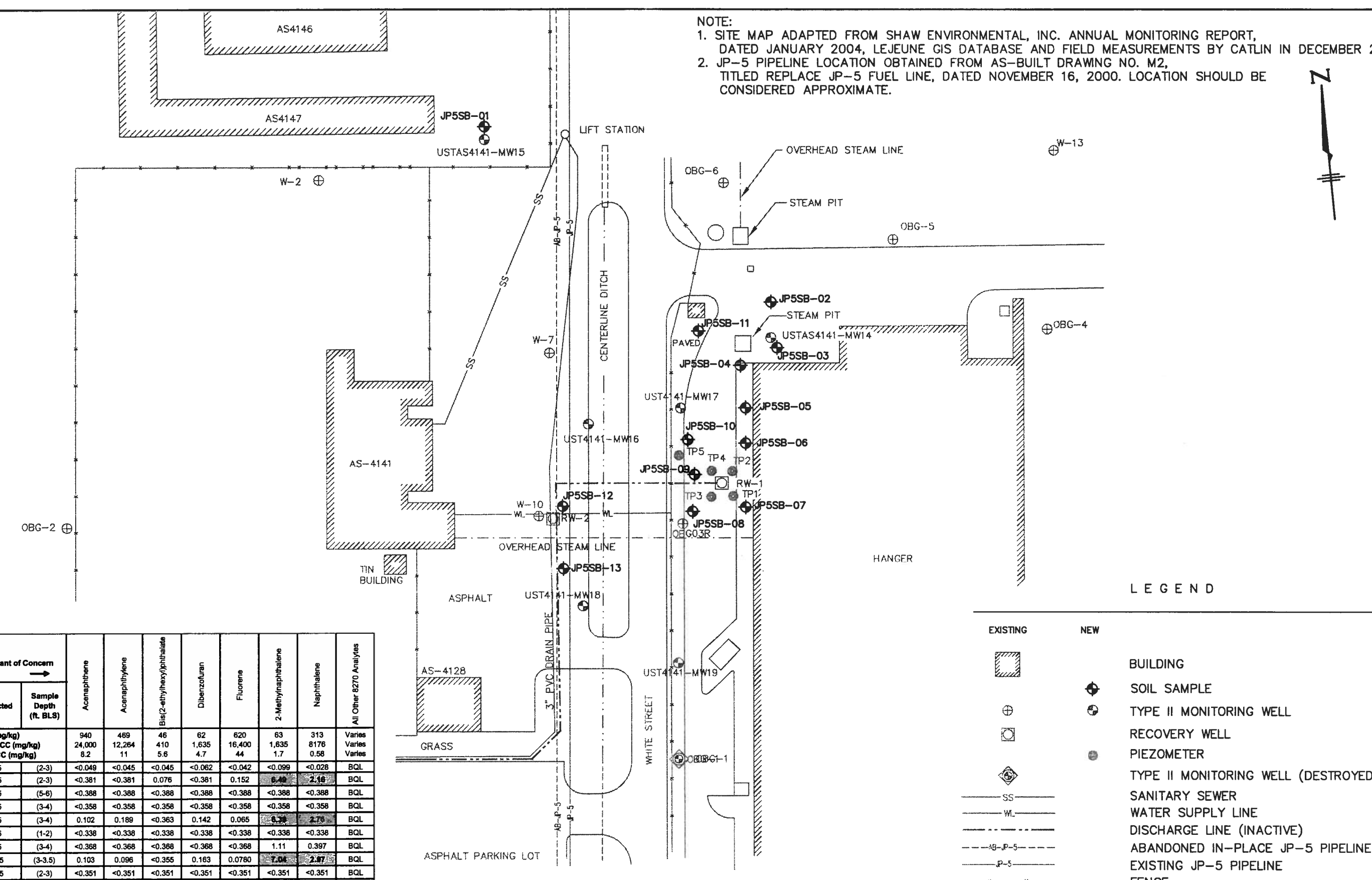
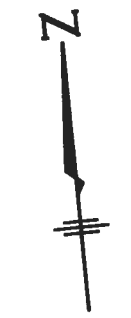

LEGEND

- | | | |
|----------|-----|-------------------------------------|
| EXISTING | NEW | |
| | | BUILDING |
| | | SOIL SAMPLE |
| | | TYPE II MONITORING WELL |
| | | RECOVERY WELL |
| | | PIEZOMETER |
| | | TYPE II MONITORING WELL (DESTROYED) |
| | | SANITARY SEWER |
| | | WATER SUPPLY LINE |
| | | DISCHARGE LINE (INACTIVE) |
| | | ABANDONED IN-PLACE JP-5 PIPELINE |
| | | EXISTING JP-5 PIPELINE |
| | | FENCE |

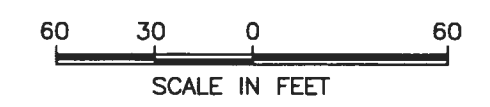

Sample ID	Contaminant of Concern		Acenaphthene	Acenaphthylene	Bis(2-ethylhexyl)phthalate	Dibenzofuran	Fluorene	2-Methylnaphthalene	Naphthalene	All Other 8270 Analytes
	Date Collected	Sample Depth (ft. BLS)								
	Residential MSCC (mg/kg)		940	469	46	62	620	63	313	Varies
	Industrial/Commercial MSCC (mg/kg)		24,000	12,264	410	1,635	16,400	1,635	8176	Varies
	Soil to Groundwater MSCC (mg/kg)		8.2	11	5.6	4.7	44	1.7	0.58	Varies
JP5SB-01	12/8/2005	(2-3)	<0.049	<0.045	<0.045	<0.062	<0.042	<0.099	<0.028	BQL
JP5SB-02	12/1/2005	(2-3)	<0.381	<0.381	0.076	<0.381	0.152	6.49	2.16	BQL
JP5SB-03	12/1/2005	(5-6)	<0.388	<0.388	<0.388	<0.388	<0.388	<0.388	<0.388	BQL
JP5SB-04	12/1/2005	(3-4)	<0.358	<0.358	<0.358	<0.358	<0.358	<0.358	<0.358	BQL
JP5SB-05	12/1/2005	(3-4)	0.102	0.189	<0.363	0.142	0.065	6.38	2.75	BQL
JP5SB-06	12/1/2005	(1-2)	<0.338	<0.338	<0.338	<0.338	<0.338	<0.338	<0.338	BQL
JP5SB-07	12/1/2005	(3-4)	<0.368	<0.368	<0.368	<0.368	<0.368	1.11	0.397	BQL
JP5SB-08	11/30/2005	(3-3.5)	0.103	0.096	<0.355	0.163	0.0780	7.04	2.87	BQL
JP5SB-09	11/30/2005	(2-3)	<0.351	<0.351	<0.351	<0.351	<0.351	<0.351	<0.351	BQL
JP5SB-10	12/1/2005	(0-1)	<0.350	<0.350	<0.350	<0.350	<0.350	<0.350	<0.350	BQL
JP5SB-11	12/8/2005	(2-3)	<0.048	<0.045	<0.045	<0.061	<0.042	<0.098	<0.027	BQL
JP5SB-12	12/1/2005	(2-3)	0.287	<0.363	<0.363	<0.363	0.367	16.8	6.64	BQL
JP5SB-13	12/1/2005	(3-3.75)	<0.377	<0.377	<0.377	<0.377	<0.377	<0.377	<0.377	BQL

All results in mg/kg
 ft. BLS = feet below land surface
 NE = None Established
 BQL = Below Quantitation Limits
 J = Estimated concentration, below calibration range and above MDL
 Shaded concentrations exceed the lowest applicable standard

 CATLIN ENGINEERS and SCIENTISTS WILMINGTON, NORTH CAROLINA	PROJECT: BUILDING AS - 4141 ADDENDUM REPORT MARINE CORPS AIR STATION NEW RIVER, N.C.	TITLE: LABORATORY ANALYTICAL RESULTS - SOIL 8270 - DECEMBER 2005	FIGURE: 4
	JOB NO. 204-103 DATE: JUNE 2005	SCALE: 1"=60'	DRAWN BY: KAWS CHECKED BY: JKB

- NOTE:
 1. SITE MAP ADAPTED FROM SHAW ENVIRONMENTAL, INC. ANNUAL MONITORING REPORT, DATED JANUARY 2004, LEJEUNE GIS DATABASE AND FIELD MEASUREMENTS BY CATLIN IN DECEMBER 2005.
 2. JP-5 PIPELINE LOCATION OBTAINED FROM AS-BUILT DRAWING NO. M2, TITLED REPLACE JP-5 FUEL LINE, DATED NOVEMBER 16, 2000. LOCATION SHOULD BE CONSIDERED APPROXIMATE.

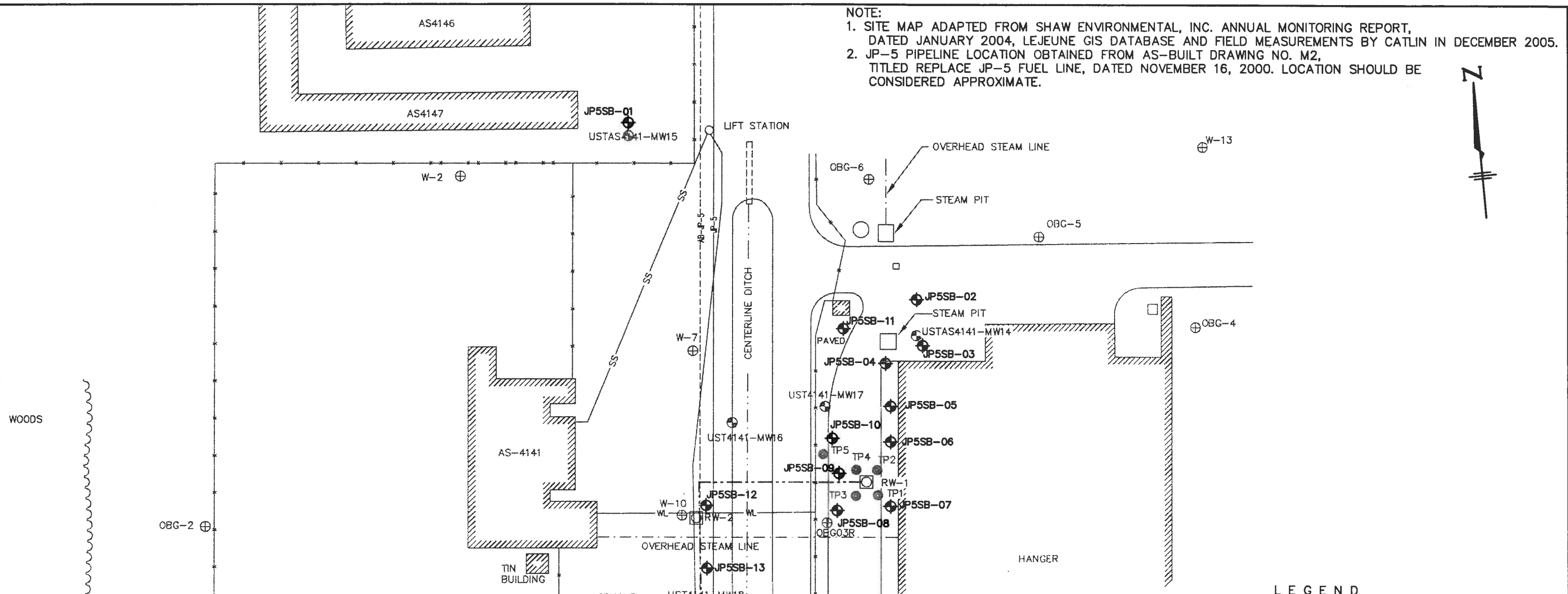

LEGEND

- | | | |
|----------|-----|-------------------------------------|
| EXISTING | NEW | |
| | | BUILDING |
| | | SOIL SAMPLE |
| | | TYPE II MONITORING WELL |
| | | RECOVERY WELL |
| | | PIEZOMETER |
| | | TYPE II MONITORING WELL (DESTROYED) |
| | | SANITARY SEWER |
| | | WATER SUPPLY LINE |
| | | DISCHARGE LINE (INACTIVE) |
| | | ABANDONED IN-PLACE JP-5 PIPELINE |
| | | EXISTING JP-5 PIPELINE |
| | | FENCE |

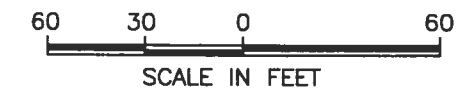

Sample ID	Contaminant of Concern		C5-C8 Aliphatics	C9-C18 Aliphatics	C19-C36 Aliphatics	C9-C22 Aromatics
	Date Collected	Sample Depth (ft BLS)				
Residential MSCC (mg/kg)			939	9,386	93,860	469
Industrial/Commercial MSCC (mg/kg)			24,528	245,280	#	12,264
Soil to Groundwater MSCC (mg/kg)			72	3300	##	34
JP5SB-01	12/8/2005	(2-3)	<10	<30	13	<20
JP5SB-02	12/1/2005	(2-3)	<10	1,790	<50	550
JP5SB-03	12/1/2005	(5-6)	<10	78	<10	34
JP5SB-04	12/1/2005	(3-4)	<10	<20	<10	<20
JP5SB-05	12/1/2005	(3-4)	<10	1,540	<100	500
JP5SB-06	12/1/2005	(1-2)	<10	<20	<10	<20
JP5SB-07	12/1/2005	(3-4)	<10	283	<10	78
JP5SB-08	11/30/2005	(3-3.5)	<10	673	<20	211
JP5SB-09	11/30/2005	(2-3)	<10	<20	<10	<20
JP5SB-10	12/1/2005	(0-1)	<10	<20	<10	12
JP5SB-11	12/8/2005	(2-3)	<10	<20	16	<10
JP5SB-12	12/1/2005	(2-3)	26	4,200	<100	1,350
JP5SB-13	12/1/2005	(3-3.75)	<10	<20	<10	<20

All results in mg/kg
 ft. BLS = feet below land surface
 # Health based level >100%
 ## Considered immobile
 Shaded concentrations exceed the lowest applicable standard

 CATLIN ENGINEERS and SCIENTISTS WILMINGTON, NORTH CAROLINA	PROJECT BUILDING AS - 4141 ADDENDUM REPORT MARINE CORPS AIR STATION NEW RIVER, N.C.	TITLE LABORATORY ANALYTICAL RESULTS - SOIL MADEP COMPARISON TO GUIDELINES - DECEMBER 2005	FIGURE 5
	JOB NO. 204-103 DATE: JUNE 2005	SCALE: 1"=60'	DRAWN BY: KAWS CHECKED BY: JKB

APPENDIX B

LABORATORY REPORTS AND CHAIN-OF-CUSTODY DOCUMENTATION



01/06/06

Technical Report for

Shaw E & I, Inc.

Camp Lejeune-JP-5 Wells

115122

Accutest Job Number: F37523

Sampling Date: 12/22/05

Report to:

Shaw E & I, Inc.
5700 Thurston Ave. Suite 116-B
Virginia Beach, VA 23455
natasha.sullivan@shawgrp.com

ATTN: Natasha Sullivan

Total number of pages in report: 55



Test results contained within this data package meet the requirements of the National Environmental Laboratory Accreditation Conference and/or state specific certification programs as applicable.

Harry Behzadi
Harry Behzadi, Ph.D.
Laboratory Director

Certifications: FL (DOH E83510), NC (573), NJ (FL002), MA (FL946), IA (366), LA (03051), KS (E-10327), SC, AK
This report shall not be reproduced, except in its entirety, without the written approval of Accutest Laboratories.

Table of Contents

Sections:



Section 1: Sample Summary	3
Section 2: Sample Results	4
2.1: F37523-1: USTAS4141-MW15	4
2.2: F37523-2: USTAS4141-MW14	8
2.3: F37523-3: USTAS4141-OBG06	12
2.4: F37523-4: USTAS4141-MW02	16
2.5: F37523-5: USTAS4141-RW2	20
2.6: F37523-6: USTAS4141-RW2-DUP	24
2.7: F37523-7: USTAS4141-TB	28
Section 3: Misc. Forms	30
3.1: Chain of Custody	31
Section 4: GC/MS Volatiles - QC Data Summaries	33
4.1: Method Blank Summary	34
4.2: Blank Spike Summary	38
4.3: Matrix Spike/Matrix Spike Duplicate Summary	42
Section 5: GC/MS Semi-volatiles - QC Data Summaries	46
5.1: Method Blank Summary	47
5.2: Blank Spike Summary	48
5.3: Matrix Spike/Matrix Spike Duplicate Summary	49
Section 6: Metals Analysis - QC Data Summaries	50
6.1: Prep QC MP9066: Pb	51



Sample Summary

Shaw E & I, Inc.

Job No: F37523

Camp Lejeune-JP-5 Wells
Project No: 115122

Sample Number	Collected		Received	Matrix		Client Sample ID
	Date	Time By		Code	Type	
F37523-1	12/22/05	08:45 JH	12/23/05	AQ	Ground Water	USTAS4141-MW15
F37523-2	12/22/05	10:55 JH	12/23/05	AQ	Ground Water	USTAS4141-MW14
F37523-3	12/22/05	10:15 JH	12/23/05	AQ	Ground Water	USTAS4141-OBG06
F37523-4	12/22/05	11:45 JH	12/23/05	AQ	Ground Water	USTAS4141-MW02
F37523-5	12/22/05	13:15 JH	12/23/05	AQ	Ground Water	USTAS4141-RW2
F37523-6	12/22/05	13:15 JH	12/23/05	AQ	Ground Water	USTAS4141-RW2-DUP
F37523-7	12/22/05	00:00 JH	12/23/05	AQ	Trip Blank Water	USTAS4141-TB

Report of Analysis

21
2

Client Sample ID: USTAS4141-MW15	Date Sampled: 12/22/05
Lab Sample ID: F37523-1	Date Received: 12/23/05
Matrix: AQ - Ground Water	Percent Solids: n/a
Method: SW846 8260B	
Project: Camp Lejeune-JP-5 Wells	

Run #	File ID	DF	Analyzed	By	Prep Date	Prep Batch	Analytical Batch
Run #1	M0009679.D	1	01/04/06	KK	n/a	n/a	VM410
Run #2							

Run #	Purge Volume
Run #1	5.0 ml
Run #2	

VOA TCL List

CAS No.	Compound	Result	RL	MDL	Units	Q
67-64-1	Acetone	ND	25	5.0	ug/l	
71-43-2	Benzene	ND	1.0	0.50	ug/l	
75-27-4	Bromodichloromethane	ND	1.0	0.50	ug/l	
75-25-2	Bromoform	ND	1.0	0.50	ug/l	
108-90-7	Chlorobenzene	ND	1.0	0.50	ug/l	
75-00-3	Chloroethane	ND	2.0	1.0	ug/l	
67-66-3	Chloroform	ND	1.0	0.50	ug/l	
75-15-0	Carbon disulfide	ND	2.0	1.0	ug/l	
56-23-5	Carbon tetrachloride	ND	1.0	0.50	ug/l	
75-34-3	1,1-Dichloroethane	ND	1.0	0.50	ug/l	
75-35-4	1,1-Dichloroethylene	ND	1.0	0.50	ug/l	
107-06-2	1,2-Dichloroethane	ND	1.0	0.50	ug/l	
78-87-5	1,2-Dichloropropane	ND	1.0	0.50	ug/l	
124-48-1	Dibromochloromethane	ND	1.0	0.40	ug/l	
156-59-2	cis-1,2-Dichloroethylene	ND	1.0	0.50	ug/l	
10061-01-5	cis-1,3-Dichloropropene	ND	1.0	0.30	ug/l	
156-60-5	trans-1,2-Dichloroethylene	ND	1.0	0.50	ug/l	
10061-02-6	trans-1,3-Dichloropropene	ND	1.0	0.30	ug/l	
100-41-4	Ethylbenzene	1.6	1.0	0.50	ug/l	
591-78-6	2-Hexanone	ND	5.0	2.5	ug/l	
108-10-1	4-Methyl-2-pentanone	ND	5.0	2.5	ug/l	
74-83-9	Methyl bromide	ND	2.0	1.0	ug/l	
74-87-3	Methyl chloride	ND	2.0	1.0	ug/l	
75-09-2	Methylene chloride	ND	5.0	1.0	ug/l	
78-93-3	Methyl ethyl ketone	ND	5.0	2.5	ug/l	
100-42-5	Styrene	ND	1.0	0.50	ug/l	
71-55-6	1,1,1-Trichloroethane	ND	1.0	0.50	ug/l	
79-34-5	1,1,2,2-Tetrachloroethane	ND	1.0	0.40	ug/l	
79-00-5	1,1,2-Trichloroethane	ND	1.0	0.50	ug/l	
127-18-4	Tetrachloroethylene	ND	1.0	0.50	ug/l	
108-88-3	Toluene	ND	1.0	0.50	ug/l	
79-01-6	Trichloroethylene	ND	1.0	0.50	ug/l	

ND = Not detected MDL - Method Detection Limit J = Indicates an estimated value
 RL = Reporting Limit B = Indicates analyte found in associated method blank
 E = Indicates value exceeds calibration range N = Indicates presumptive evidence of a compound

Report of Analysis

Client Sample ID:	USTAS4141-MW15	Date Sampled:	12/22/05
Lab Sample ID:	F37523-1	Date Received:	12/23/05
Matrix:	AQ - Ground Water	Percent Solids:	n/a
Method:	SW846 8260B		
Project:	Camp Lejeune-JP-5 Wells		

VOA TCL List

CAS No.	Compound	Result	RL	MDL	Units	Q
75-01-4	Vinyl chloride	ND	1.0	0.50	ug/l	
1330-20-7	Xylene (total)	ND	3.0	1.0	ug/l	
CAS No.	Surrogate Recoveries	Run# 1	Run# 2	Limits		
1868-53-7	Dibromofluoromethane	106%		86-115%		
17060-07-0	1,2-Dichloroethane-D4	93%		73-126%		
2037-26-5	Toluene-D8	93%		86-112%		
460-00-4	4-Bromofluorobenzene	83%		83-119%		

ND = Not detected MDL - Method Detection Limit
 RL = Reporting Limit
 E = Indicates value exceeds calibration range

J = Indicates an estimated value
 B = Indicates analyte found in associated method blank
 N = Indicates presumptive evidence of a compound

Report of Analysis

2.1
2

Client Sample ID: USTAS4141-MW15	Date Sampled: 12/22/05
Lab Sample ID: F37523-1	Date Received: 12/23/05
Matrix: AQ - Ground Water	Percent Solids: n/a
Method: SW846 8270C SW846 3510C	
Project: Camp Lejeune-JP-5 Wells	

Run #1	File ID	DF	Analyzed	By	Prep Date	Prep Batch	Analytical Batch
Run #2	R00299.D	1	12/30/05	NJ	12/29/05	OP15383	SR18

Run #1	Initial Volume	Final Volume
Run #2	1040 ml	1.0 ml

BN PAH List

CAS No.	Compound	Result	RL	MDL	Units	Q
83-32-9	Acenaphthene	ND	4.8	0.96	ug/l	
208-96-8	Acenaphthylene	ND	4.8	0.96	ug/l	
120-12-7	Anthracene	ND	4.8	0.96	ug/l	
56-55-3	Benzo(a)anthracene	ND	4.8	0.96	ug/l	
50-32-8	Benzo(a)pyrene	ND	4.8	0.96	ug/l	
205-99-2	Benzo(b)fluoranthene	ND	4.8	0.96	ug/l	
191-24-2	Benzo(g,h,i)perylene	ND	4.8	1.9	ug/l	
207-08-9	Benzo(k)fluoranthene	ND	4.8	0.96	ug/l	
218-01-9	Chrysene	ND	4.8	0.96	ug/l	
53-70-3	Dibenzo(a,h)anthracene	ND	4.8	1.9	ug/l	
206-44-0	Fluoranthene	ND	4.8	0.96	ug/l	
86-73-7	Fluorene	ND	4.8	0.96	ug/l	
193-39-5	Indeno(1,2,3-cd)pyrene	ND	4.8	1.9	ug/l	
90-12-0	1-Methylnaphthalene	38.9	4.8	0.96	ug/l	
91-57-6	2-Methylnaphthalene	36.2	4.8	0.96	ug/l	
91-20-3	Naphthalene	18.1	4.8	0.96	ug/l	
85-01-8	Phenanthrene	ND	4.8	0.96	ug/l	
129-00-0	Pyrene	ND	4.8	0.96	ug/l	

CAS No.	Surrogate Recoveries	Run# 1	Run# 2	Limits
4165-60-0	Nitrobenzene-d5	80%		49-119%
321-60-8	2-Fluorobiphenyl	79%		45-118%
1718-51-0	Terphenyl-d14	69%		46-135%

ND = Not detected MDL - Method Detection Limit
 RL = Reporting Limit
 E = Indicates value exceeds calibration range

J = Indicates an estimated value
 B = Indicates analyte found in associated method blank
 N = Indicates presumptive evidence of a compound

Report of Analysis

Client Sample ID: USTAS4141-MW15	Date Sampled: 12/22/05
Lab Sample ID: F37523-1	Date Received: 12/23/05
Matrix: AQ - Ground Water	Percent Solids: n/a
Project: Camp Lejeune-JP-5 Wells	

Metals Analysis

Analyte	Result	RL	MDL	Units	DF	Prep	Analyzed By	Method	Prep Method
Lead	19.9	5.0	1.2	ug/l	1	12/28/05	12/29/05 RS	SW846 6010B ¹	SW846 3010A ²

(1) Instrument QC Batch: MA4731

(2) Prep QC Batch: MP9066

RL = Reporting Limit
MDL = Method Detection Limit

U = Indicates a result < MDL
B = Indicates a result >= MDL but < RL

Misc. Forms

Custody Documents and Other Forms

Includes the following where applicable:

- Chain of Custody

CHAIN-OF-CUSTODY RECORD

COC Number: 115122-122105
P.O. #

F 37523

Shaw The Shaw Group Inc.

SHAW Environmental & Infrastructure, INC. - Piney Green Road, Lot 203 Bldg. 626, 910-451-2390

Client Name		Client Address		Analytical Desired																
Accutest		4408 Vineland Road Suite C-1, Orlando FL 32811 (407) 428-6700																		
Project Name		Site Address																		
Camp Lejeune		JP-5 WELLS																		
Project Number		Client Name																		
115122		Nataasha Kelley Sullivan																		
Client POC		Client Phone																		
LANTDIV		Ron Kenyon																		
Item No	Sample Number	Date	Time	Soil	Water	Sample Description	Number of Containers	Volatiles by EPA-821-0-01-03	Pb by EPA-821-0-01-03	Lead by EPA-821-0-01-03										
1	USTAS4141-MW15	12/22/05	8:45		X	MW15	3 X 40 ml vials, 2 x 11 number, 1 x 500 ml Halogenated HVO3	X	X	X										
2	USTAS4141-MW14	12/22/05	10:55		X	MW14	3 X 40 ml vials, 2 x 11 number, 1 x 500 ml Halogenated HVO3	X	X	X										
3	USTAS4141-OBG03R	NOT SAMPLED PRODUCT IN WELL																		
3	4	USTAS4141-OBG06	12/22/05	10:16		X	OBG06	3 X 40 ml vials, 2 x 11 number, 1 x 500 ml Halogenated HVO3	X	X	X									
4	5	USTAS4141-MW02	12/22/05	11:45		X	MW02	3 X 40 ml vials, 2 x 11 number, 1 x 500 ml Halogenated HVO3	X	X	X									
5	6	USTAS4141-RW2	12/22/05	13:15		X	RW2	3 X 40 ml vials, 2 x 11 number, 1 x 500 ml Halogenated HVO3	X	X	X									
6	7	USTAS4141-RW2-DUP	12/22/05	13:15		X	RW2 DUPLICATE	3 X 40 ml vials, 2 x 11 number, 1 x 500 ml Halogenated HVO3	X	X	X									
7	8	USTAS4141-TB	12/22/05			X	Trip Blank	3 X 40 ml vials	X											

Turnaround Time Required: 14 day

Submitted By: Joe Hurley, Shaw and Jeff Moore, Shaw

CO/PERIS: Laboratory Report No:

Seq#	Transfer/Relinquished By	Date	Time	Transfer/Received By	Date	Time	Remarks
1	Joe Hurley	12/22/05	1600	FX			
2	FX			Jeff Moore	12-23-05	10:00	
3							
4	Fed Ex #s 8530 7647 8050, #8330 7647 8061						

NEESA Level C
Deliverables: EDD Excel
Fax results to Nataasha Sullivan (410) 528-7599

20

3.1
3

ACCUTEST LABORATORIES SAMPLE RECEIPT CONFIRMATION

ACCUTEST'S JOB NUMBER: **F37523** CLIENT: Shaw F&E PROJECT: Comp Labware
 DATE/TIME RECEIVED: 11-23-05/10:00 # OF COOLERS RECEIVED: 1 COOLER TEMPS: 20
 METHOD OF DELIVERY: FEDEX UPS ACCUTEST COURIER GREYHOUND DELIVERY OTHER
 AIRBILL NUMBERS: 853-7647-6061

- COOLER INFORMATION**
- CUSTODY SEAL NOT PRESENT OR NOT INTACT
 - NO COC RECEIVED
 - ANALYSIS REQUESTED IS UNCLEAR OR MISSING
 - SAMPLE DATES OR TIMES UNCLEAR OR MISSING
 - TEMPERATURE CRITERIA NOT MET

- TRIP BLANK INFORMATION**
- TRIP BLANK NOT PROVIDED
 - TRIP BLANK NOT ON COC
 - TRIP BLANK INTACT
 - TRIP BLANK NOT INTACT
 - RECEIVED WATER TRIP BLANK
 - RECEIVED SOIL TRIP BLANK

SOIL INFORMATION

NUMBER OF ENCORES ? 00
 NUMBER OF 5035 FIELD KITS ? 00

SUMMARY OF COMMENTS: Received two T.B.'s. Received one vial broken for MW-15, MW-14. Received one amber broken for RW2-DUP.

- SAMPLE INFORMATION**
- SAMPLE LABELS PRESENT ON ALL BOTTLES
 - CORRECT NUMBER OF CONTAINERS USED
 - SAMPLE RECEIVED IMPROPERLY PRESERVED
 - INSUFFICIENT VOLUME FOR ANALYSIS
 - TIMES ON COC DON'T MATCH LABEL
 - ID'S ON COC DON'T MATCH LABEL
 - VOC VIALS HAVE HEADSPACE (MACRO BUBBLES)
 - BOTTLES RECEIVED BUT ANALYSIS NOT REQUESTED
 - NO BOTTLES RECEIVED FOR ANALYSIS REQUESTED
 - UNCLEAR FILTERING INSTRUCTIONS
 - UNCLEAR COMPOSITING INSTRUCTIONS
 - SAMPLE(S) RECEIVED BROKEN
 - % SOLIDS JAR NOT RECEIVED

TECHNICIAN SIGNATURE/DATE [Signature] / 11-23-05 TECHNICIAN SIGNATURE/DATE _____

ASBD06/22/05

3.1
3



IT'S ALL IN THE CHEMISTRY

11/14/06

Technical Report for

Shaw E & I, Inc.

Camp Lejeune-JP-5 Wells

119909

Accutest Job Number: F44642

Sampling Date: 10/20/06

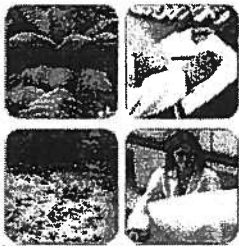

Report to:

Shaw E & I, Inc.

natasha.sullivan@shawgrp.com

ATTN: Natasha Sullivan

Total number of pages in report: 27



Test results contained within this data package meet the requirements of the National Environmental Laboratory Accreditation Conference and/or state specific certification programs as applicable.

Harry Behzadi
Harry Behzadi, Ph.D.
Laboratory Director

Certifications: FL (DOH E83510), NC (573), NJ (FL002), MA (FL946), IA (366), LA (03051), KS (E-10327), SC, AK
This report shall not be reproduced, except in its entirety, without the written approval of Accutest Laboratories.

Table of Contents

Sections:



-1-

Section 1: Sample Summary	3
Section 2: Sample Results	4
2.1: F44642-1: USTASS4141-MW02	5
2.2: F44642-2: USTASS4141-MW15	8
Section 3: Misc. Forms	11
3.1: Chain of Custody	12
Section 4: GC/MS Semi-volatiles - QC Data Summaries	14
4.1: Method Blank Summary	15
4.2: Blank Spike Summary	17
4.3: Matrix Spike/Matrix Spike Duplicate Summary	18
Section 5: GC Volatiles - QC Data Summaries	19
5.1: Method Blank Summary	20
5.2: Blank Spike Summary	21
5.3: Matrix Spike/Matrix Spike Duplicate Summary	22
Section 6: Metals Analysis - QC Data Summaries	23
6.1: Prep QC MP10559: Pb	24



Sample Summary

Shaw E & I, Inc.

Job No: F44642

Camp Lejeune-JP-5 Wells
Project No: 119909

Sample Number	Collected Date	Time By	Received	Matrix Code	Type	Client Sample ID
F44642-1	10/20/06	08:45 KJ	10/21/06	AQ	Ground Water	USTASS4141-MW02
F44642-2	10/20/06	09:45 KJ	10/21/06	AQ	Ground Water	USTASS4141-MW15



IT'S ALL IN THE CHEMISTRY

Sample Results

Report of Analysis

Report of Analysis

Client Sample ID:	USTASS4141-MW15	Date Sampled:	10/20/06
Lab Sample ID:	F44642-2	Date Received:	10/21/06
Matrix:	AQ - Ground Water	Percent Solids:	n/a
Method:	EPA 625 SW846 3510C		
Project:	Camp Lejeune-JP-5 Wells		

Run #	File ID	DF	Analyzed	By	Prep Date	Prep Batch	Analytical Batch
Run #1	R05557.D	1	10/26/06	NJ	10/25/06	OP18281	SR262
Run #2							

Run #	Initial Volume	Final Volume
Run #1	1030 ml	1.0 ml
Run #2		

BN PAH List

CAS No.	Compound	Result	RL	MDL	Units	Q
83-32-9	Acenaphthene	ND	4.9	0.97	ug/l	
208-96-8	Acenaphthylene	ND	4.9	0.97	ug/l	
120-12-7	Anthracene	ND	4.9	0.97	ug/l	
56-55-3	Benzo(a)anthracene	ND	4.9	0.97	ug/l	
50-32-8	Benzo(a)pyrene	ND	4.9	0.97	ug/l	
205-99-2	Benzo(b)fluoranthene	ND	4.9	0.97	ug/l	
191-24-2	Benzo(g,h,i)perylene	ND	4.9	1.9	ug/l	
207-08-9	Benzo(k)fluoranthene	ND	4.9	0.97	ug/l	
218-01-9	Chrysene	ND	4.9	0.97	ug/l	
53-70-3	Dibenzo(a,h)anthracene	ND	4.9	1.9	ug/l	
206-44-0	Fluoranthene	ND	4.9	0.97	ug/l	
86-73-7	Fluorene	ND	4.9	0.97	ug/l	
193-39-5	Indeno(1,2,3-cd)pyrene	ND	4.9	1.9	ug/l	
90-12-0	1-Methylnaphthalene	ND	4.9	0.97	ug/l	
91-57-6	2-Methylnaphthalene	2.2	4.9	0.97	ug/l	J
91-20-3	Naphthalene	1.1	4.9	0.97	ug/l	J
85-01-8	Phenanthrene	ND	4.9	0.97	ug/l	
129-00-0	Pyrene	ND	4.9	0.97	ug/l	

CAS No.	Surrogate Recoveries	Run# 1	Run# 2	Limits
4165-60-0	Nitrobenzene-d5	75%		49-119%
321-60-8	2-Fluorobiphenyl	75%		45-118%
1718-51-0	Terphenyl-d14	69%		46-135%

ND = Not detected MDL - Method Detection Limit
 RL = Reporting Limit
 E = Indicates value exceeds calibration range

J = Indicates an estimated value
 B = Indicates analyte found in associated method blank
 N = Indicates presumptive evidence of a compound

Report of Analysis

Client Sample ID: USTASS4141-MW15	
Lab Sample ID: F44642-2	Date Sampled: 10/20/06
Matrix: AQ - Ground Water	Date Received: 10/21/06
Method: EPA 601/602	Percent Solids: n/a
Project: Camp Lejeune-JP-5 Wells	

Run #	File ID	DF	Analyzed	By	Prep Date	Prep Batch	Analytical Batch
Run #1 ^a	QQ019714.D	1	10/27/06	AF	n/a	n/a	GQ0759
Run #2							

Run #	Purge Volume
Run #1	5.0 ml
Run #2	

Purgeable Aromatics, Full List

CAS No.	Compound	Result	RL	MDL	Units	Q
71-43-2	Benzene	ND	1.0	0.50	ug/l	
108-90-7	Chlorobenzene	ND	1.0	0.50	ug/l	
95-50-1	1,2-Dichlorobenzene	2.6	1.0	0.50	ug/l	
541-73-1	1,3-Dichlorobenzene	ND	1.0	0.50	ug/l	
106-46-7	1,4-Dichlorobenzene	ND	1.0	0.50	ug/l	
100-41-4	Ethylbenzene	ND	1.0	0.50	ug/l	
1634-04-4	Methyl Tert Butyl Ether	0.55	1.0	0.50	ug/l	J
108-88-3	Toluene	ND	1.0	0.50	ug/l	
1330-20-7	Xylenes (total)	ND	3.0	1.0	ug/l	

CAS No.	Surrogate Recoveries	Run# 1	Run# 2	Limits
460-00-4	4-Bromofluorobenzene	103%		71-130%
98-08-8	aaa-Trifluorotoluene	108%		71-124%

(a) All hits confirmed by dual column analysis.

ND = Not detected MDL - Method Detection Limit J = Indicates an estimated value
 RL = Reporting Limit B = Indicates analyte found in associated method blank
 E = Indicates value exceeds calibration range N = Indicates presumptive evidence of a compound

Report of Analysis

Client Sample ID: USTASS4141-MW15	Date Sampled: 10/20/06
Lab Sample ID: F44642-2	Date Received: 10/21/06
Matrix: AQ - Ground Water	Percent Solids: n/a
Project: Camp Lejeune-JP-5 Wells	

Metals Analysis

Analyte	Result	RL	MDL	Units	DF	Prep	Analyzed By	Method	Prep Method
Lead	1.7 U	5.0	1.7	ug/l	1	10/23/06	10/23/06 RS	SW846 6010B ¹	SM 3030C ²

(1) Instrument QC Batch: MA5304

(2) Prep QC Batch: MP10559

RL = Reporting Limit
MDL = Method Detection Limit

U = Indicates a result < MDL
B = Indicates a result >= MDL but < RL



IT'S ALL IN THE CHEMISTRY

Misc. Forms

Custody Documents and Other Forms

Includes the following where applicable:

- Chain of Custody

F44642

COC Number:
119909-JP5-102006-1



CHAIN-OF-CUSTODY RECORD

Shaw E & I - Piney Green Rd. Lot 203 Bld 626 - 910-451-2390							Receiving LAB: Accutest														
Project Name CAMP LEJEUNE - JP 5			Project Location CAMP LEJEUNE, NC				Analysis Desired														
Project Number 119909		Contact Mark Martin		P.O. Number 200935		Reviewed by		Voas +Xylenes 602	PAHs 625	Total Lead by 3030C											
Client Rep US NAVY - LANTDIV			Project Manager Ron Kenyon																		
Item No.	Sample Number	Date	Time	Comp	Grab	Sample Description	Number of Containers														
1	USTASS4141-MW02	10/20/08	8:45		X	USTASS4141-MW02	6	X	X	X											
2	USTASS4141-MW15	10/20/08	9:45		X	USTASS4141-MW15	6	X	X	X											
3																					
4																					
5																					
6																					
7																					
8																					
9																					
10																					

Transfer Number	Item Number	Transfers Relinquished By	Transfers Accepted By	Date	Time	Remarks
1	1 - 2	<i>[Signature]</i>	FedEx 8580 9991 6051	10/20/08	16:00	14 Day TAT NEESA LEVEL C
2		<i>[Signature]</i>	<i>[Signature]</i>	10/20/08	18:00	

2.4

3.1
3

ACCUTEST LABORATORIES SAMPLE RECEIPT CONFIRMATION

ACCUTEST'S JOB NUMBER: F44642 CLIENT: Shaw PROJECT: Complexure
 DATE/TIME RECEIVED: 10/21/06 9:00 # OF COOLERS RECEIVED: 1 COOLER TEMPS: 2.4
 METHOD OF DELIVERY: FEDEX UPS ACCUTEST COURIER GREYHOUND DELIVERY OTHER
 AIRBILL NUMBERS: 8580 99916051

COOLER INFORMATION

- CUSTODY SEAL NOT PRESENT OR NOT INTACT
- CHAIN OF CUSTODY NOT RECEIVED (COC)
- ANALYSIS REQUESTED IS UNCLEAR OR MISSING
- SAMPLE DATES OR TIMES UNCLEAR OR MISSING
- TEMPERATURE CRITERIA NOT MET

TRIP BLANK INFORMATION

- TRIP BLANK PROVIDED
- TRIP BLANK NOT PROVIDED
- TRIP BLANK NOT ON COC
- TRIP BLANK INTACT
- TRIP BLANK NOT INTACT
- RECEIVED WATER TRIP BLANK
- RECEIVED SOIL TRIP BLANK

MISC. INFORMATION

NUMBER OF ENCORES ? 2
 NUMBER OF 5035 FIELD KITS ? 2
 NUMBER OR LAB FILTERED METALS ? 2

SUMMARY OF COMMENTS: Sample 7 one Amber received broken

TECHNICIAN SIGNATURE/DATE [Signature] 10/21/06 TECHNICIAN SIGNATURE/DATE _____ ASBD 10/03/06

SAMPLE INFORMATION

- SAMPLE LABELS NOT PRESENT ON ALL BOTTLES
- CORRECT NUMBER OF CONTAINERS USED
- SAMPLE RECEIVED IMPROPERLY PRESERVED
- INSUFFICIENT VOLUME FOR ANALYSIS
- TIMES ON COC DOES NOT MATCH LABEL(S)
- ID'S ON COC DOES NOT MATCH LABEL(S)
- VOC VIALS HAVE HEADSPACE (MACRO BUBBLES)
- BOTTLES RECEIVED BUT ANALYSIS NOT REQUESTED
- NO BOTTLES RECEIVED FOR ANALYSIS REQUESTED
- UNCLEAR FILTERING INSTRUCTIONS
- UNCLEAR COMPOSITING INSTRUCTIONS
- SAMPLE CONTAINER(S) RECEIVED BROKEN
- % SOLIDS JAR NOT RECEIVED
- 5035 FIELD KIT NOT FROZEN WITHIN 48 HOUR'S
- RESIDUAL CHLORINE PRESENT
(APPLICABLE TO EPA 600 SERIES OR NORTH CAROLINA ORGANICS)

3.1
3



04/02/07

Technical Report for

Osage of Virginia

CTO 0001: AS4141/JP5 MCAS

CTO 0001

Accutest Job Number: F47956

Sampling Dates: 03/13/07 - 03/14/07



Report to:

Osage of Virginia

mcre@osageva.com

ATTN: Mike Cree

Total number of pages in report: 40



Test results contained within this data package meet the requirements of the National Environmental Laboratory Accreditation Conference and/or state specific certification programs as applicable.

Harry Behzadi
Harry Behzadi, Ph.D.
Laboratory Director

Certifications: FL (DOH E83510), NC (573), NJ (FL002), MA (FL946), IA (366), LA (03051), KS (E-10327), SC, AK
This report shall not be reproduced, except in its entirety, without the written approval of Accutest Laboratories.

Table of Contents

Sections:



-1-

Section 1: Sample Summary	3
Section 2: Sample Results	4
2.1: F47956-1: USTAS4141-MW02	5
2.2: F47956-2: USTAS4141-MW07	8
2.3: F47956-3: USTAS4141-MW10	11
2.4: F47956-4: USTAS4141-MW15	14
2.5: F47956-5: USTAS4141-MW16	17
2.6: F47956-6: USTAS4141-MW18	20
2.7: F47956-7: TRIP BLANK	23
Section 3: Misc. Forms	24
3.1: Chain of Custody	25
Section 4: GC/MS Semi-volatiles - QC Data Summaries	27
4.1: Method Blank Summary	28
4.2: Blank Spike Summary	30
4.3: Matrix Spike/Matrix Spike Duplicate Summary	31
Section 5: GC Volatiles - QC Data Summaries	32
5.1: Method Blank Summary	33
5.2: Blank Spike Summary	34
5.3: Matrix Spike/Matrix Spike Duplicate Summary	35
Section 6: Metals Analysis - QC Data Summaries	36
6.1: Prep QC MP11486: Pb	37



Sample Summary

Osage of Virginia

Job No: F47956

CTO 0001: AS4141/JP5 MCAS

Project No: CTO 0001

Sample Number	Collected Date	Time By	Received	Matrix Code	Type	Client Sample ID
F47956-1	03/13/07	16:35 TE	03/15/07	AQ	Ground Water	USTAS4141-MW02
F47956-2	03/14/07	08:42 TE	03/15/07	AQ	Ground Water	USTAS4141-MW07
F47956-3	03/14/07	08:58 TE	03/15/07	AQ	Ground Water	USTAS4141-MW10
F47956-4	03/13/07	15:25 TE	03/15/07	AQ	Ground Water	USTAS4141-MW15
F47956-5	03/13/07	17:34 TE	03/15/07	AQ	Ground Water	USTAS4141-MW16
F47956-6	03/14/07	15:15 TE	03/15/07	AQ	Ground Water	USTAS4141-MW18
F47956-7	03/14/07	00:00 TE	03/15/07	AQ	Trip Blank Water	TRIP BLANK



IT'S ALL IN THE CHEMISTRY

Sample Results

Report of Analysis

Report of Analysis

Client Sample ID: USTAS4141-MW15	Date Sampled: 03/13/07
Lab Sample ID: F47956-4	Date Received: 03/15/07
Matrix: AQ - Ground Water	Percent Solids: n/a
Method: EPA 625 SW846 3510C	
Project: CTO 0001: AS4141/JP5 MCAS	

Run #1	File ID	DF	Analyzed	By	Prep Date	Prep Batch	Analytical Batch
Run #1	U001636.D	1	03/26/07	RB	03/20/07	OP19878	SU80
Run #2							

Run #1	Initial Volume	Final Volume
Run #1	1050 ml	1.0 ml
Run #2		

BN PAH List

CAS No.	Compound	Result	RL	MDL	Units	Q
83-32-9	Acenaphthene	ND	4.8	0.95	ug/l	
208-96-8	Acenaphthylene	ND	4.8	0.95	ug/l	
120-12-7	Anthracene	ND	4.8	0.95	ug/l	
56-55-3	Benzo(a)anthracene	ND	4.8	0.95	ug/l	
50-32-8	Benzo(a)pyrene	ND	4.8	0.95	ug/l	
205-99-2	Benzo(b)fluoranthene	ND	4.8	0.95	ug/l	
191-24-2	Benzo(g,h,i)perylene	ND	4.8	1.9	ug/l	
207-08-9	Benzo(k)fluoranthene	ND	4.8	0.95	ug/l	
218-01-9	Chrysene	ND	4.8	0.95	ug/l	
53-70-3	Dibenzo(a,h)anthracene	ND	4.8	1.9	ug/l	
206-44-0	Fluoranthene	ND	4.8	0.95	ug/l	
86-73-7	Fluorene	ND	4.8	0.95	ug/l	
193-39-5	Indeno(1,2,3-cd)pyrene	ND	4.8	1.9	ug/l	
90-12-0	1-Methylnaphthalene	1.4	4.8	0.95	ug/l	J
91-57-6	2-Methylnaphthalene	1.6	4.8	0.95	ug/l	J
91-20-3	Naphthalene	ND	4.8	0.95	ug/l	
85-01-8	Phenanthrene	ND	4.8	0.95	ug/l	
129-00-0	Pyrene	ND	4.8	0.95	ug/l	

CAS No.	Surrogate Recoveries	Run# 1	Run# 2	Limits
4165-60-0	Nitrobenzene-d5	61%		42-108%
321-60-8	2-Fluorobiphenyl	59%		40-106%
1718-51-0	Terphenyl-d14	60%		39-121%

ND = Not detected MDL - Method Detection Limit
 RL = Reporting Limit
 E = Indicates value exceeds calibration range

J = Indicates an estimated value
 B = Indicates analyte found in associated method blank
 N = Indicates presumptive evidence of a compound

Report of Analysis

Client Sample ID: USTAS4141-MW15	
Lab Sample ID: F47956-4	Date Sampled: 03/13/07
Matrix: AQ - Ground Water	Date Received: 03/15/07
Method: EPA 601/602	Percent Solids: n/a
Project: CTO 0001: AS4141/JP5 MCAS	

Run #	File ID	DF	Analyzed	By	Prep Date	Prep Batch	Analytical Batch
Run #1 ^a	QQ023683.D	1	03/19/07	AF	n/a	n/a	GQQ899
Run #2							

Run #	Purge Volume
Run #1	5.0 ml
Run #2	

Purgeable Aromatics, Full List

CAS No.	Compound	Result	RL	MDL	Units	Q
71-43-2	Benzene	ND	1.0	0.50	ug/l	
108-90-7	Chlorobenzene	ND	1.0	0.50	ug/l	
95-50-1	1,2-Dichlorobenzene	5.9	1.0	0.50	ug/l	
541-73-1	1,3-Dichlorobenzene	ND	1.0	0.50	ug/l	
106-46-7	1,4-Dichlorobenzene	ND	1.0	0.50	ug/l	
100-41-4	Ethylbenzene	ND	1.0	0.50	ug/l	
1634-04-4	Methyl Tert Butyl Ether	0.52	1.0	0.50	ug/l	J
108-88-3	Toluene	ND	1.0	0.50	ug/l	
1330-20-7	Xylenes (total)	ND	3.0	1.0	ug/l	

CAS No.	Surrogate Recoveries	Run# 1	Run# 2	Limits
460-00-4	4-Bromofluorobenzene	111%		70-120%
98-08-8	aaa-Trifluorotoluene	99%		73-118%

(a) All hits confirmed by dual column analysis.

ND = Not detected MDL - Method Detection Limit
 RL = Reporting Limit
 E = Indicates value exceeds calibration range

J = Indicates an estimated value
 B = Indicates analyte found in associated method blank
 N = Indicates presumptive evidence of a compound

Report of Analysis

Client Sample ID: USTAS4141-MW15	Date Sampled: 03/13/07
Lab Sample ID: F47956-4	Date Received: 03/15/07
Matrix: AQ - Ground Water	Percent Solids: n/a
Project: CTO 0001: AS4141/JP5 MCAS	

Metals Analysis

Analyte	Result	RL	Units	DF	Prep	Analyzed By	Method	Prep Method
Lead ^a	< 20	20	ug/l	1	03/15/07	03/15/07 RS	SW846 6010B ¹	SM 3030C ²

(1) Instrument QC Batch: MA5566

(2) Prep QC Batch: MP11486

(a) Elevated reporting limit(s) due to matrix interference.

RL = Reporting Limit



Misc. Forms

Custody Documents and Other Forms

Includes the following where applicable:

- Chain of Custody

ACCUTEST LABORATORIES SAMPLE RECEIPT CONFIRMATION

ACCUTEST'S JOB NUMBER: F47956 CLIENT: Osage of Virginia PROJECT: CTO 0001
 DATE/TIME RECEIVED: 9:00 3-15-07 # OF COOLERS RECEIVED: 2 COOLER TEMPS: 0.6 0.8
 METHOD OF DELIVERY: FEDEX UPS ACCUTEST COURIER GREYHOUND DELIVERY OTHER
 AIRBILL NUMBERS: _____

- COOLER INFORMATION**
- CUSTODY SEAL NOT PRESENT OR NOT INTACT
 - CHAIN OF CUSTODY NOT RECEIVED (COC)
 - ANALYSIS REQUESTED IS UNCLEAR OR MISSING
 - SAMPLE DATES OR TIMES UNCLEAR OR MISSING
 - TEMPERATURE CRITERIA NOT MET

- TRIP BLANK INFORMATION**
- TRIP BLANK PROVIDED
 - TRIP BLANK NOT PROVIDED
 - TRIP BLANK NOT ON COC
 - TRIP BLANK INTACT
 - TRIP BLANK NOT INTACT
 - RECEIVED WATER TRIP BLANK
 - RECEIVED SOIL TRIP BLANK

MISC. INFORMATION

NUMBER OF ENCORES ? 0
 NUMBER OF 5035 FIELD KITS ? 0
 NUMBER OR LAB FILTERED METALS ? 0

SUMMARY OF COMMENTS: _____

TECHNICIAN SIGNATURE/DATE Jmc 3-15-07 TECHNICIAN SIGNATURE/DATE K 03-15-07 ASBD 10/03/06

- SAMPLE INFORMATION**
- SAMPLE LABELS NOT PRESENT ON ALL BOTTLES
 - CORRECT NUMBER OF CONTAINERS USED
 - SAMPLE RECEIVED IMPROPERLY PRESERVED
 - INSUFFICIENT VOLUME FOR ANALYSIS
 - TIMES ON COC DOES NOT MATCH LABEL(S)
 - ID'S ON COC DOES NOT MATCH LABEL(S)
 - VOC VIALS HAVE HEADSPACE (MACRO BUBBLES)
 - BOTTLES RECEIVED BUT ANALYSIS NOT REQUESTED
 - NO BOTTLES RECEIVED FOR ANALYSIS REQUESTED
 - UNCLEAR FILTERING INSTRUCTIONS
 - UNCLEAR COMPOSITING INSTRUCTIONS
 - SAMPLE CONTAINER(S) RECEIVED BROKEN
 - % SOLIDS JAR NOT RECEIVED
 - 5035 FIELD KIT NOT FROZEN WITHIN 48 HOURS
 - RESIDUAL CHLORINE PRESENT

(APPLICABLE TO EPA 800 SERIES OR NORTH CAROLINA ORGANICS)

3.1
3



11/12/07



Technical Report for

Shaw E & I, Inc.

Camp Lejeune-AS4141

126006

Accutest Job Number: F53489

Sampling Date: 10/25/07

Report to:

Shaw E & I, Inc.

natasha.sullivan@shawgrp.com

ATTN: Natasha Sullivan

Total number of pages in report: 36



Test results contained within this data package meet the requirements of the National Environmental Laboratory Accreditation Conference and/or state specific certification programs as applicable.

Harry Behzadi, Ph.D.
Laboratory Director

Client Service contact: Heather Wandrey 407-425-6700

Certifications: FL (DOH E83510), NC (573), NJ (FL002), MA (FL946), IA (366), LA (03051), KS (E-10327), SC, AK

This report shall not be reproduced, except in its entirety, without the written approval of Accutest Laboratories.

Test results relate only to samples analyzed.

Table of Contents

Sections:



Section 1: Sample Summary	3
Section 2: Sample Results	4
2.1: F53489-1: USTAS4141-MW15	5
2.2: F53489-2: USTAS4141-MW16	8
2.3: F53489-3: USTAS4141-MW18	11
2.4: F53489-4: USTAS4141-OBG06	14
Section 3: Misc. Forms	17
3.1: Chain of Custody	18
Section 4: GC/MS Semi-volatiles - QC Data Summaries	20
4.1: Method Blank Summary	21
4.2: Blank Spike Summary	23
4.3: Matrix Spike/Matrix Spike Duplicate Summary	24
Section 5: GC Volatiles - QC Data Summaries	25
5.1: Method Blank Summary	26
5.2: Blank Spike Summary	28
5.3: Matrix Spike/Matrix Spike Duplicate Summary	30
Section 6: Metals Analysis - QC Data Summaries	32
6.1: Prep QC MP13244: Pb	33



Sample Summary

Shaw E & I, Inc.

Job No: F53489

Camp Lejeune-AS4141
Project No: 126006

Sample Number	Collected Date	Time By	Received	Matrix Code	Type	Client Sample ID
F53489-1	10/25/07	09:00 MM	10/26/07	AQ	Ground Water	USTAS4141-MW15
F53489-2	10/25/07	10:15 MM	10/26/07	AQ	Ground Water	USTAS4141-MW16
F53489-3	10/25/07	11:00 MM	10/26/07	AQ	Ground Water	USTAS4141-MW18
F53489-4	10/25/07	13:30 MM	10/26/07	AQ	Ground Water	USTAS4141-OBG06
F53489-5	10/25/07	00:00 MM	10/26/07	AQ	Trip Blank Water	USTAS4141-TRIP BLANK



Sample Results

Report of Analysis

Report of Analysis

Client Sample ID:	USTAS4141-MW15	Date Sampled:	10/25/07
Lab Sample ID:	F53489-1	Date Received:	10/26/07
Matrix:	AQ - Ground Water	Percent Solids:	n/a
Method:	EPA 625 EPA 625		
Project:	Camp Lejeune-AS4141		

Run #	File ID	DF	Analyzed	By	Prep Date	Prep Batch	Analytical Batch
Run #1	R11620.D	1	10/31/07	NJ	10/31/07	OP22963	SR535
Run #2							

Run #	Initial Volume	Final Volume
Run #1	1040 ml	1.0 ml
Run #2		

BN PAH List

CAS No.	Compound	Result	RL	MDL	Units	Q
83-32-9	Acenaphthene	ND	4.8	1.3	ug/l	
208-96-8	Acenaphthylene	ND	4.8	1.1	ug/l	
120-12-7	Anthracene	ND	4.8	0.96	ug/l	
56-55-3	Benzo(a)anthracene	ND	4.8	0.96	ug/l	
50-32-8	Benzo(a)pyrene	ND	4.8	0.96	ug/l	
205-99-2	Benzo(b)fluoranthene	ND	4.8	0.96	ug/l	
191-24-2	Benzo(g,h,i)perylene	ND	4.8	0.96	ug/l	
207-08-9	Benzo(k)fluoranthene	ND	4.8	0.96	ug/l	
218-01-9	Chrysene	ND	4.8	0.96	ug/l	
53-70-3	Dibenzo(a,h)anthracene	ND	4.8	0.96	ug/l	
206-44-0	Fluoranthene	ND	4.8	0.96	ug/l	
86-73-7	Fluorene	ND	4.8	1.2	ug/l	
193-39-5	Indeno(1,2,3-cd)pyrene	ND	4.8	0.96	ug/l	
90-12-0	1-Methylnaphthalene	4.2	4.8	1.2	ug/l	J
91-57-6	2-Methylnaphthalene	4.3	4.8	0.96	ug/l	J
91-20-3	Naphthalene	ND	4.8	1.2	ug/l	
85-01-8	Phenanthrene	ND	4.8	0.96	ug/l	
129-00-0	Pyrene	ND	4.8	0.96	ug/l	

CAS No.	Surrogate Recoveries	Run# 1	Run# 2	Limits
4165-60-0	Nitrobenzene-d5	61%		42-108%
321-60-8	2-Fluorobiphenyl	62%		40-106%
1718-51-0	Terphenyl-d14	66%		39-121%

ND = Not detected MDL - Method Detection Limit
 RL = Reporting Limit
 E = Indicates value exceeds calibration range

J = Indicates an estimated value
 B = Indicates analyte found in associated method blank
 N = Indicates presumptive evidence of a compound

Report of Analysis

Client Sample ID: USTAS4141-MW15	Date Sampled: 10/25/07
Lab Sample ID: F53489-1	Date Received: 10/26/07
Matrix: AQ - Ground Water	Percent Solids: n/a
Method: EPA 601/602	
Project: Camp Lejeune-AS4141	

Run #	File ID	DF	Analyzed	By	Prep Date	Prep Batch	Analytical Batch
Run #1 ^a	QQ030715.D	1	10/30/07	NJ	n/a	n/a	GQQ1163
Run #2							

Run #	Purge Volume
Run #1	5.0 ml
Run #2	

Purgeable Aromatics, Full List

CAS No.	Compound	Result	RL	MDL	Units	Q
71-43-2	Benzene	ND	1.0	0.50	ug/l	
108-90-7	Chlorobenzene	ND	1.0	0.50	ug/l	
95-50-1	1,2-Dichlorobenzene ^b	ND	6.0	6.0	ug/l	
541-73-1	1,3-Dichlorobenzene	ND	1.0	1.0	ug/l	
106-46-7	1,4-Dichlorobenzene	ND	1.0	1.0	ug/l	
100-41-4	Ethylbenzene	ND	1.0	0.50	ug/l	
1634-04-4	Methyl Tert Butyl Ether	ND	1.0	0.50	ug/l	
108-88-3	Toluene	ND	1.0	0.50	ug/l	
1330-20-7	Xylenes (total)	ND	3.0	1.0	ug/l	

CAS No.	Surrogate Recoveries	Run# 1	Run# 2	Limits
460-00-4	4-Bromofluorobenzene	104%		70-120%
98-08-8	aaa-Trifluorotoluene	98%		73-118%

(a) Confirmed by GC/MS

(b) Elevated reporting limits due to matrix interference.

ND = Not detected MDL - Method Detection Limit
 RL = Reporting Limit
 E = Indicates value exceeds calibration range

J = Indicates an estimated value
 B = Indicates analyte found in associated method blank
 N = Indicates presumptive evidence of a compound

Report of Analysis

Client Sample ID: USTAS4141-MW15	Date Sampled: 10/25/07
Lab Sample ID: F53489-1	Date Received: 10/26/07
Matrix: AQ - Ground Water	Percent Solids: n/a
Project: Camp Lejeune-AS4141	

Metals Analysis

Analyte	Result	RL	MDL	Units	DF	Prep	Analyzed By	Method	Prep Method
Lead	2.1 U	5.0	2.1	ug/l	1	10/27/07	10/26/07 RS	SW846 6010B ¹	SM 3030C ²

(1) Instrument QC Batch: MA6076

(2) Prep QC Batch: MP13244

RL = Reporting Limit
MDL = Method Detection Limit

U = Indicates a result < MDL
B = Indicates a result >= MDL but < RL



Misc. Forms

Custody Documents and Other Forms

Includes the following where applicable:

- Chain of Custody

F53489

COC Number:
125709-AS4141-102507



CHAIN-OF-CUSTODY RECORD

Shaw E & I - Piney Green Rd. Lot 203 Bld 626 - 910-451-2390							Receiving LAB: ACCUTEST Analysis Desired													
Project Name			Project Location				Reviewed by	VOC 602/ w xylenes	PAH 625	Total Lead By 3030C										
CAMP LEJEUNE -AS4141			CAMP LEJEUNE, NC																	
Project Number		Contact	P.O. Number																	
125709		Mark Martin																		
Client Rep			Project Manager																	
US NAVY - LANTDIV			Joe Colella																	
Item No.	Sample Number	Date	Time	Comp	Grab	Sample Description	Number of Containers													
1	① USTAS4141-MW15	10/25/07	9:00		X	USTAS4141-MW15	6	X	X	X										
2	② USTAS4141-MW16	10/25/07	10:15		X	USTAS4141-MW16	6	X	X	X										
3	③ USTAS4141-MW18	10/25/07	11:00		X	USTAS4141-MW18	6	X	X	X										
4	④ USTAS4141-OBG06	10/25/07	13:30		X	USTAS4141-OBG06	6	X	X	X										
	⑤ USTAS4151-TRIPBLANK	10/25/07			X	USTAS4151-TRIPBLANK	2	X												
	6																			
	7																			
	8																			
	9																			
	10																			

Transfer Number	Item Number	Transfers Relinquished By	Transfers Accepted By	Date	Time	Remarks
1	1 -- 5	<i>[Signature]</i>	FedEx 8626 7690 6964	10/25/07	16:00	14 Day TAT
2		FX	<i>[Signature]</i>	10/25/07	09:30	
3						

2.4

ACCUTEST LABORATORIES SAMPLE RECEIPT CONFIRMATION

ACCUTEST'S JOB NUMBER: F53489 CLIENT: SHA W PROJECT: Camp Lejeune - AS 4141
 DATE/TIME RECEIVED: 10-26-07 09:30 # OF COOLERS RECEIVED: 1 COOLER TEMPS: 24
 METHOD OF DELIVERY: FEDEX UPS ACCUTEST COURIER GREYHOUND DELIVERY OTHER
 AIRBILL NUMBERS: 8626 7690 6964

COOLER INFORMATION

- CUSTODY SEAL NOT PRESENT OR NOT INTACT
- CHAIN OF CUSTODY NOT RECEIVED (COC)
- ANALYSIS REQUESTED IS UNCLEAR OR MISSING
- SAMPLE DATES OR TIMES UNCLEAR OR MISSING
- TEMPERATURE CRITERIA NOT MET

TRIP BLANK INFORMATION

- TRIP BLANK PROVIDED
- TRIP BLANK NOT PROVIDED
- TRIP BLANK NOT ON COC
- TRIP BLANK INTACT
- TRIP BLANK NOT INTACT
- RECEIVED WATER TRIP BLANK
- RECEIVED SOIL TRIP BLANK

MISC. INFORMATION

NUMBER OF ENCORES ? 0
 NUMBER OF 5035 FIELD KITS ? 0
 NUMBER OR LAB FILTERED METALS ? 0

SUMMARY OF COMMENTS:

Coc states there's a trip blank none provided

SAMPLE INFORMATION

- SAMPLE LABELS NOT PRESENT ON ALL BOTTLES
 - CORRECT NUMBER OF CONTAINERS USED
 - SAMPLE RECEIVED IMPROPERLY PRESERVED
 - INSUFFICIENT VOLUME FOR ANALYSIS
 - TIMES ON COC DOES NOT MATCH LABEL(S)
 - ID'S ON COC DOES NOT MATCH LABEL(S)
 - VOC VIALS HAVE HEADSPACE (MACRO BUBBLES)
 - BOTTLES RECEIVED BUT ANALYSIS NOT REQUESTED
 - NO BOTTLES RECEIVED FOR ANALYSIS REQUESTED
 - UNCLEAR FILTERING INSTRUCTIONS
 - UNCLEAR COMPOSITING INSTRUCTIONS
 - SAMPLE CONTAINER(S) RECEIVED BROKEN
 - % SOLIDS JAR NOT RECEIVED
 - 5035 FIELD KIT NOT FROZEN WITHIN 48 HOURS
 - RESIDUAL CHLORINE PRESENT
- (APPLICABLE TO EPA 600 SERIES OR NORTH CAROLINA ORGANICS)

TECHNICIAN SIGNATURE/DATE Jmc 10-26-07 TECHNICIAN SIGNATURE/DATE Jc 10-26-07 ASBD 10/03/06

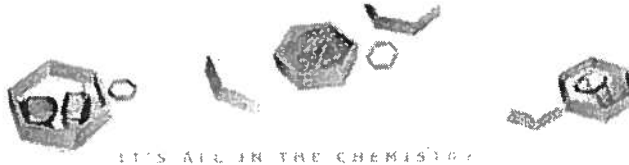

04/23/08

Technical Report for

Shaw E & I, Inc.
Camp Lejeune-AS4141

126006

Accutest Job Number: F56535

Sampling Dates: 03/26/08 - 03/28/08



Report to:

Shaw E & I, Inc.

natasha.sullivan@shawgrp.com

ATTN: Natasha Sullivan

Total number of pages in report: 56



Test results contained within this data package meet the requirements of the National Environmental Laboratory Accreditation Conference and/or state specific certification programs as applicable.

Harry Behzadi, Ph.D.
Laboratory Director

Client Service contact: Heather Wandrey 407-425-6700

Certifications: FL (DOH E83510), NC (573), NJ (FL002), MA (FL946), IA (366), LA (03051), KS (E-10327), SC, AK
This report shall not be reproduced, except in its entirety, without the written approval of Accutest Laboratories.
Test results relate only to samples analyzed.

Table of Contents

Sections:



Section 1: Sample Summary	3
Section 2: Sample Results	4
2.1: F56535-1: USTAS4151-MW15	5
2.2: F56535-2: USTAS4151-MW16	8
2.3: F56535-3: USTAS4151-MW18	11
2.4: F56535-4: USTAS4151-MW14	14
2.5: F56535-5: USTAS4151-OBG06	17
2.6: F56535-6: USTAS4151-MW17	20
2.7: F56535-7: USTAS4151-MW07	23
2.8: F56535-8: USTAS4151-MW10	26
2.9: F56535-9: USTAS4151-MW02	29
2.10: F56535-10: USTAS4151-MW02D	32
2.11: F56535-11: USTAS4151-TRIPBLANK	35
Section 3: Misc. Forms	36
3.1: Chain of Custody	37
Section 4: GC/MS Semi-volatiles - QC Data Summaries	39
4.1: Method Blank Summary	40
4.2: Blank Spike Summary	42
4.3: Matrix Spike/Matrix Spike Duplicate Summary	43
Section 5: GC Volatiles - QC Data Summaries	44
5.1: Method Blank Summary	45
5.2: Blank Spike Summary	47
5.3: Matrix Spike/Matrix Spike Duplicate Summary	49
Section 6: Metals Analysis - QC Data Summaries	51
6.1: Prep QC MP14103: Pb	52



Sample Summary

Shaw E & I, Inc.

Job No: F56535

Camp Lejeune-AS4141
Project No: 126006

Sample Number	Collected Date	Time By	Received	Matrix Code	Type	Client Sample ID
F56535-1	03/27/08	14:00 MM	03/29/08	AQ	Ground Water	USTAS4151-MW15
F56535-2	03/27/08	14:40 MM	03/29/08	AQ	Ground Water	USTAS4151-MW16
F56535-3	03/27/08	15:15 MM	03/29/08	AQ	Ground Water	USTAS4151-MW18
F56535-4	03/28/08	07:00 MM	03/29/08	AQ	Ground Water	USTAS4151-MW14
F56535-5	03/28/08	08:00 MM	03/29/08	AQ	Ground Water	USTAS4151-OBG06
F56535-6	03/28/08	08:45 MM	03/29/08	AQ	Ground Water	USTAS4151-MW17
F56535-7	03/28/08	09:30 MM	03/29/08	AQ	Ground Water	USTAS4151-MW07
F56535-8	03/28/08	10:50 MM	03/29/08	AQ	Ground Water	USTAS4151-MW10
F56535-9	03/28/08	11:15 MM	03/29/08	AQ	Ground Water	USTAS4151-MW02
F56535-10	03/28/08	11:15 MM	03/29/08	AQ	Ground Water	USTAS4151-MW02D
F56535-11	03/26/08	00:00 MM	03/29/08	AQ	Trip Blank Water	USTAS4151-TRIPBLANK



Sample Results

Report of Analysis

Report of Analysis

Client Sample ID: USTAS4151-MW15	Date Sampled: 03/27/08
Lab Sample ID: F56535-1	Date Received: 03/29/08
Matrix: AQ - Ground Water	Percent Solids: n/a
Method: EPA 625 EPA 625	
Project: Camp Lejeune-AS4141	

Run #	File ID	DF	Analyzed	By	Prep Date	Prep Batch	Analytical Batch
Run #1	X001560.D	1	04/05/08	NJ	04/02/08	OP24597	SX79
Run #2							

Run #	Initial Volume	Final Volume
Run #1	1030 ml	1.0 ml
Run #2		

BN PAH List

CAS No.	Compound	Result	RL	MDL	Units	Q
83-32-9	Acenaphthene	ND	4.9	1.4	ug/l	
208-96-8	Acenaphthylene	ND	4.9	1.1	ug/l	
120-12-7	Anthracene	ND	4.9	0.97	ug/l	
56-55-3	Benzo(a)anthracene	ND	4.9	0.97	ug/l	
50-32-8	Benzo(a)pyrene	ND	4.9	0.97	ug/l	
205-99-2	Benzo(b)fluoranthene	ND	4.9	0.97	ug/l	
191-24-2	Benzo(g,h,i)perylene	ND	4.9	0.97	ug/l	
207-08-9	Benzo(k)fluoranthene	ND	4.9	0.97	ug/l	
218-01-9	Chrysene	ND	4.9	0.97	ug/l	
53-70-3	Dibenzo(a,h)anthracene	ND	4.9	0.97	ug/l	
206-44-0	Fluoranthene	ND	4.9	0.97	ug/l	
86-73-7	Fluorene	ND	4.9	1.2	ug/l	
193-39-5	Indeno(1,2,3-cd)pyrene	ND	4.9	0.97	ug/l	
90-12-0	1-Methylnaphthalene	2.4	4.9	1.3	ug/l	J
91-57-6	2-Methylnaphthalene	3.0	4.9	0.97	ug/l	J
91-20-3	Naphthalene	ND	4.9	1.2	ug/l	
85-01-8	Phenanthrene	ND	4.9	0.97	ug/l	
129-00-0	Pyrene	ND	4.9	0.97	ug/l	

CAS No.	Surrogate Recoveries	Run# 1	Run# 2	Limits
4165-60-0	Nitrobenzene-d5	79%		42-108%
321-60-8	2-Fluorobiphenyl	75%		40-106%
1718-51-0	Terphenyl-d14	83%		39-121%

ND = Not detected MDL - Method Detection Limit
 RL = Reporting Limit
 E = Indicates value exceeds calibration range

J = Indicates an estimated value
 B = Indicates analyte found in associated method blank
 N = Indicates presumptive evidence of a compound

Report of Analysis

Client Sample ID:	USTAS4151-MW15	Date Sampled:	03/27/08
Lab Sample ID:	F56535-1	Date Received:	03/29/08
Matrix:	AQ - Ground Water	Percent Solids:	n/a
Method:	EPA 602		
Project:	Camp Lejeune-AS4141		

Run #	File ID	DF	Analyzed	By	Prep Date	Prep Batch	Analytical Batch
Run #1 ^a	QQ034541.D	1	03/31/08	TD	n/a	n/a	GQQ1327
Run #2							

Run #	Purge Volume
Run #1	5.0 ml
Run #2	

Purgeable Aromatics, Full List

CAS No.	Compound	Result	RL	MDL	Units	Q
71-43-2	Benzene	ND	1.0	0.50	ug/l	
108-90-7	Chlorobenzene	ND	1.0	0.50	ug/l	
95-50-1	1,2-Dichlorobenzene ^b	ND	8.0	8.0	ug/l	
541-73-1	1,3-Dichlorobenzene	ND	1.0	0.50	ug/l	
106-46-7	1,4-Dichlorobenzene	ND	1.0	1.0	ug/l	
100-41-4	Ethylbenzene	ND	1.0	0.50	ug/l	
1634-04-4	Methyl Tert Butyl Ether	ND	1.0	1.0	ug/l	
108-88-3	Toluene	ND	1.0	0.50	ug/l	
1330-20-7	Xylenes (total)	ND	3.0	1.0	ug/l	

CAS No.	Surrogate Recoveries	Run# 1	Run# 2	Limits
460-00-4	4-Bromofluorobenzene	102%		70-120%
98-08-8	aaa-Trifluorotoluene	93%		73-118%

- (a) Confirmed by GC/MS.
- (b) Elevated reporting limits due to matrix interference.

ND = Not detected MDL - Method Detection Limit J = Indicates an estimated value
 RL = Reporting Limit B = Indicates analyte found in associated method blank
 E = Indicates value exceeds calibration range N = Indicates presumptive evidence of a compound

Report of Analysis

Client Sample ID: USTAS4151-MW15	Date Sampled: 03/27/08
Lab Sample ID: F56535-1	Date Received: 03/29/08
Matrix: AQ - Ground Water	Percent Solids: n/a
Project: Camp Lejeune-AS4141	

Metals Analysis

Analyte	Result	RL	MDL	Units	DF	Prep	Analyzed By	Method	Prep Method
Lead	2,1 U	5.0	2.1	ug/l	1	03/31/08	03/31/08 RS	SW846 6010B ¹	SM 3030C ²

(1) Instrument QC Batch: MA6367

(2) Prep QC Batch: MP14103

RL = Reporting Limit
MDL = Method Detection Limit

U = Indicates a result < MDL
B = Indicates a result >= MDL but < RL



Misc. Forms

Custody Documents and Other Forms

Includes the following where applicable:

- Certification Exceptions
- Chain of Custody

25670

COC Number:
125709-AS4141-032808



CHAIN-OF-CUSTODY RECORD

Shaw E & I - Piney Green Rd. Lot 203 Bld 626 - 910-451-2390								Receiving LAB: ACCUTEST												
Project Name				Project Location				Analysis Desired												
CAMP LEJEUNE -AS4141				CAMP LEJEUNE, NC																
Project Number		Contact		P.O. Number		Reviewed by														
125006		Mark Martin																		
Client Rep				Project Manager																
US NAVY - LANTDIV				Joe Colella																
Item No.	Sample Number	Date	Time	Comp	Grab	Sample Description	Number of Containers	VOC 602/ w xylenes	PAH 625	Total Lead By 3030C										
1	USTAS4151-MW15	3/27/08	14:00		X	USTAS4151-MW15	6	X	X	X										
2	USTAS4151-MW16	3/27/08	14:40		X	USTAS4151-MW16	6	X	X	X										
3	USTAS4151-MW18	3/27/08	15:15		X	USTAS4151-MW18	6	X	X	X										
4	USTAS4151-MW14	3/28/08	7:00		X	USTAS4151-MW14	6	X	X	X										
5	USTAS4151-OBG06	3/28/08	8:00		X	USTAS4151-OBG06	6	X	X	X										
6	USTAS4151-MW17	3/28/08	8:45		X	USTAS4151-MW17	6	X	X	X										
7	USTAS4151-MW07	3/28/08	9:30		X	USTAS4151-MW07	6	X	X	X										
8	USTAS4151-MW10	3/28/08	10:50		X	USTAS4151-MW10	6	X	X	X										
9	USTAS4151-MW02	3/28/08	11:15		X	USTAS4151-MW02	6	X	X	X										
10	USTAS4151-MW02D	3/28/08	11:15		X	USTAS4151-MW02D	6	X	X	X										
11	USTAS4151-TRIPBLANK	10/28/07			X	USTAS4151-TRIPBLANK	2	X												

Transfer Number	Item Number	Transfers Relinquished By	Transfers Accepted By	Date	Time	Remarks
1	1 -- 11	<i>[Signature]</i>	FedEx	3/29/08	16:00	14 Day TAT FedEx 8639 1417 4002, 8639 1433 4107, 8639 1433 4092
2		EX	<i>[Signature]</i>	3-29-08	09:00	
3						

2.4 2.0 2.4

ACCUTEST LABORATORIES SAMPLE RECEIPT CONFIRMATION

ACCUTEST'S JOB NUMBER: F56535 CLIENT: Shaw PROJECT: Camp Lejeune - AS4/21
 DATE/TIME RECEIVED: 3-29-08 09:00 # OF COOLERS RECEIVED: 3 COOLER TEMPS: 2.4 2.0 2.6
 METHOD OF DELIVERY: FEDEX UPS ACCUTEST COURIER GREYHOUND DELIVERY OTHER
 AIRBILL NUMBERS: 4639 1433 4092

COOLER INFORMATION

- CUSTODY SEAL NOT PRESENT OR NOT INTACT
- CHAIN OF CUSTODY NOT RECEIVED (COC)
- ANALYSIS REQUESTED IS UNCLEAR OR MISSING
- SAMPLE DATES OR TIMES UNCLEAR OR MISSING
- TEMPERATURE CRITERIA NOT MET
- WET ICE RECEIVED IN COOLER

TRIP BLANK INFORMATION

- TRIP BLANK PROVIDED
- TRIP BLANK NOT PROVIDED
- TRIP BLANK NOT ON COC
- TRIP BLANK INTACT
- TRIP BLANK NOT INTACT
- RECEIVED WATER TRIP BLANK
- RECEIVED SOIL TRIP BLANK

MISC. INFORMATION

NUMBER OF ENCORES ? 0
 NUMBER OF 5035 FIELD KITS ? 0
 NUMBER OF LAB FILTERED METALS ? 0

SUMMARY OF COMMENTS: _____

SAMPLE INFORMATION

- SAMPLE LABELS NOT PRESENT ON ALL BOTTLES
 - CORRECT NUMBER OF CONTAINERS USED
 - SAMPLE RECEIVED IMPROPERLY PRESERVED
 - INSUFFICIENT VOLUME FOR ANALYSIS
 - TIMES ON COC DOES NOT MATCH LABEL(S)
 - ID'S ON COC DOES NOT MATCH LABEL(S)
 - VOC VIALS HAVE HEADSPACE (MACRO BUBBLES)
 - BOTTLES RECEIVED BUT ANALYSIS NOT REQUESTED
 - NO BOTTLES RECEIVED FOR ANALYSIS REQUESTED
 - UNCLEAR FILTERING INSTRUCTIONS
 - UNCLEAR COMPOSITING INSTRUCTIONS
 - SAMPLE CONTAINER(S) RECEIVED BROKEN
 - % SOLIDS JAR NOT RECEIVED
 - 5035 FIELD KIT NOT FROZEN WITHIN 48 HOUR'S
 - RESIDUAL CHLORINE PRESENT
- (APPLICABLE TO EPA 600 SERIES OR NORTH CAROLINA ORGANICS)

TECHNICIAN SIGNATURE/DATE E.T. 3-29-08 TECHNICIAN SIGNATURE/DATE F.M. 3-29-08 ASBD 12/17/07