

**FINAL
SOIL CLEANUP REPORT WITH SITE CLOSURE REQUEST
HELICOPTER RELEASE**

NCDENR Incident Number: 86932
Marine Corps Air Station New River
Jacksonville, North Carolina

August 28, 2006

Prepared for:



Mr. David T. Cleland, P.G.
Marine Corps North Carolina IPT
Naval Facilities Engineering Command Mid-Atlantic
6506 Hampton Blvd
Norfolk, VA 23508-1278



Mr. Andrew Smith
I&E/EMD/EQB
Building 12, Post Lane
MCB Camp Lejeune, NC 28542

Prepared by:



Sovereign Consulting Inc.
405 Oakmears Crescent, Suite 1
Virginia Beach, VA 23462

Contract Number: N62470-04-D-0205
Task Order: 0013

TABLE OF CONTENTS

EXECUTIVE SUMMARY	1
1.0 TITLE PAGE	2
2.0 INTRODUCTION	3
3.0 SITE HISTORY	3
4.0 SITE REMEDIATION	3
5.0 RECEPTOR SURVEY	4
6.0 CONCLUSIONS AND PETITION FOR SITE CLOSURE	5
7.0 REFERENCES	6

TABLES

TABLE 1	SUMMARY OF CONFIRMATION SOIL SAMPLING RESULTS – EPA METHODS 5030 AND 3550
---------	---

FIGURES

FIGURE 1	GENERAL VICINITY TOPOGRAPHIC MAP
FIGURE 2	SITE MAP WITH MONITORING WELL LOCATIONS
FIGURE 3	SITE MAP SHOWING AREA OF 2006 EXCAVATION
FIGURE 4	SITE MAP WITH CONFIRMATION SOIL SAMPLING RESULTS – EPA METHODS 5030 AND 3550

APPENDICES

APPENDIX A	HISTORICAL DATA
APPENDIX B	LABORATORY REPORTS AND CHAIN OF CUSTODY DOCUMENTATION FROM MAY/JUNE 2006 EVENT
APPENDIX C	PHOTOGRAPHS
APPENDIX D	SOIL DISPOSAL MANIFESTS

LIST OF ACRONYMS

2000 Guidelines	Groundwater Section Guidelines for Investigation and Remediation of Soil and Groundwater
2001 Guidelines	Guidelines for Assessment and Corrective Action, North Carolina Underground Storage Tank Section (Effective July 1, 2001)
2L GWQS	NCAC T15A:02L Groundwater Quality Standards
AS	Air Sparge
AST	Aboveground Storage Tank
BDL	Below Detection Limit
BN	Base/Neutral (extractables)
BNA	Base/Neutral/Acid (extractables)
BQL	Below Quantitation Limit
BLS	Below Land Surface
BTEX	Benzene, Toluene, Ethylbenzene, Xylenes
CAP	Corrective Action Plan
CFR	Code of Federal Regulations
Cr	Chromium
CSA	Comprehensive Site Assessment
DIPE	Di-isopropyl Ether
DO	Dissolved Oxygen
DOD	Department of Defense
DPT	Direct Push Technology
DWQ	Division of Water Quality
DWM	Division of Waste Management
DTW	Depth to Water
EDB	Ethylene di-bromide
EMD	Environmental Management Division
EPA	Environmental Protection Agency
EPH	Extractable Petroleum Hydrocarbons
EQB	Environmental Quality Branch
Fe	Iron
FID	Flame Ionization Detector
FT	Feet
GCL	Gross Contaminant Level
GIS	Geographic Information System
GPS	Global Positioning System
Guidelines Vol. II	Groundwater Section Guidelines for Investigation and Remediation of Soil and Groundwater, Volume II, Petroleum Underground Storage Tanks (January 2, 1998)
HDPE	High Density Polyethylene
I/C	Industrial/Commercial
ID	Identification
I&E	Installations and Environment Department
IGWQS	Interim Groundwater Quality Standards
IPE	Isopropyl Ether
LSA	Limited Site Assessment
LUST	Leaking Underground Storage Tank
m	Meter
MADEP	Massachusetts Department of Environmental Protection
MCAS	Marine Corps Air Station

MCB	Marine Corps Base
MDL	Method Detection Limit
mg/Kg	Milligrams per Kilogram
mg/L	Milligrams per Liter
MSCC	Maximum Soil Contaminant Concentration
MSL	Mean Sea Level
MTBE	Methyl tertiary butyl ether
µg/Kg	Micrograms per Kilogram
µg/L	Micrograms per Liter
NA	Not Analyzed
N/A	Not Applicable
NAVFAC	Naval Facilities Engineering Command Atlantic
NC	North Carolina
NCAC	North Carolina Administrative Code
NCDENR	North Carolina Department of Environment and Natural Resources
NE	None Established
NM	Not Measured
NMT	No Measurable Thickness
NS	Not Sampled
OVA	Organic Vapor Analyzer
PAH	Polynuclear Aromatic Hydrocarbons
Pb	Lead
PPB	Parts Per Billion
PPM	Parts Per Million
PID	Photo Ionization Detector
PQL	Practical Quantitation Limit
PVC	Polyvinyl chloride
RBCA	Risk-Based Corrective Action
RCRA	Resource Conservation and Recovery Act
Res	Residential
SOW	Scope of Work
STGW	Soil-to-Groundwater
SVE	Soil Vapor Extraction
SVOC	Semi Volatile Organic Compound
TCLP	Toxicity Characteristic Leaching Procedure
TIC	Tentatively Identified Compound
TOC	Top of Casing
TPH	Total Petroleum Hydrocarbons
US	United States
USCS	Unified Soil Classification System
USEPA	United States Environmental Protection Agency
USGS	United States Geological Survey
UST	Underground Storage Tank
VOC	Volatile Organic Compounds
VPH	Volatile Petroleum Hydrocarbons
WiRO	NCDENR Wilmington Regional Office

EXECUTIVE SUMMARY

The Helicopter Release area project site is located in the immediate vicinity of the flight line located aboard Marine Corps Air Station (MCAS) New River, Jacksonville, North Carolina. The area is grass land directly adjacent to the DELTA taxiway of the military airplane flight line.

On February 25, 2004, approximately 700 gallons of JP-5 fuel was accidentally released from a helicopter fuel tank onto the flight line and then flowed southward onto the adjacent grass area. This was the first petroleum release to occur at the subject site. Subsequent to the release, MCAS New River personnel conducted initial abatement measures, which included two separate excavations of the release area. Laboratory analysis of post excavation soil samples revealed persistent total petroleum hydrocarbon contamination at the site. In an e-mail to Marine Corps Base Camp Lejeune Environmental Management Division personnel, dated May 27, 2004, NCDENR recommended a Comprehensive Site Assessment (CSA) be completed prior to any additional remediation efforts.

As a result, Catlin Engineers and Scientists (CATLIN) of Wilmington, North Carolina conducted a CSA of the site. The report, dated June 2005, recommended additional excavation to remove the remaining impacted soils. Sovereign Consulting Inc. (Sovereign) performed the recommended soil excavation May 31 - June 1, 2006. Approximately 143 tons of soil was removed and properly disposed of from the site. Eight (8) confirmation soil samples were taken from the sidewalls and base of the excavation. Subsequent laboratory analysis indicated that there was no gasoline range organics (GRO) or diesel range organics (DRO) present above the established North Carolina Department of Environment and Natural Resources (NCDENR) action levels of 10 mg/kg and 40 mg/kg.

Based on the results of the Sovereign 2006 remedial action, soil contamination has been removed from the site. No further soil remediation is necessary, and as a result, this site is a candidate for No Further Action status.

1.0 TITLE PAGE

DATE OF REPORT: August 28, 2006

Facility I.D.: N/A

NCDNER Incident Number: 86932

Site Name: 2004 Helicopter Release

Site Location: Marine Corps Air Station New River, North Carolina

Nearest City/Town: Jacksonville

County: Onslow

Property Owner: Commanding Officer – MCB Camp Lejeune

Address:

I&E/EMD/EQB

PSC Box 20004

MCB Camp Lejeune, NC 28542-0004

Phone: (910) 451-5068

Property Occupant: Marine Corps Personnel

Address:

MCAS New River, NC

Phone: None

Consultant/Contractor: Sovereign Consulting Inc.

Address:

405 Oakmeads Crescent, Suite 1

Virginia Beach, VA 23462

Phone: (757) 456-5093

Release Information

Date Discovered: February 25, 2004

Latitude:

N 77° 26' 30.4"

Longitude:

W 34° 42' 31.6"

Estimated Quantity of Release: Approximately 700 gallons of JP-5 fuel

Cause of Release: Accidental Release from a helicopter fuel tank during lift off

Source of Release: Helicopter fuel tank

Sizes and contents of system(s) from which the release occurred: 1000 gallon capacity helicopter fuel tank.

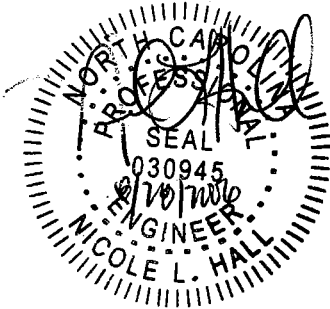

I, Nicole L. Hall a Professional Engineer for Sovereign Consulting Inc., do certify that the information contained in this report is correct and accurate to the best of my knowledge.

2.0 INTRODUCTION

This report summarizes field activities conducted during a recent soil removal action at the 2004 Helicopter Release location. This site is a grassy area adjacent to Taxiway Delta on the flight line aboard Marine Corps Air Station New River, Jacksonville, North Carolina. An evaluation for site closure was also performed for the site.

The project's scope of work entailed preliminary soil sampling at the site. Subsequent removal of contaminated soil was performed at the Helicopter Release area along with the procurement of confirmation soil sampling. Samples were sent to the laboratory for analysis, and results of the sampling activities are presented in this report.

3.0 SITE HISTORY

The subject site is located along a military airplane flight line, which facilitates the training and support of Marine Corps aircraft. Other than aircraft on the flight line, there are no other potential petroleum sources (aboveground storage tanks, underground storage tanks, pipelines, etc.) within 500 feet of the subject site. On February 25, 2004, approximately 700 gallons of JP-5 fuel was accidentally released from a helicopter fuel tank onto the flight line. The released fuel subsequently flowed southward onto the adjacent grass area.

Following the release, MCAS personnel conducted initial abatement measures, which included excavation of apparently impacted soils at the release area. Laboratory analysis of post excavation soil samples revealed areas of remnant soil contamination remained at the site. In an e-mail dated May 27, 2004, NCDENR personnel recommended to MCB Camp Lejeune EMD personnel that a CSA be completed prior to any additional remedial actions taking place.

As a result, CATLIN of Wilmington, North Carolina was authorized to perform a CSA at the site. Catlin conducted a CSA, dated June 2005, and recommended additional excavation of contaminated soils to below TPH-DRO and TPH-GRO action levels. Specifically, CATLIN recommended to excavate and properly dispose of remnant JP-5 impacted soils in the vicinity of historical soil sample locations HA-06, HA-16 and HA-17 from the land surface to the apparent water table. The area proposed for excavation was approximately 20 feet long by 20 feet wide by 3 feet deep, or approximately 45 cubic yards of impacted soils.

Sovereign was tasked to implement the removal action and conducted soil excavation activities in May and June 2006. This report summarizes the details associated with the Sovereign excavation and sampling activities.

4.0 SITE REMEDIATION

Following the February 2004 petroleum release, initial abatement activities and removal of obviously impacted soils on two separate occasions were performed at the site by MCAS New River personnel. Post-excavation soil samples, however, revealed areas of soil contamination at the site. As a result, the NAVFAC Midlant North Carolina Marine Corp Integrated Project Team prompted Sovereign to conduct a remedial action of subject site soils to below NCDENR action levels by means of excavation.

Based on the Scope of Work for this project, further soil excavation took place on May 31 and June 1, 2006. Prior to any field activities, Sovereign reviewed site diagrams and recommended plans for the soil removal. Sovereign also initiated a thorough utility mark out with a private utility locator familiar with sites and standard operations at MCB Camp Lejeune and MCAS New River.

Sovereign excavated and disposed of approximately 143 tons of petroleum impacted soils from the project site. Figure 3 shows the approximate excavation area, which was approximately five (5) feet deep. The soils were excavated until the extent of contamination had been reached based on PID readings. Soil sampling was performed after excavation to confirm removal of impacted soil to a concentration below the applicable action levels.

A total of nine (9) soil samples were obtained, one of which (sample DELTAT-001) was a composite sample whose results were used for transport and disposal purposes. Once removal activities were completed, eight (8) confirmation soil samples (DELTAT-002 through DELTAT-009) were obtained from the excavation. Six (6) were collected from the sidewalls and two (2) from the excavation floor. All samples were taken at an approximate depth of five (5) feet. The soil samples were packed in pre-labeled jars, stored on ice, and shipped to SGS/Paradigm Analytical Laboratories Inc. (SGS) in Wilmington, North Carolina (NC Lab Certification #481). The laboratory analyzed the samples for total petroleum hydrocarbons per EPA Methods 5030 (TPH-GRO) and 3550 (TPH-DRO).

Laboratory results confirmed the presence of petroleum constituents in two samples. Soil samples DELTAT-005 and DELTAT-009 contained TPH-GRO concentrations of 8.17 mg/kg and 9.64 mg/kg, respectively. These samples were taken from opposite sidewalls at the south end of the excavation. The detected concentrations, however, were below the action level for TPH-GRO of 10 mg/kg. No other contaminants were detected in the samples above the laboratory quantitation limits. Excavation activities were successful at removing the petroleum source in the Helicopter Release project area.

All laboratory results are summarized in Table 1, and the analytical data can be found in Appendix B. The locations of the confirmation soil samples are shown on Figure 4.

5.0 RECEPTOR SURVEY

Sovereign reassessed site conditions and concluded there have been no changes to the receptors identified in the June 2005 CSA report previously completed by CATLIN. In addition, there have been no changes to land use of the site or the surrounding areas. A copy of the receptor summary is included in Appendix A.

6.0 CONCLUSIONS AND PETITION FOR SITE CLOSURE

Based on fieldwork and laboratory analytical data gathered during the Sovereign excavation and soil sampling event, the following conclusions are presented:

1. Initial abatement and excavation activities were performed at the Helicopter Release site by MCAS New River personnel. Initial confirmation soil samples indicated the presence of soil contamination.
2. The CATLIN CSA, dated June 2005, recommended MCB Camp Lejeune conduct additional soil excavation at the location to remove the remaining petroleum impacted soils.
3. Sovereign conducted additional soil excavation activities at the Helicopter Release area on May 31-June 1, 2006. Approximately 143 tons of contaminated soil were removed and properly disposed. Confirmation soil sampling results show that none of the samples exhibit TPH concentrations above the NCDENR action levels.

Based on the results of this remedial action, soil contamination has been removed from the site. All confirmation soil sample results are below the NCDENR TPH action levels. No further soil remediation is necessary, and as a result, this site is a candidate for No Further Action status.

7.0 REFERENCES

AH Environmental Consultants, *Final Report, Wellhead Protection Plan – 2002 Update, Marine Corps Base, Camp Lejeune*, August 2002.

CATLIN Engineers and Scientists, *Final Comprehensive Site Assessment – 2004 Helicopter Release, Marine Corps Air Station New River, North Carolina*, June 27, 2005.

North Carolina Department of Environment and Natural Resources, Division of Water Quality, Groundwater Section, *Groundwater Section Guidelines for the Investigation and Remediation Of Soil and Groundwater*, July 2000.

TABLES

TABLE 1
SUMMARY OF CONFIRMATION SOIL SAMPLING RESULTS

Incident Number and Name: Helicopter Release Area, 86932
 Facility ID#: N/A

Analytical Method: EPA Method 5030 and 3550

Comment	Sample ID	Contaminant of Concern →		TPH-GRO	TPH-DRO
		Date Collected (mm/dd/yy)	Sample Depth (ft BGS)		
Initial Composite Soil Sample for T&D	DELTAT-001	5-25-2006	0-3	BQL	BQL
Sidewall sample	DELTAT-002	6-1-2006	5	BQL	BQL
Within excavation	DELTAT-003	6-1-2006	5	BQL	BQL
Sidewall sample	DELTAT-004	6-1-2006	4.67	BQL	BQL
Sidewall sample	DELTAT-005	6-1-2006	5	8.17	BQL
Sidewall sample	DELTAT-006	6-1-2006	5	BQL	BQL
Sidewall sample	DELTAT-007	6-1-2006	5	BQL	BQL
Within excavation	DELTAT-008	6-1-2006	5	BQL	BQL
Sidewall sample	DELTAT-009	6-1-2006	5	9.64	BQL
NCDENR Action Level (mg/kg)				10	40

- ft. BGS = feet below ground surface
- Results reported in mg/kg
- mg/kg = milligrams per kilogram
- BQL = Below quantitation limits; see lab reports for specific limits.
- **BOLDED** = detected concentration
- **BOLDED** and **SHADED** = detected concentration exceeds NCDENR action level.

FIGURES

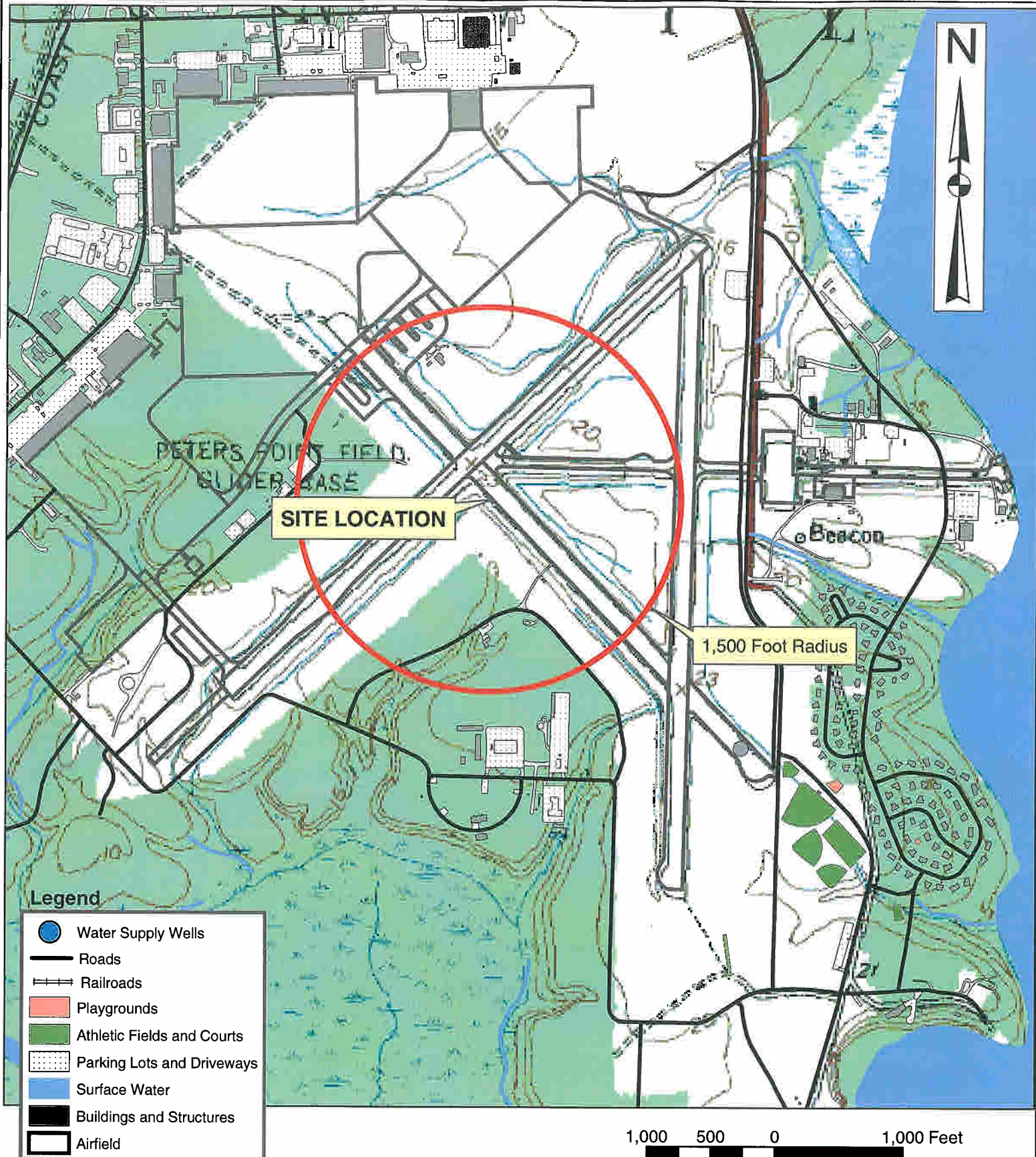

Data Sources: Data Layers provided by MCB Camp Lejeune GIS Office.

 WILMINGTON, NORTH CAROLINA	PROJECT HELICOPTER RELEASE SITE DRAFT SOIL CLEANUP WITH SITE CLOSURE REQUEST MARINE CORPS AIR STATION NEW RIVER, NC	TITLE GENERAL LOCATION USGS TOPOGRAPHIC QUADRANGLE	FIGURE 1
	JOB NO. 206-063 DATE AUG 2006	SCALE AS SHOWN DRAWN BY KAWS CHECKED BY CWR	

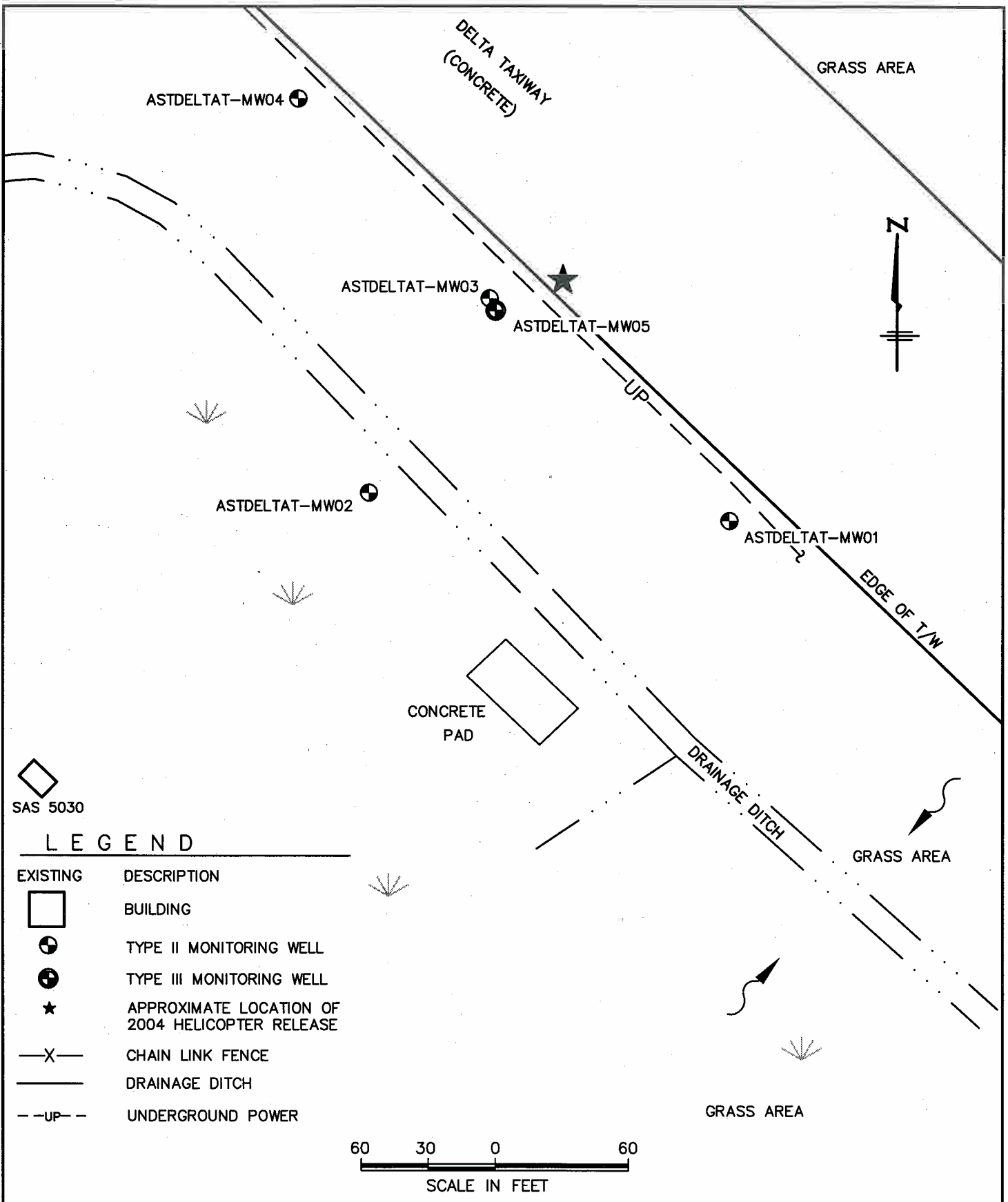

SAS 5030

LEGEND

EXISTING	DESCRIPTION
	BUILDING
	TYPE II MONITORING WELL
	TYPE III MONITORING WELL
	APPROXIMATE LOCATION OF 2004 HELICOPTER RELEASE
	CHAIN LINK FENCE
	DRAINAGE DITCH
	UNDERGROUND POWER

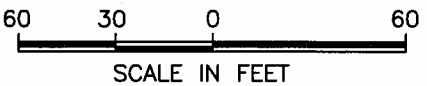

 WILMINGTON, NORTH CAROLINA	PROJECT HELICOPTER RELEASE SITE SOIL CLEANUP REPORT WITH SITE CLOSURE REQUEST MARINE CORPS AIR STATION NEW RIVER, N.C.	TITLE SITE MAP WITH MONITORING WELL LOCATIONS	FIGURE 2
	JOB NO: 206-063 DATE: AUG 2006	SCALE: 1"=60'	DRAWN BY: KAWS CHECKED BY: CWR

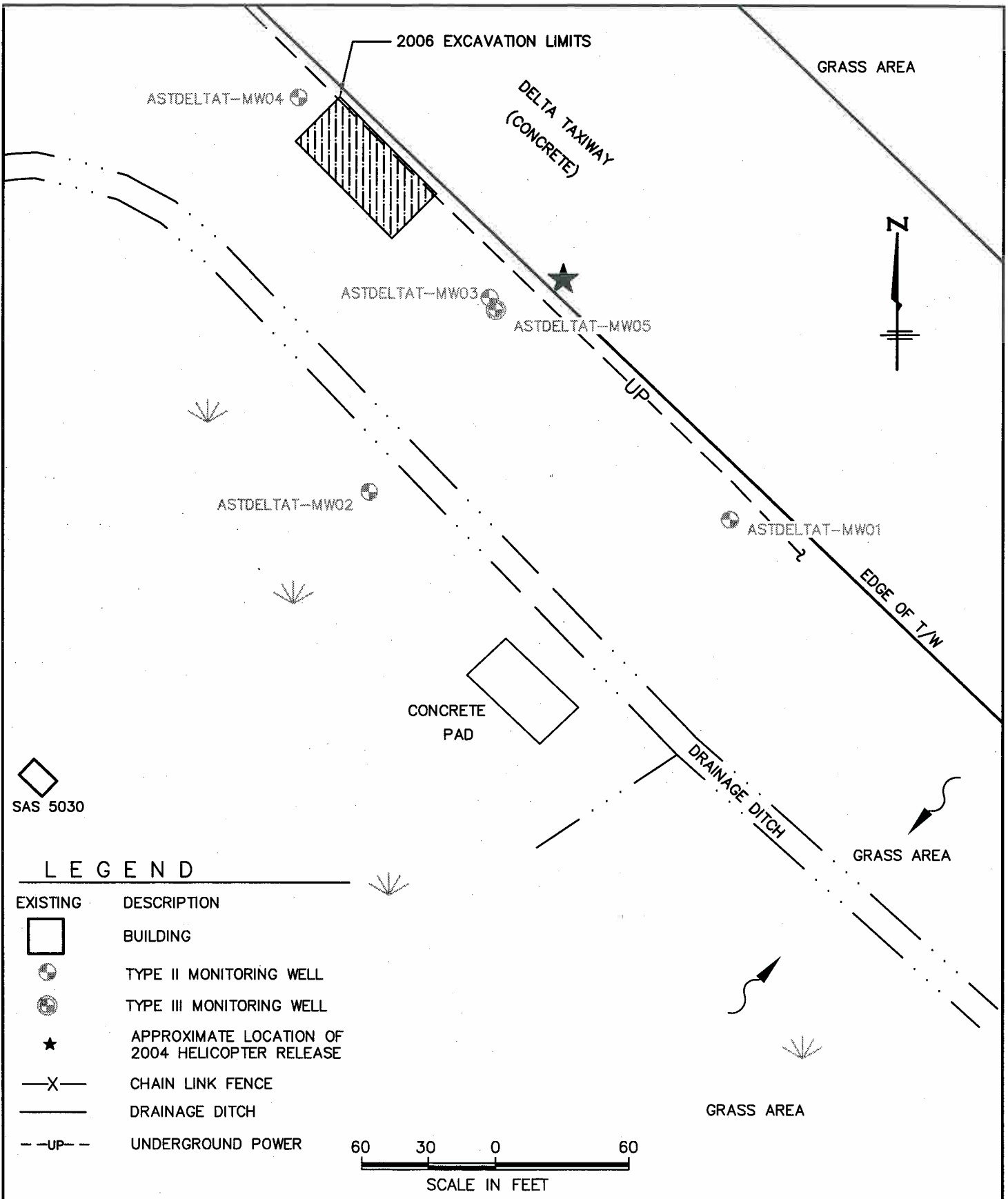

SAS 5030

LEGEND

EXISTING	DESCRIPTION
	BUILDING
	TYPE II MONITORING WELL
	TYPE III MONITORING WELL
	APPROXIMATE LOCATION OF 2004 HELICOPTER RELEASE
	CHAIN LINK FENCE
	DRAINAGE DITCH
	UNDERGROUND POWER

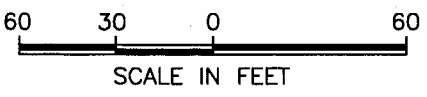

 WILMINGTON, NORTH CAROLINA	PROJECT: HELICOPTER RELEASE SITE SOIL CLEANUP REPORT WITH SITE CLOSURE REQUEST MARINE CORPS AIR STATION NEW RIVER, N.C.	TITLE: SITE MAP SHOWING AREA OF 2006 EXCAVATION	FIGURE: 3
	JOB NO: 206-063 DATE: AUG 2006	SCALE: 1"=60'	DRAWN BY: KAWS CHECKED BY: CWR

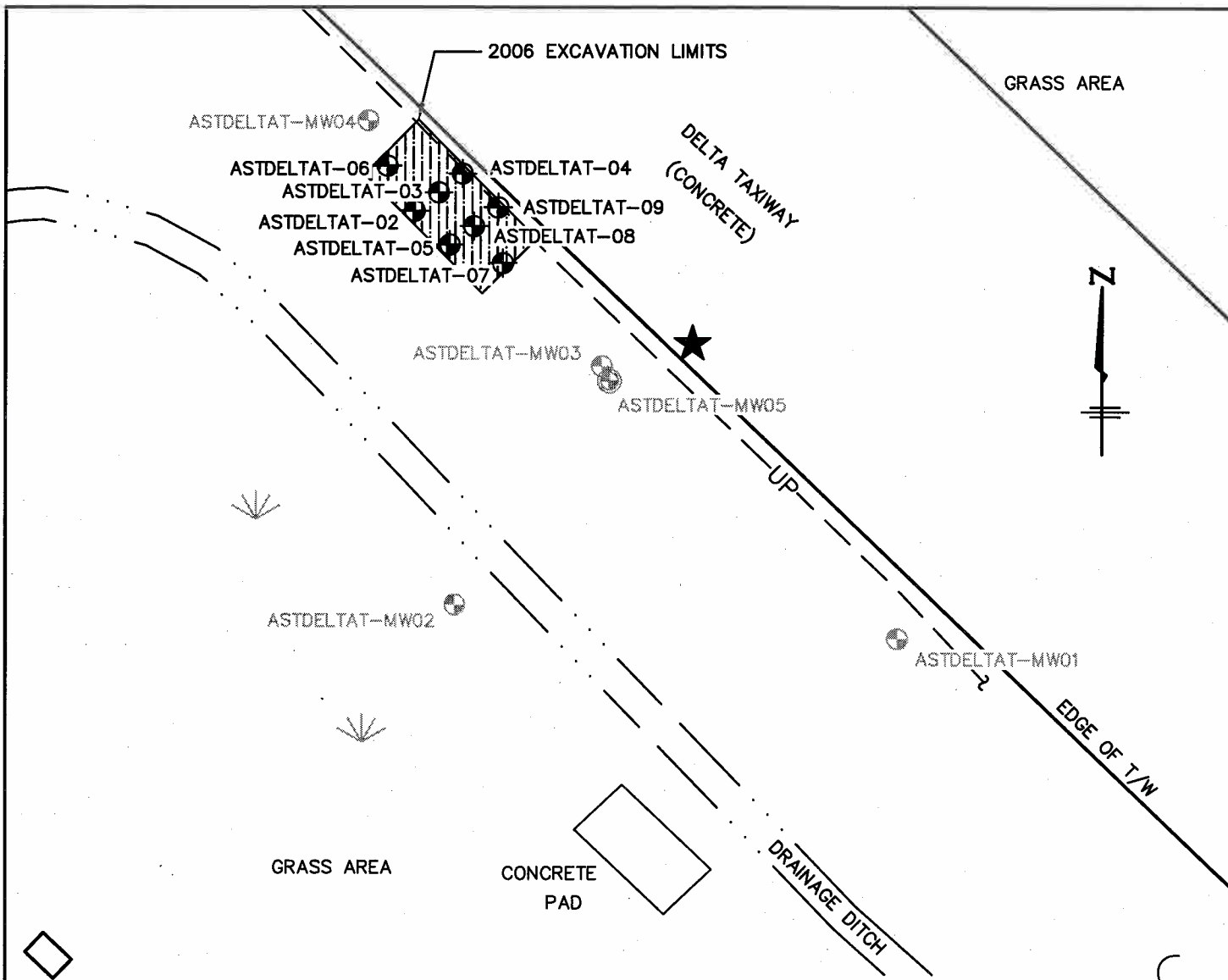

SAS 5030

LEGEND

- | EXISTING | DESCRIPTION |
|----------|---|
| | BUILDING |
| | TYPE II MONITORING WELL |
| | TYPE III MONITORING WELL |
| | SOIL SAMPLES |
| | APPROXIMATE LOCATION OF 2004 HELICOPTER RELEASE |
| | CHAIN LINK FENCE |
| | DRAINAGE DITCH |
| | UNDERGROUND POWER |

Comment	Sample ID	Contaminant of Concern →		TPHGRO	TPHDRO
		Date Collected (mm/dd/yy)	Sample Depth (ftBGS)		
Initial Composite Soil Sample for T&D	DELTAT-001	5-25-2006	0-3	BQL	BQL
Sidewall sample	DELTAT-002	6-1-2006	5	BQL	BQL
Bottom of excavation	DELTAT-003	6-1-2006	5	BQL	BQL
Sidewall sample	DELTAT-004	6-1-2006	4.67	BQL	BQL
Sidewall sample	DELTAT-005	6-1-2006	5	8.17	BQL
Sidewall sample	DELTAT-006	6-1-2006	5	BQL	BQL
Sidewall sample	DELTAT-007	6-1-2006	5	BQL	BQL
Bottom of excavation	DELTAT-008	6-1-2006	5	BQL	BQL
Sidewall sample	DELTAT-009	6-1-2006	5	9.64	BQL
NCDENR Action Level (ug/kg)				10	40

- ft. BGS = feet below ground surface
- Results reported in ug/kg
- mg/kg = milligrams per kilogram
- BQL = Below quantitation limits; see lab reports for specific limits.
- **BOLDED** = detectable concentration
- **BOLDED and SHADED** = detected concentration exceeds residential MSCL

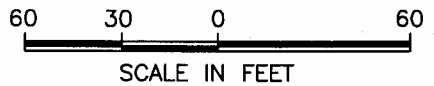

 WILMINGTON, NORTH CAROLINA	PROJECT: HELICOPTER RELEASE SITE SOIL CLEANUP REPORT WITH SITE CLOSURE REQUEST MARINE CORPS AIR STATION NEW RIVER, N.C.	TITLE: SITE MAP WITH SOIL SAMPLING RESULTS - EPA METHODS 5030 AND 3550	FIGURE: 4
	JOB NO: 206-063 DATE: AUG 2006	SCALE: 1"=60'	DRAWN BY: KAWS CHECKED BY: CWR

APPENDIX A

**HISTORICAL DATA
CATLIN CSA RECEPTOR SURVEY**

COMPREHENSIVE SITE ASSESSMENT

2004 HELICOPTER RELEASE ABOVEGROUND STORAGE TANK JP-5 FUEL RELEASE

MARINE CORPS AIR STATION
NEW RIVER, NORTH CAROLINA

June 27, 2005

SITE INFORMATION		RELEASE INFORMATION	
NCDENR Groundwater Incident No.	PENDING	Facility Identification No.	N/A
Product Released	JP-5	Date Discovered	Confirmed April of 2000
Estimated Quantity	± 700 gallons	Source of Release	Helicopter Fuel Storage Tank

CONTRACT NO. N62470-01-D-3009
DELIVERY ORDER NO. 0136
CATLIN PROJECT NO. 204-047



Prepared by:

CATLIN ENGINEERS AND SCIENTISTS
220 OLD DAIRY ROAD
WILMINGTON, NC 28405
(910) 452-5861

Prepared for:

COMMANDING GENERAL
MCB, CAMP LEJEUNE
ATTN: I&E/EMD/EQB
MCB, PSC BOX 20004
CAMP LEJEUNE, NC 28542
(910) 451-5068

concentrations in excess of applicable NCDENR Action Levels in two soil samples, HA-04 (DRO) and HA-06 (DRO and GRO).

Based on the initial soil sample results, additional excavation activities were initiated in the area around soil sample locations HA-04 and HA-06. Following the excavation, CATLIN personnel again obtained confirmatory soil samples for laboratory analysis on April 19, 2004. Three soil samples, HA-13, HA-14, and HA-15, were collected by hand auger from the base of the additional excavation at HA-04 and two confirmatory soil samples, HA-16 and HA-17 were collected from the additional excavation at HA-06. These samples were also analyzed for TPH-GRO and TPH-DRO. Laboratory analysis of post excavation soil samples from the HA-04 area revealed TPH-GRO and TPH-DRO concentrations compliant with applicable NCDENR Action Levels. However, analyses of soil samples HA-15 and HA-16 exhibited TPH-GRO and TPH-DRO concentrations in excess of applicable NCDENR Action Levels. As stated previously, site conditions warranted additional site soil and initial site groundwater assessment.

Site Geographical Setting and Surrounding Land Use

The subject site is located within the coastal plain of North Carolina just off the New River. The area is former woodland that has been cut and graded for the construction of the MCAS flight line and surrounding support structures. The surrounding land surface is relatively flat with a topography elevation ranging from approximately 23 to 25 foot above MSL. Aside from the adjacent paved flight line the local area is covered with grass.

As stated previously, the subject site is adjacent to the Delta Taxiway flight line aboard MCAS New River. MCAS New River consists of approximately 2,600 acres of land utilized for various military and civil service purposes. This site is currently utilized to train and support Marine Corps aircraft and will likely remain so for the foreseeable future.

3.0 SITE RECEPTOR INFORMATION

As defined by NCDENR in NCAC 15A 02L .0102(19) "receptors" include any human, plant, animal or structure with the potential to be adversely affected by the release or migration of contaminants. Guidance documents issued by the regulatory agency indicate that structures may include items such as utility lines, basements, and elevator shafts. Although not specifically included in Section .0102 of 2L GWQS, regulatory officials typically consider potential receptors to include environmental resources such as water supply wells, surface waters, drinking water supplies, and "regions of groundwater that have been identified for planned resource development." Receptors noted during the March 15, 2005 area reconnaissance can be summarized as follows:

Adjoining Property Owners within 1,500 feet of the Source Area

Not applicable. The area within a 1,500 feet radius of the source area is still well within the MCAS property boundary.

Potable or Non-potable Water Wells within 1,500 feet of Source Area

- No potable or non-potable water wells are located within 1,500 feet of the subject site,
- The MCAS, New River water system supplies public water to the site. The water well nearest to the subject site is MCAS potable water well PSWAS-4150 located approximately 4,200 feet west of the source area.

Wellhead Protection Areas

- Camp Lejeune has identified proposed wellhead protection areas on the MCAS. According to available information (Wellhead Protection Plan – 2002 Update, August 2002), the subject site is not located within a proposed wellhead protection area.

Surface Water Bodies within 1,500 feet of Source Area

- +80 feet south – Manmade drainage ditch,
- No surface water is located within 1,500 feet of the subject site,
- The nearest natural surface water is New River located approximately 4,300 feet northeast of the potential source area,
- A man-made storm water retention pond is located approximately 1,000 feet south of the potential source area.

Buildings within 1,500 feet of Source Area

- +500 feet southeast – AS3000 – slab on grade construction,
- +560 feet southeast – AS3003 – slab on grade construction,
- +900 feet south – AS3525 - slab on grade construction.

Underground Utilities within 1,500 feet of the Source Area

- +0 feet - Electrical conduit for the Delta Taxiway runway lights are located approximately 2 feet below grade and run parallel to the runway through the soil excavation limits,
- Remaining underground communications and telephone lines are located greater than 400 feet from the source area and are generally installed at a depth of less than three feet BLS; however, their exact locations are not known. Secure communication lines are also located on site, but their exact locations and installation depths are not available for public record.

Public Access within 1,500 feet of the Source Area

- The area within 1,500 feet of the source is still within the MCAS. Access to this area is restricted.
- No areas of general public assembly (schools, churches, shops, playgrounds, etc.) currently exist within 1,500 feet of the source area.

APPENDIX B

**LABORATORY REPORTS AND CHAIN OF CUSTODY DOCUMENTATION FROM
2006 SAMPLING EVENTS**



Mr. Chris Murray
Sovereign Consulting
606 Thimble Shoals Rd.
Suite A1
Newport-News VA 23606
Report Number: G650-58

Client Project: NV013

Dear Mr. Murray:

Enclosed are the results of the analytical services performed under the referenced project. The samples are certified to meet the requirements of the National Environmental Laboratory Accreditation Conference Standards. Copies of this report and supporting data will be retained in our files for a period of five years in the event they are required for future reference. Any samples submitted to our laboratory will be retained for a maximum of thirty (30) days from the date of this report unless other arrangements are requested.

If there are any questions about the report or the services performed during this project, please call SGS/Paradigm at (910) 350-1903. We will be happy to answer any questions or concerns which you may have.

Thank you for using SGS/Paradigm Analytical Labs for your analytical services. We look forward to working with you again on any additional analytical needs which you may have.

Sincerely,
SGS/Paradigm Analytical Laboratories, Inc.

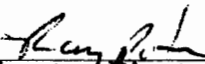

Laboratory Director
J. Patrick Weaver

6/1/2006

Date



Results for Metals

Client Sample ID: DELTAT-001
 Client Project ID: NV013
 Lab Sample ID: G650-58-1
 Lab Project ID: G650-58
 Batch ID: 5285 5288
 Report Basis: Dry

Analyzed By: PSW
 Date Collected: 5/25/2006
 Date Received: 5/26/2006
 Matrix: SOIL
 Solids 80.90

Metals	Result	RL	DF	Units	Method	Date Analyzed
Arsenic	1.15	1.05	1	MG/KG	6010B	5/31/2006
Barium	14.7	10.5	1	MG/KG	6010B	5/31/2006
Cadmium	BQL	1.05	1	MG/KG	6010B	5/31/2006
Chromium	16.5	1.05	1	MG/KG	6010B	5/31/2006
Lead	10.6	1.05	1	MG/KG	6010B	5/31/2006
Mercury	BQL	0.0229	1	MG/KG	7471	5/31/2006
Selenium	2.98	2.10	1	MG/KG	6010B	5/31/2006
Silver	BQL	1.05	1	MG/KG	6010B	5/31/2006

Comments

BQL = Below Quantitation Limits
 DF = Dilution Factor
 J = Between MDL and RL
 B= Amount in Prep Blank > MDL

Reviewed By: 
 MET_LIMS_4.1



Results for Total Petroleum Hydrocarbons
by GC/FID 8015

Client Sample ID: DELTAT-001
 Client Project ID: NV013
 Lab Sample ID: G650-58-1
 Lab Project ID: G650-58
 Report Basis: Dry Weight

Analyzed By: MJC
 Date Collected: 5/25/2006 10:45
 Date Received: 5/26/2006
 Matrix: Soil
 Solids 80.90

Analyte	Result MG/KG	RL MG/KG	Prep Method	Dilution Factor	Date Analyzed
Gasoline Range Organics	BQL	5.48	5035	1	05/30/06
Diesel Range Organics	BQL	7.32	3541	1	06/01/06



List of Reporting Abbreviations
and Data Qualifiers

B = Compound also detected in batch blank

BQL = Below Quantitation Limit (RL or MDL)

DF = Dilution Factor

Dup = Duplicate

D = Detected, but RPD is > 40% between results in dual column method.

E = Estimated concentration, exceeds calibration range.

J = Estimated concentration, below calibration range and above MDL

LCS(D) = Laboratory Control Spike (Duplicate)

MDL = Method Detection Limit

MS(D) = Matrix Spike (Duplicate)

PQL = Practical Quantitation Limit

RL = Reporting Limit

RPD = Relative Percent Difference

mg/kg = milligram per kilogram, ppm, parts per million

ug/kg = micrograms per kilogram, ppb, parts per billion

mg/L = milligram per liter, ppm, parts per million

ug/L = micrograms per liter, ppb, parts per billion

% Rec = Percent Recovery

% solids = Percent Solids

Special Notes:

- 1) Metals and mercury samples are digested with a hot block, see the standard operating procedure document for details.
- 2) Uncertainty for all reported data is less than or equal to 30 percent.

MI34.030606.3



CHAIN OF CUSTODY RECORD
SGS Environmental Services Inc.

Locations Nationwide
• Alaska • Hawaii
• Louisiana • Maryland
• New Jersey • North Carolina
• West Virginia
www.us.sgs.com 052685

1 CLIENT: Sovereign Consulting Inc. PHONE NO: (757) 777-8982
CONTACT: Chris Murray SITE/PSID#: AS-HR
PROJECT: NVO13 REPORTS TO: CHRIS MURRAY (Signature)
INVOICE TO: CHRIS MURRAY QUOTE #
405 Oakmeads Crest - P.O. NUMBER
VA Beach, VA 23462 FAX NO: ()

2 LAB NO. SAMPLE IDENTIFICATION DATE TIME MATRIX
DELTA-001 05/24/06 1045 S
NO CONTAINERS
SAMPLE TYPE: Ca COMP, Pb GRAB
Prescribed Lead Analysis Required: Non-Metal, Non-M
RCRA (metals)
GRO
DRO
REMARKS

3 Collected/Relinquished By: (1) Scarlett Fielding Date: 05/25/06 Time: 1300 Received By: Randall M. Kee
4 Relinquished By: (2) [Signature] Date: 5/24/06 Time: 11:30 Received By: [Signature]
Relinquished By: (3) [Signature] Date: [] Time: [] Received By: []
Relinquished By: (4) [Signature] Date: [] Time: [] Received By: []

Shipping Carrier: Samples Received Cold? (Circle) YES NO
Shipping Ticket No.: Temperature (C): 15.0
Special Deliverable Requirements: Chain of Custody Seal: (Circle) INTACT BROKEN ABSENT
Requested Turnaround Time and Special Instructions: 40-HOUR TA
Email results to: cmurray@soucon.com
"EDD" format

200 W. Pender Drive Anchorage, AK 99518 Tel: (907) 562-2243 Fax: (907) 561-5301
6900 Business Drive Wilmington, NC 28405 Tel: (910) 350-1803 Fax: (910) 350-1557
1256 Greenbrier Street Charleston, WV 25311 Tel: (304) 346-0725 Fax: (304) 346-0781
White - Returned by Lab
Yellow - Returned with Report
Pink - Retained by Samples



Mr. Chris Murray
Sovereign Consulting
606 Thimble Shoals Rd.
Suite A1
Newport-News VA 23606
Report Number: G650-59
Client Project: NV013

Dear Mr. Murray:

Enclosed are the results of the analytical services performed under the referenced project. The samples are certified to meet the requirements of the National Environmental Laboratory Accreditation Conference Standards. Copies of this report and supporting data will be retained in our files for a period of five years in the event they are required for future reference. Any samples submitted to our laboratory will be retained for a maximum of thirty (30) days from the date of this report unless other arrangements are requested.

If there are any questions about the report or the services performed during this project, please call SGS/Paradigm at (910) 350-1903. We will be happy to answer any questions or concerns which you may have.

Thank you for using SGS/Paradigm Analytical Labs for your analytical services. We look forward to working with you again on any additional analytical needs which you may have.

Sincerely,
SGS/Paradigm Analytical Laboratories, Inc.

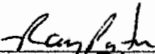

Laboratory Director
J. Patrick Weaver

6/16/2006

Date



Results for Total Petroleum Hydrocarbons
by GC/FID 8015

Client Sample ID: Delta T-002
 Client Project ID: NV013
 Lab Sample ID: G650-59-1
 Lab Project ID: G650-59
 Report Basis: Dry Weight

Analyzed By: MJC
 Date Collected: 6/1/2006 9:45
 Date Received: 6/2/2006
 Matrix: Soil
 Solids 79.21

Analyte	Result MG/KG	RL MG/KG	Prep Method	Dilution Factor	Date Analyzed
Gasoline Range Organics	BQL	7.15	5035	1	06/06/06
Diesel Range Organics	BQL	7.77	3541	1	06/12/06

Comments:

Flags:



Results for Total Petroleum Hydrocarbons
by GC/FID 8015

Client Sample ID: Delta T-003
 Client Project ID: NV013
 Lab Sample ID: G650-59-2
 Lab Project ID: G650-59
 Report Basis: Dry Weight

Analyzed By: MJC
 Date Collected: 6/1/2006 9:52
 Date Received: 6/2/2006
 Matrix: Soil
 Solids 71.69

Analyte	Result MG/KG	RL MG/KG	Prep Method	Dilution Factor	Date Analyzed
Gasoline Range Organics	BQL	7.97	5035	1	06/06/06
Diesel Range Organics	BQL	7.58	3541	1	06/12/06

Comments:

Flags:



Results for Total Petroleum Hydrocarbons
by GC/FID 8015

Client Sample ID: Delta T-004
 Client Project ID: NV013
 Lab Sample ID: G650-59-3
 Lab Project ID: G650-59
 Report Basis: Dry Weight

Analyzed By: MJC
 Date Collected: 6/1/2006 9:55
 Date Received: 6/2/2006
 Matrix: Soil
 Solids 81.98

Analyte	Result MG/KG	RL MG/KG	Prep Method	Dilution Factor	Date Analyzed
Gasoline Range Organics	BQL	6.49	5035	1	06/06/06
Diesel Range Organics	BQL	7.42	3541	1	06/12/06

Comments:

Flags:



Results for Total Petroleum Hydrocarbons
by GC/FID 8015

Client Sample ID: Delta T-005
 Client Project ID: NV013
 Lab Sample ID: G650-59-4
 Lab Project ID: G650-59
 Report Basis: Dry Weight

Analyzed By: MJC
 Date Collected: 6/1/2006 13:50
 Date Received: 6/2/2006
 Matrix: Soil
 Solids 70.89

Analyte	Result MG/KG	RL MG/KG	Prep Method	Dilution Factor	Date Analyzed
Gasoline Range Organics	8.17	7.78	5035	1	06/06/06
Diesel Range Organics	BQL	8.50	3541	1	06/12/06

Comments:

Flags:

Reviewed By: *ind*
 TPH_LIMS_v2.0



Results for Total Petroleum Hydrocarbons
by GC/FID 8015

Client Sample ID: Delta T-006
 Client Project ID: NV013
 Lab Sample ID: G650-59-5
 Lab Project ID: G650-59
 Report Basis: Dry Weight

Analyzed By: MJC
 Date Collected: 6/1/2006 13:57
 Date Received: 6/2/2006
 Matrix: Soil
 Solids 70.47

Analyte	Result MG/KG	RL MG/KG	Prep Method	Dilution Factor	Date Analyzed
Gasoline Range Organics	BQL	7.73	5035	1	06/06/06
Diesel Range Organics	BQL	8.65	3541	1	06/12/06

Comments:

Flags:

**Results for Total Petroleum Hydrocarbons**
by GC/FID 8015

Client Sample ID: Delta T-007
Client Project ID: NV013
Lab Sample ID: G650-59-6
Lab Project ID: G650-59
Report Basis: Dry Weight

Analyzed By: MJC
Date Collected: 6/1/2006 14:05
Date Received: 6/2/2006
Matrix: Soil
Solids 70.25

Analyte	Result MG/KG	RL MG/KG	Prep Method	Dilution Factor	Date Analyzed
Gasoline Range Organics	BQL	7.97	5035	1	06/06/06
Diesel Range Organics	BQL	8.21	3541	1	06/12/06

Comments:

Flags:

**Results for Total Petroleum Hydrocarbons**
by GC/FID 8015

Client Sample ID: Delta T-008
Client Project ID: NV013
Lab Sample ID: G650-59-7
Lab Project ID: G650-59
Report Basis: Dry Weight

Analyzed By: MJC
Date Collected: 6/1/2006 14:30
Date Received: 6/2/2006
Matrix: Soil
Solids 68.84

Analyte	Result MG/KG	RL MG/KG	Prep Method	Dilution Factor	Date Analyzed
Gasoline Range Organics	BQL	7.95	5035	1	06/06/06
Diesel Range Organics	BQL	8.68	3541	1	06/12/06

Comments:

Flags:



Results for Total Petroleum Hydrocarbons
by GC/FID 8015

Client Sample ID: Delta T-009
 Client Project ID: NV013
 Lab Sample ID: G650-59-8
 Lab Project ID: G650-59
 Report Basis: Dry Weight

Analyzed By: MJC
 Date Collected: 6/1/2006 14:35
 Date Received: 6/2/2006
 Matrix: Soil
 Solids 68.96

Analyte	Result MG/KG	RL MG/KG	Prep Method	Dilution Factor	Date Analyzed
Gasoline Range Organics	9.64	8.15	5035	1	06/06/06
Diesel Range Organics	BQL	8.50	3541	1	06/12/06

Comments:

Flags:



Results for Total Petroleum Hydrocarbons
by GC/FID 8015

Client Sample ID: Trip Blank
 Client Project ID: NV013
 Lab Sample ID: G650-59-9
 Lab Project ID: G650-59
 Report Basis: Dry Weight

Analyzed By: MJC
 Date Collected: 6/1/2006 0:00
 Date Received: 6/2/2006
 Matrix: Soil
 Solids 100.00

Analyte	Result MG/KG	RL MG/KG	Prep Method	Dilution Factor	Date Analyzed
Gasoline Range Organics	BQL	6.00	5035	1	06/06/06

Comments:

Flags:



List of Reporting Abbreviations
and Data Qualifiers

- B = Compound also detected in batch blank
- BQL = Below Quantitation Limit (RL or MDL)
- DF = Dilution Factor
- Dup = Duplicate
- D = Detected, but RPD is > 40% between results in dual column method.
- E = Estimated concentration, exceeds calibration range.
- J = Estimated concentration, below calibration range and above MDL
- LCS(D) = Laboratory Control Spike (Duplicate)
- MDL = Method Detection Limit
- MS(D) = Matrix Spike (Duplicate)
- PQL = Practical Quantitation Limit
- RL = Reporting Limit
- RPD = Relative Percent Difference
- mg/kg = milligram per kilogram, ppm, parts per million
- ug/kg = micrograms per kilogram, ppb, parts per billion
- mg/L = milligram per liter, ppm, parts per million
- ug/L = micrograms per liter, ppb, parts per billion
- % Rec = Percent Recovery
- % solids = Percent Solids

Special Notes:

- 1) Metals and mercury samples are digested with a hot block, see the standard operating procedure document for details.
- 2) Uncertainty for all reported data is less than or equal to 30 percent.



CHAIN OF CUSTODY RECORD
SGS Environmental Services Inc.

- Locations Nationwide:
- Alaska
 - Hawaii
 - Louisiana
 - Maryland
 - New Jersey
 - North Carolina
 - West Virginia

www.us.sgs.com

052686

SGS Reference: G650-99

PAGE 1 OF 1

1 CLIENT: **Southern Consulting Inc.**
 CONTACT: **Chris Murray** PHONE NO: **757 777-8982**
 PROJECT: **NV013** SITE/SPSR: **Delta Taxway**
 REPORTS TO: **Chris Murray** FAX NO: **757 777-8982**
 INVOICE TO: **Chris Murray** QUOTE #
Delta Taxway
VA Beach, VA P.O. NUMBER

LAB NO.	SAMPLE IDENTIFICATION	DATE	TIME	MATRIX	NO CONTAINERS	SAMPLE TYPE G- COAP G- GRAS	Preserved Used Analysis Required	REMARKS
	DELTA-002	4/16/09	0915	S	3			Sampled @ 6' BLS
	DELTA-003	4/16/09	0952	S	3			" 5' BLS
	DELTA-004	4/16/09	0956	S	3			" 4 1/2" BLS
	DELTA-005	4/16/09	1350	S	3			" 5' BLS
	DELTA-006	4/16/09	1357	S	3			" 5' BLS
	DELTA-007	4/16/09	1405	S	3			" 5' BLS
	DELTA-008	4/16/09	1430	S	3			" 5' BLS
	DELTA-009	4/16/09	1435	S	3			" 5' BLS
	TIP Blank	4/16/09	1414	W	2			

3 Collected/Relinquished By: (1) **[Signature]** Date: **4/16/09** Time: **0900** Received By: **[Signature]**
 Relinquished By: (2) **[Signature]** Date: **4/16/09** Time: **0900** Received By: **[Signature]**
 Relinquished By: (3) **[Signature]** Date: **4/16/09** Time: **0900** Received By: **[Signature]**
 Relinquished By: (4) **[Signature]** Date: **4/16/09** Time: **0900** Received By: **[Signature]**

4 Shipping Carrier: **EDD** Shipping Ticket No: **EDD**
 Special Deliverable Requirements: **EDD FORMAT**
 Requested Turnaround Time and Special Instructions: **Standard TA**
Email results to: CMurray@SOUCON.COM
"EDD" format MAIL@SOUCON.COM

Samples Received Cold? (Circle) YES NO
 Temperature (C): **14.8°C**
 Chain of Custody Seal: (Circle) INTACT BROKEN **ABSENT**

D 200 W. Parker Drive Anchorage, AK 99518 Tel: (907) 962-2343 Fax: (907) 961-6301
 D 5500 Business Drive Wilmington, NC 28405 Tel: (910) 350-1900 Fax: (910) 350-1557
 D 1228 Greenbrier Street Charleston, WV 25311 Tel: (304) 346-0725 Fax: (304) 346-0761
 Yellow - Returned With Report
 Pink - Returned By Sampler

APPENDIX C
PHOTOGRAPHS

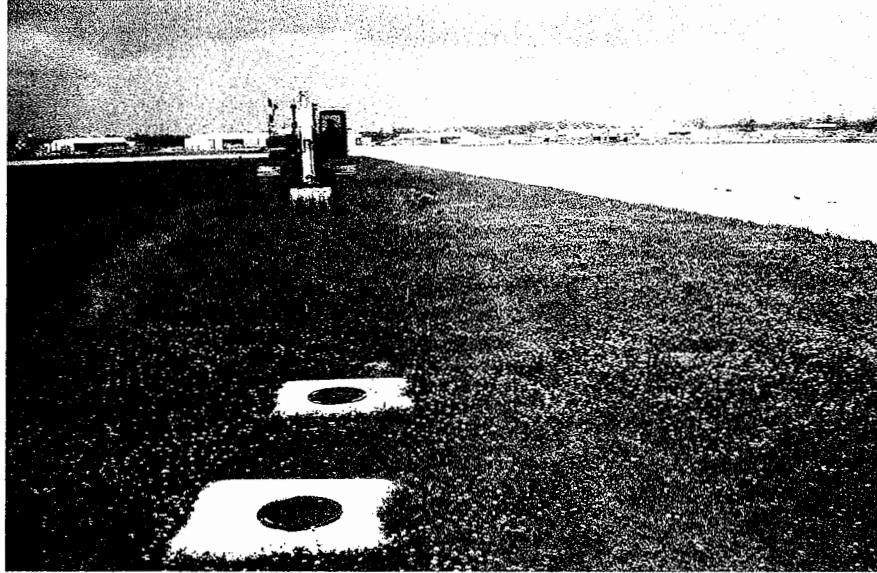

View of excavation from MW03 and MW05



Excavation activities

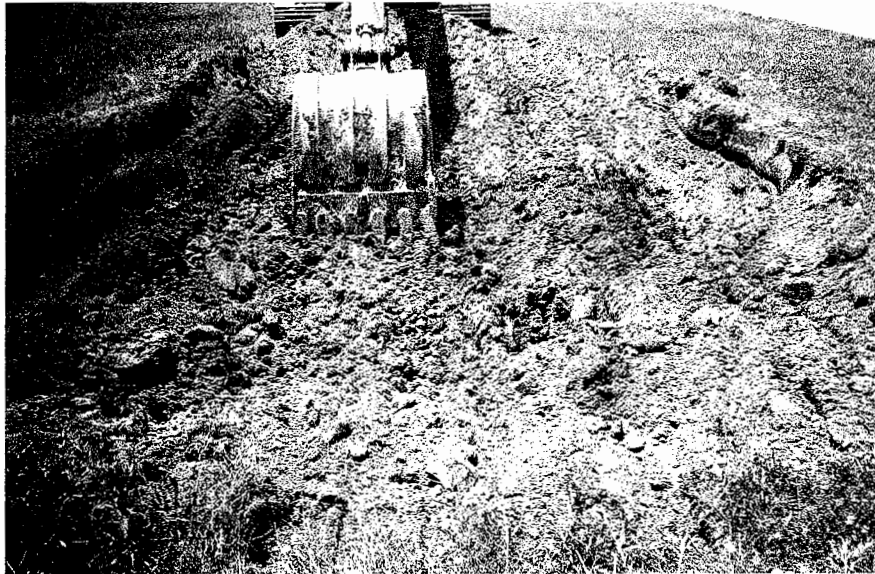

Excavation activities



Completed excavation with backfill

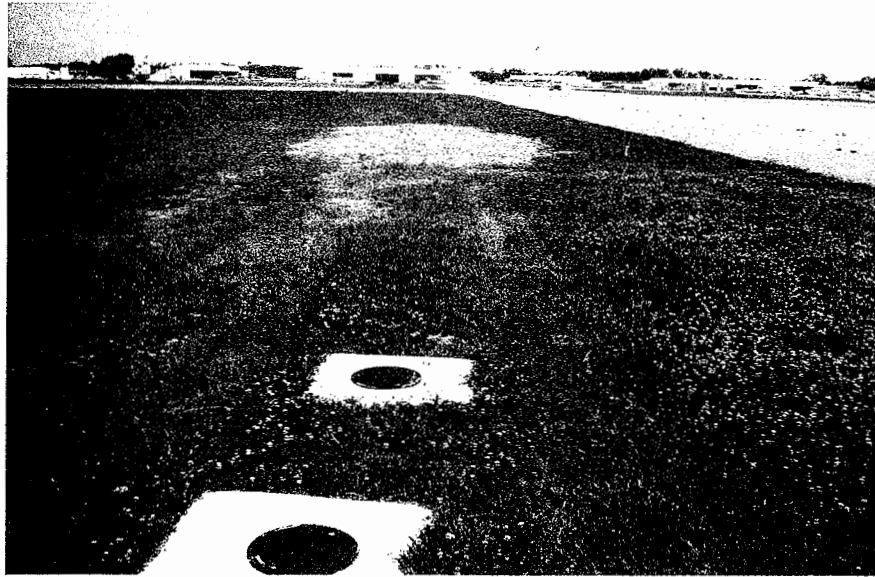

Backfilled excavation view from MW03 and MW05

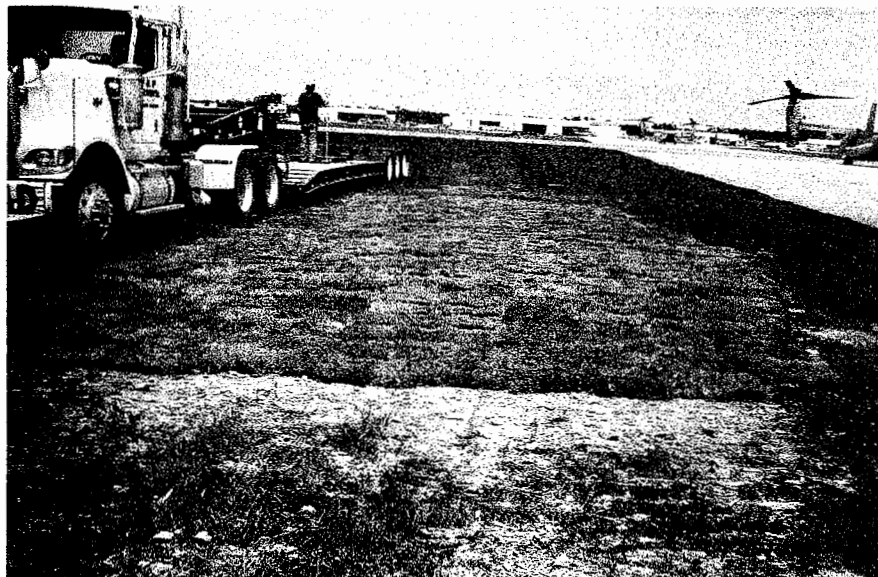

Excavation site restoration

APPENDIX D

SOIL DISPOSAL MANIFESTS

P & F Environmental

4352 N. Old Carriage Road • Rocky Mount, NC 27804
Phone: (252) 443-4083 • Fax: (252) 443-4104

NON-HAZARDOUS WASTE MANIFEST

APPROVAL # AS060001

LOAD # 0001

GENERATOR

MOAS NEW RIVER NC

DESTINATION

Land Application Facility Permit No. SR0500106
Speights Chapel Road
Whitakers, NC 27891

PHONE: 1 757 777-8182

PHONE: (252) 443-4083

WASTE DESCRIPTION:

Non-Hazardous Petroleum Contaminated Soil

WASTE ORIGATION:

[Signature]

Transporter: P & F Environmental

Gross Weight (lbs.): 59200

Truck #: PF 101

Tare Weight (lbs.): 23140

Truck Tag #/State: ZB 12251

Net Weight (lbs.): 36060

Driver Name (Print): Bryant

Net Weight (tons): 18.03

I hereby certify that the material stated herein was received at the waste origination site listed.

I hereby certify that the material stated herein was delivered without incident to the destination listed.

[Signature] 5-31-06
Driver Signature Date

[Signature] 5-31-06
Driver Signature Date

Inspected and Accepted By: [Signature]

NOTICE TO TRANSPORTER

**TRUCKS WILL NOT BE PERMITTED TO ENTER
THE FACILITY WITHOUT THIS ENTRANCE TICKET**

WHITE - Invoice YELLOW - Generator PINK - Trucker GOLD - P & F Environmental

P & F Environmental

4352 N. Old Carriage Road • Rocky Mount, NC 27804
Phone: (252) 443-4083 • Fax: (252) 443-4104

NON-HAZARDOUS WASTE MANIFEST

APPROVAL # 145060002

LOAD # 0002

GENERATOR

MCAS NEW RIVER
DELTA TAXIWAY

DESTINATION

Land Application Facility Permit No. SR0500106
Speights Chapel Road
Whitakers, NC 27891

PHONE: 1-757-777-8180

PHONE: (252) 443-4083

WASTE DESCRIPTION:

Non-Hazardous Petroleum Contaminated Soil

WASTE ORIGINATION:

MCAS NEW RIVER

[Signature]

Transporter: P & F Environmental

Gross Weight (lbs.): 75660

Truck #: PF 102103

Tare Weight (lbs.): 31620

Truck Tag #/State: ZB 12252

Net Weight (lbs.): 44040

Driver Name (Print): Johnny

Net Weight (tons): 22.02

I hereby certify that the material stated herein was received at the waste origination site listed.

I hereby certify that the material stated herein was delivered without incident to the destination listed.

[Signature]
Driver Signature

5-31-06
Date

[Signature]
Driver Signature

5-31-06
Date

Inspected and Accepted By: *[Signature]*

NOTICE TO TRANSPORTER

TRUCKS WILL NOT BE PERMITTED TO ENTER THE FACILITY WITHOUT THIS ENTRANCE TICKET

P & F Environmental

4352 N. Old Carriage Road • Rocky Mount, NC 27804
Phone: (252) 443-4083 • Fax: (252) 443-4104

NON-HAZARDOUS WASTE MANIFEST

APPROVAL # AS060003

LOAD # 0003

GENERATOR

MCAS NEW RIVER
DELTA TAXIWAY

DESTINATION

Land Application Facility Permit No. SR0500106
Speights Chapel Road
Whitakers, NC 27891

PHONE: 757-777-8982

PHONE: (252) 443-4083

WASTE DESCRIPTION:

Non-Hazardous Petroleum Contaminated Soil

WASTE ORIGATION:

MCAS NEW RIVER

Perry Land

Transporter: P & F Environmental

Gross Weight (lbs.): 71000

Truck #: PF103 102

Tare Weight (lbs.): 34440

Truck Tag #/State: ZB16949

Net Weight (lbs.): 36560

Driver Name (Print): Walter

Net Weight (tons): 18.28

I hereby certify that the material stated herein was received at the waste origination site listed.

Walter Parker 5/31/06
Driver Signature Date

I hereby certify that the material stated herein was delivered without incident to the destination listed.

Walter Parker 5/31/06
Driver Signature Date

Inspected and Accepted By: _____

Bryan Priddy

NOTICE TO TRANSPORTER

**TRUCKS WILL NOT BE PERMITTED TO ENTER
THE FACILITY WITHOUT THIS ENTRANCE TICKET**

P & F Environmental

4352 N. Old Carriage Road • Rocky Mount, NC 27804
Phone: (252) 443-4083 • Fax: (252) 443-4104

NON-HAZARDOUS WASTE MANIFEST

APPROVAL # AS 06 0004

LOAD # 0004

GENERATOR

MCAS NEW RIVER NC
DELTA TAXIWAY
HELICOPTER RELEASE AREA

DESTINATION

Land Application Facility Permit No. SR0500106
Speights Chapel Road
Whitakers, NC 27891

PHONE: 757-777-8987

PHONE: (252) 443-4083

WASTE DESCRIPTION:

Non-Hazardous Petroleum Contaminated Soil

WASTE ORIGINATION:

MCAS NEW RIVER NC

Bryant Priddy

Transporter: P & F Environmental

Gross Weight (lbs.): 67350

Truck #: PF 101

Tare Weight (lbs.): 23140

Truck Tag #/State: 2B12251

Net Weight (lbs.): 44210

Driver Name (Print): Bryant Priddy

Net Weight (tons): 22.10

I hereby certify that the material stated herein was received at the waste origination site listed.

I hereby certify that the material stated herein was delivered without incident to the destination listed.

Bryant Priddy
Driver Signature
6/1/06
Date

Bryant Priddy
Driver Signature
6-1-06
Date

Inspected and Accepted By: Bryant Priddy

NOTICE TO TRANSPORTER

**TRUCKS WILL NOT BE PERMITTED TO ENTER
THE FACILITY WITHOUT THIS ENTRANCE TICKET**

P & F Environmental

4352 N. Old Carriage Road • Rocky Mount, NC 27804
Phone: (252) 443-4083 • Fax: (252) 443-4104

NON-HAZARDOUS WASTE MANIFEST

APPROVAL # AS060005

LOAD # 0005

GENERATOR

MCAS NEW RIVER NC
DELTA TAXIWAY
Helicopter Release Area

DESTINATION

Land Application Facility Permit No. SR0500106
Speights Chapel Road
Whitakers, NC 27891

PHONE: 757-777-8982

PHONE: (252) 443-4083

WASTE DESCRIPTION:

Non-Hazardous Petroleum Contaminated Soil

WASTE ORIGINATION:

MCAS NEW RIVER NC
Johny Loughouse

Transporter: P & F Environmental

Gross Weight (lbs.): 94560

Truck #: PF 103

Tare Weight (lbs.): 31620

Truck Tag #/State: ZB12252

Net Weight (lbs.): 62940

Driver Name (Print): Johny Loughouse Net Weight (tons): 31.47

I hereby certify that the material stated herein was received at the waste origination site listed.

I hereby certify that the material stated herein was delivered without incident to the destination listed.

Johny Loughouse
Driver Signature

6/1/06
Date

Johny Loughouse
Driver Signature

6/1/06
Date

Inspected and Accepted By: Bryan D. Ridge

NOTICE TO TRANSPORTER

**TRUCKS WILL NOT BE PERMITTED TO ENTER
THE FACILITY WITHOUT THIS ENTRANCE TICKET**

WHITE - Invoice

YELLOW - Generator

PINK - Trucker

GOLD - P & F Environmental

P & F Environmental

4352 N. Old Carriage Road • Rocky Mount, NC 27804
Phone: (252) 443-4083 • Fax: (252) 443-4104

NON-HAZARDOUS WASTE MANIFEST

APPROVAL # AS060006

LOAD # 0006

GENERATOR
MCAS NEW RIVER NC
DELTA TALKWAY
HELICOPTER RELEASE AREA

DESTINATION
Land Application Facility Permit No. SR0500106
Speights Chapel Road
Whitakers, NC 27891

PHONE: 757-777-8982

PHONE: (252) 443-4083

WASTE DESCRIPTION: Non-Hazardous Petroleum Contaminated Soil

WASTE ORIGINATION: MCAS NEW RIVER NC

Jenny Jones

Transporter: P & F Environmental
Truck #: PF 102
Truck Tag #/State: ZB16949
Driver Name (Print): WALTER PARKER

Gross Weight (lbs.): 92110
Tare Weight (lbs.): 34440
Net Weight (lbs.): 61670
Net Weight (tons): 30.83

I hereby certify that the material stated herein was received at the waste origination site listed.

Walter Parker 6/1/06
Driver Signature Date

I hereby certify that the material stated herein was delivered without incident to the destination listed.

Walter Parker 6/1/06
Driver Signature Date

Inspected and Accepted By: _____

Bryan D. Dind

NOTICE TO TRANSPORTER

**TRUCKS WILL NOT BE PERMITTED TO ENTER
THE FACILITY WITHOUT THIS ENTRANCE TICKET**