

**MANAGEMENT RECOMMENDATIONS REPORT
UST MANAGEMENT PROGRAM**

**YEAR 2006
(JANUARY 2006 – DECEMBER 2006)**

**MARINE CORPS BASE
CAMP LEJEUNE, NORTH CAROLINA**

DECEMBER 29, 2006

**CONTRACT NO. N62470-05-D-6200
DELIVERY ORDER NO. 0003
CATLIN PROJECT NO. 205-002**

PREPARED BY:

**CATLIN ENGINEERS AND SCIENTISTS
P.O BOX 10279
WILMINGTON, NORTH CAROLINA 28404-0279
(910) 452-5861**

TABLE OF CONTENTS

MANAGEMENT RECOMMENDATIONS REPORT MCB CAMP LEJEUNE UST MANAGEMENT PROGRAM

EXECUTIVE SUMMARY

- A. Introduction
- B. Index of Sites
- C. Glossary of Abbreviations

UST/AST SITES AT MCAS NEW RIVER and MCB CAMP LEJEUNE

1.0 SITE AS-843

- 1.1 Site Information
- 1.2 Monitoring Schedule for 2006 Event(s)
- 1.3 Recommended Monitoring Schedule
- 1.4 Site Remediation Method
- 1.5 Recommended Remediation Modifications
- 1.6 Recommended Steps Toward Site Closure

2.0 SITE 311

- 2.1 Site Information
- 2.2 Monitoring Schedule for 2006 Event(s)
- 2.3 Recommended Monitoring Schedule
- 2.4 Site Remediation Method
- 2.5 Recommended Remediation Modifications
- 2.6 Recommended Steps Toward Site Closure

3.0 SITE 728 (Gottschalk Marina)

- 3.1 Site Information
- 3.2 Monitoring Schedule for 2006 Event(s)
- 3.3 Recommended Monitoring Schedule
- 3.4 Site Remediation Method
- 3.5 Recommended Remediation Modifications
- 3.6 Recommended Steps Toward Site Closure

TABLE OF CONTENTS – continued

4.0 SITE 1070 (Michael Road Fuel Farm)

- 4.1 Site Information
- 4.2 Monitoring Schedule for 2006 Event(s)
- 4.3 Recommended Monitoring Schedule
- 4.4 Site Remediation Method
- 4.5 Recommended Remediation Modifications
- 4.6 Recommended Steps Toward Site Closure

5.0 SITE FC-40-3

- 5.1 Site Information
- 5.2 Monitoring Schedule for 2006 Event(s)
- 5.3 Recommended Monitoring Schedule
- 5.4 Site Remediation Method
- 5.5 Recommended Remediation Modifications
- 5.6 Recommended Steps Toward Site Closure

6.0 SITE FC-201E

- 6.1 Site Information
- 6.2 Monitoring Schedule for 2006 Event(s)
- 6.3 Recommended Monitoring Schedule
- 6.4 Site Remediation Method
- 6.5 Recommended Remediation Modifications
- 6.6 Recommended Steps Toward Site Closure

7.0 SITE HPFF

- 7.1 Site Information
- 7.2 Monitoring Schedule for 2006 Event(s)
- 7.3 Recommended Monitoring Schedule
- 7.4 Site Remediation Method
- 7.5 Recommended Remediation Modifications
- 7.6 Recommended Steps Toward Site Closure

8.0 SITE PP-3311

- 8.1 Site Information
- 8.2 Monitoring Schedule for 2006 Event(s)
- 8.3 Recommended Monitoring Schedule
- 8.4 Site Remediation Method
- 8.5 Recommended Remediation Modifications
- 8.6 Recommended Steps Toward Site Closure

TABLE OF CONTENTS – continued

9.0 SITE PP-3322

- 9.1 Site Information
- 9.2 Monitoring Schedule for 2006 Event(s)
- 9.3 Recommended Monitoring Schedule
- 9.4 Site Remediation Method
- 9.5 Recommended Remediation Modifications
- 9.6 Recommended Steps Toward Site Closure

10.0 SITE PP-3340

- 10.1 Site Information
- 10.2 Monitoring Schedule for 2006 Event(s)
- 10.3 Recommended Monitoring Schedule
- 10.4 Site Remediation Method
- 10.5 Recommended Remediation Modifications
- 10.6 Recommended Steps Toward Site Closure

11.0 SITE PP-3343

- 11.1 Site Information
- 11.2 Monitoring Schedule for 2006 Event(s)
- 11.3 Recommended Monitoring Schedule
- 11.4 Site Remediation Method
- 11.5 Recommended Remediation Modifications
- 11.6 Recommended Steps Toward Site Closure

12.0 SITE PP-3354

- 12.1 Site Information
- 12.2 Monitoring Schedule for 2006 Event(s)
- 12.3 Recommended Monitoring Schedule
- 12.4 Site Remediation Method
- 12.5 Recommended Remediation Modifications
- 12.6 Recommended Steps Toward Site Closure

13.0 SITE TT-2463-73

- 13.1 Site Information
- 13.2 Monitoring Schedule for 2006 Event(s)
- 13.3 Recommended Monitoring Schedule
- 13.4 Site Remediation Method
- 13.5 Recommended Remediation Modifications
- 13.6 Recommended Steps Toward Site Closure

TABLE OF CONTENTS – continued

14.0 SITE TT-3165

- 14.1 Site Information
- 14.2 Monitoring Schedule for 2006 Event(s)
- 14.3 Recommended Monitoring Schedule
- 14.4 Site Remediation Method
- 14.5 Recommended Remediation Modifications
- 14.6 Recommended Steps Toward Site Closure

15.0 SITE TT-3233

- 15.1 Site Information
- 15.2 Monitoring Schedule for 2006 Event(s)
- 15.3 Recommended Monitoring Schedule
- 15.4 Site Remediation Method
- 15.5 Recommended Remediation Modifications
- 15.6 Recommended Steps Toward Site Closure

Appendix A Year 2007 - Proposed Monitoring Plan

EXECUTIVE SUMMARY

A. Introduction

The purpose of this *Management Recommendations Report* is to provide recommendations to MCB Camp Lejeune Environmental Quality Branch (EQB), Environmental Management Division (EMD) managers responsible for making decisions regarding leaking underground storage tank (UST) and above ground storage tank (AST) incidents at MCB Camp Lejeune. The recommendations are based on recent monitoring data collected in accordance with the *Monitoring Plan* and presented in the *Annual Management Report* and procedures outlined in the *Program Strategy* adopted for the *MCB Camp Lejeune UST Management Program*.

This *Management Recommendations Report* is designed to contain recommendations only. Data, findings, and conclusions in support of the recommendations are contained in the corresponding *Annual Management Report* covering the same reporting period.

B. Index of Sites

SITE NAME	NCDENR INCIDENT NO.	SITE LOCATION	REPORT SECTION NO.
AS-843	21272	MCAS New River	1.0
311	21409	MCB Camp Lejeune	2.0
728 (Gottschalk Marina)	20443	MCB Camp Lejeune	3.0
1070 (Michael Road Fuel Farm)	32214	MCB Camp Lejeune	4.0
FC-40-3	24222	MCB Camp Lejeune	5.0
FC-201 East	23741	MCB Camp Lejeune	6.0
HPFF	3671, 10615, 22788	MCB Camp Lejeune	7.0
PP-3311	24007	MCB Camp Lejeune	8.0
PP-3322	24008	MCB Camp Lejeune	9.0
PP-3340	24012	MCB Camp Lejeune	10.0
PP-3343	24013	MCB Camp Lejeune	11.0
PP-3354	24015	MCB Camp Lejeune	12.0
TT-2463-73	21139	MCB Camp Lejeune	13.0
TT-3165	23971	MCB Camp Lejeune	14.0
TT-3233	23970	MCB Camp Lejeune	15.0

C. Glossary of Abbreviations

2L	North Carolina Administrative Code; Title 15A Department of Environment, Health, and Natural Resources; Division of Water Quality. Subchapter 2L, Classifications and Water Quality Standards Applicable to the Groundwaters of North Carolina; NCAC T15A: 2L.0202
AFVR	Aggressive Fluid Vapor Recovery
AS	Air Sparging
AST	Aboveground Storage Tank
BLS	Below Land Surface
BQL	Below Quantitation Limits
BS	Biosparging
BV	Bioventing
CAP	Corrective Action Plan
CERCLA	Comprehensive Environmental Response, Compensation and Liability Act
CSA	Comprehensive Site Assessment
DPE	Dual-Phase Extraction
DWQ	Division of Water Quality
EAD	Environmental Affairs Department, Facilities Directorate, Marine Corps Air Station Cherry Point, North Carolina
EDB	Ethylene Dibromide
EDD	Electronic Data Deliverables
EPA	Environmental Protection Agency
EPH	Extractable Petroleum Hydrocarbons
GCL	Gross Contamination Level
GC	Gas Chromatograph
Guidelines - Non-USTs	Groundwater Section Guidelines for the Investigation and Remediation of Soil and Ground Water; State of North Carolina, Department of Environment and Natural Resources, Division of Water Quality, Groundwater Section; July 2000.

Guidelines - USTs	Guidelines for Assessment and Corrective Action; State of North Carolina, Department of Environment and Natural Resources, Division of Waste Management, UST Section; April 2001.
IPE	Isopropyl Ether
L.G.	Licensed Geologist
LANTDIV	Atlantic Division, Naval Facilities Engineering Command
LUR	Land Use Restrictions
MADEP	Massachusetts Department of Environmental Protection
MCALF	Marine Corps Auxiliary Landing Field
MCAS	Marine Corps Air Station
MCOLF	Marine Corps Outlying Landing Field
MDL	Method Detection Limit
mg/Kg	Milligrams per Kilogram
mg/L	Milligrams per Liter
MMPE	Mobile Multi-Phase Extraction
MSCC	Maximum Soil Contaminant Concentration
MTBE	Methyl Tertiary Butyl Ether
NC	North Carolina
NCAC	North Carolina Administrative Code
NCDENR	North Carolina Department of Environment and Natural Resources
NFA	No Further Action
NOV	Notice of Violation
P.E.	Professional Engineer
PAH	Polynuclear Aromatic Hydrocarbons
RAC	Remedial Action Contractor
RFP	Request for Proposal
SVE	Soil Vapor Extraction
SVOC	Semi-Volatile Organic Compounds
TPH	Total Petroleum Hydrocarbons

ug/Kg	Micrograms per Kilogram
ug/L	Micrograms per Liter
UST	Underground Storage Tank
VOC	Volatile Organic Compounds
VPH	Volatile Petroleum Hydrocarbons

SECTION 1.0

Of The

MANAGEMENT RECOMMENDATIONS REPORT

MCB CAMP LEJEUNE UST MANAGEMENT PROGRAM

YEAR 2006
(JANUARY 2006 – DECEMBER 2006)

SITE-SPECIFIC MANAGEMENT RECOMMENDATIONS REPORT
FOR

SITE AS-843



1.0 SITE AS-843

1.1 Site Information

Location: MCAS New River, North Carolina

Incident No.: 21272

Estimated Land Use Classification: Industrial/Commercial

Estimated Risk Classification: Low

Source Type(s): 1,000 gallon and 550 gallon Diesel USTs

Free Product: No

1.2 Monitoring Schedule for 2006 Event(s)

Well gauging and sampling was completed on an annual basis by Sovereign Consulting Inc. (Sovereign) for 2006.

1.3 Recommended Monitoring Schedule

The recommended groundwater monitoring schedule for 2007 is provided in Appendix A of this document. The next monitoring events are proposed between January 1 through January 31, 2007 and July 1 through July 31, 2007. The monitoring contractor for the next event will be Sovereign.

Modifications to the schedule include:

- The sampling schedule should be reduced from annually to biennially.
- The gauging schedule should be reduced from quarterly to semi-annually.

1.4 Site Remediation Method

Natural attenuation of groundwater contamination is the only remediation approach currently being utilized at the subject site. Initially, an excavation was performed during tank closure activities. In addition, free product recovery via hand bailing was conducted at monitoring well USTAS843-MW04 historically. However, free product has not been detected in this monitoring well during the past six gauging events.

1.5 Recommended Remediation Modifications

There are no recommended modifications to the remediation approach.

1.6 Recommended Steps Toward Site Closure

As this site has been classified as Low Risk and Industrial/Commercial Land

Use and no contaminant concentrations are above any of the established GCLs, NFA with LURs could be requested. However, it is recommended that the five on-site groundwater monitoring wells at this site be sampled biennial (once every other year) in an attempt to close the site without LURs. As the site was sampled in July 2006, the next sampling event should be conducted in July 2008. Gauging events are recommended semi-annually, thus these should be conducted in January 2007, July 2007 and January 2008. If the July 2008 sampling event reveals all contaminant concentrations at levels below the 2L GWQS, a request for NFA should be submitted to the NCDENR.

To CATLIN's knowledge the source of contamination at the subject site was diesel fuel. According to the "Guidelines for Assessment and Corrective Action" effective July 1, 2001, diesel contaminated sites require groundwater sampling per EPA Method 602, EPA Method 625 + TICs, and MADEP VPH/EPH. Therefore, CATLIN recommends that the analytical methods be modified for the July 2008 monitoring event to reflect the requirements of the guidelines.

SECTION 2.0
Of The
MANAGEMENT RECOMMENDATIONS REPORT
MCB CAMP LEJEUNE UST MANAGEMENT PROGRAM

YEAR 2006
(JANUARY 2006 – DECEMBER 2006)

SITE-SPECIFIC MANAGEMENT RECOMMENDATIONS REPORT
FOR

SITE 311

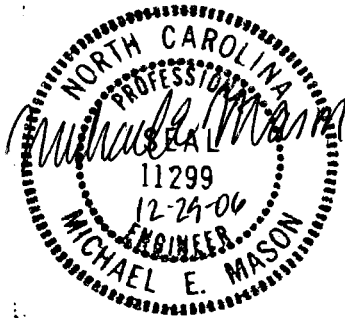

2.0 SITE 311

2.1 Site Information

Location: MCB Camp Lejeune, North Carolina

Incident No.: 21409

Estimated Land Use Classification: Residential

Estimated Risk Classification: Low

Source Type(s): 551 gallon Kerosene UST

Free Product: No

2.2 Monitoring Schedule for 2006 Event(s)

Well gauging and sampling was not conducted during 2006.

2.3 Recommended Monitoring Schedule

Site 311 will not be monitored during 2007 as NFA was granted on March 8, 2006 by the NCDENR.

2.4 Site Remediation Method

The remediation approach at the subject site was natural attenuation.

2.5 Recommended Remediation Modifications

There are no recommended modifications to the remediation approach.

2.6 Recommended Steps Toward Site Closure

The NCDENR granted NFA on March 8, 2006.

SECTION 3.0
Of The
MANAGEMENT RECOMMENDATIONS REPORT
MCB CAMP LEJEUNE UST MANAGEMENT PROGRAM

YEAR 2006
(JANUARY 2006 – DECEMBER 2006)

SITE-SPECIFIC MANAGEMENT RECOMMENDATIONS REPORT
FOR

SITE 728 (Gottschalk Marina)



3.0 SITE 728 (Gottschalk Marina)

3.1 Site Information

Location: MCB Camp Lejeune, North Carolina

Incident No.: 20443

Estimated Land Use Classification: Residential

Estimated Risk Classification: Low

Source Type(s): 250 gallon Fuel Oil UST and 1,000 gallon Gasoline UST

Free Product: No

3.2 Monitoring Schedule for 2006 Event(s)

Well gauging and sampling was not conducted during 2006 under the UST Program. Soil sampling was conducted in May 2006 by Sovereign.

3.3 Recommended Monitoring Schedule

Site 728 will not be monitored during 2007 under the UST Program as NFA with land use restrictions has been approved. Also, any additional investigations at this site will be conducted under the IR Program.

3.4 Site Remediation Method

Soil excavation was the remediation approach implemented at this site.

3.5 Recommended Remediation Modifications

There are no recommended modifications to the remediation approach.

3.6 Recommended Steps Towards Site Closure

Sovereign collected one soil sample in May 2006 at the location which exceeded the action level during the 2005 tank closure sampling performed by Shaw. Analytical results from the May 2006 soil sampling indicated Benzene at concentrations above the Soil-to-Groundwater MSCCs, however no compounds were detected in excess of the Residential MSCCs.

Any additional investigative activities at this site will be conducted under the MCB Camp Lejeune IR Program. The site has been approved for "NFA with land use restrictions" under the UST Program upon approval of the land use restrictions documentation.

SECTION 4.0
Of The
MANAGEMENT RECOMMENDATIONS REPORT
MCB CAMP LEJEUNE UST MANAGEMENT PROGRAM

YEAR 2006
(JANUARY 2006 – DECEMBER 2006)

SITE-SPECIFIC MANAGEMENT RECOMMENDATIONS REPORT
FOR

SITE 1070 (Michael Road Fuel Farm)



4.0 SITE 1070 (Michael Road Fuel Farm)

4.1 Site Information

Location: MCB Camp Lejeune, North Carolina

Incident No.: 32214

Estimated Land Use Classification: Residential

Estimated Risk Classification: Low

Source Type(s): 2,500 gallon UST containing mixed fuel

Free Product: No

4.2 Monitoring Schedule for 2006 Event(s)

Well gauging and sampling was completed on an annual basis by Sovereign for 2006.

4.3 Recommended Monitoring Schedule

Site 1070 (Michael Road Fuel Farm) will not be monitored during 2007 as NFA was granted on July 10, 2006 by the NCDENR.

4.4 Site Remediation Method

Soil excavation was the remediation approach implemented at this site.

4.5 Recommended Remediation Modifications

There are no recommended modifications to the remediation approach.

4.6 Recommended Steps Toward Site Closure

The NCDENR granted NFA on July 10, 2006. The two on-site monitoring wells (UST1070-MW01 and UST1070-MW02) were abandoned in October 2006.

SECTION 5.0

Of The

MANAGEMENT RECOMMENDATIONS REPORT

MCB CAMP LEJEUNE UST MANAGEMENT PROGRAM

YEAR 2006
(JANUARY 2006 – DECEMBER 2006)

SITE-SPECIFIC MANAGEMENT RECOMMENDATIONS REPORT
FOR

SITE FC-40-3



5.0 SITE FC-40-3

5.1 Site Information

Location: MCB Camp Lejeune, North Carolina

Incident No.: 24222

Estimated Land Use Classification: Industrial/Commercial

Estimated Risk Classification: Low

Source Type(s): 1,000 gallon Used Oil UST

Free Product: No

5.2 Monitoring Schedule for 2006 Event(s)

Well gauging and sampling was not conducted during 2006.

5.3 Recommended Monitoring Schedule

The recommended groundwater monitoring schedule for 2007 is provided in Appendix A of this document. The next monitoring event is proposed between July 1 through July 31, 2007. The monitoring contractor for the next event needs to be determined.

Modifications to the schedule include:

- Install a temporary monitoring well and collect a groundwater sample for analysis per EPA Method 625 and MADEP VPH/EPH.

5.4 Site Remediation Method

Soil excavation was the remediation approach implemented at this site.

5.5 Recommended Remediation Modifications

There are no recommended modifications to the remediation approach.

5.6 Recommended Steps Toward Site Closure

The NCDENR agreed with a request for NFA w/LUR for this site in July 2005. However, currently the MCB Camp Lejeune does not have a finalized land use restriction document acceptable to the state of North Carolina. Therefore, CATLIN recommends that a groundwater sample be collected in July 2007 to determine if contaminant levels have naturally attenuated to below the 2L GWQS. If contaminant levels are below the 2L GWQS then a request for NFA should be submitted to the NCDENR.

SECTION 6.0
Of The
MANAGEMENT RECOMMENDATIONS REPORT
MCB CAMP LEJEUNE UST MANAGEMENT PROGRAM

YEAR 2006
(JANUARY 2006 – DECEMBER 2006)

SITE-SPECIFIC MANAGEMENT RECOMMENDATIONS REPORT
FOR

SITE FC-201E



6.0 SITE FC-201E

6.1 Site Information

Location: MCB Camp Lejeune, North Carolina

Incident No.: 23741

Estimated Land Use Classification: Industrial/Commercial

Estimated Risk Classification: Low

Source Type(s): 550 gallon Waste Oil UST

Free Product: No

6.2 Monitoring Schedule for 2006 Event(s)

Well gauging and sampling was completed on an annual basis by Sovereign for 2006.

6.3 Recommended Monitoring Schedule

Site FC-201E will not be monitored during 2007 as NFA was granted on November 2, 2006 by the NCDENR.

6.4 Site Remediation Method

The remediation approach at the subject site was a soil excavation followed by natural attenuation.

6.5 Recommended Remediation Modifications

There are no recommended modifications to the remediation approach at this site.

6.6 Recommended Steps Toward Site Closure

The NCDENR granted NFA on November 2, 2006. The on-site monitoring wells should be abandoned in accordance with NCDENR requirements.

SECTION 7.0

Of The

MANAGEMENT RECOMMENDATIONS REPORT

MCB CAMP LEJEUNE UST MANAGEMENT PROGRAM

YEAR 2006
(JANUARY 2006 – DECEMBER 2006)

SITE-SPECIFIC MANAGEMENT RECOMMENDATIONS REPORT
FOR

SITE HPFF



7.0 SITE HPFF

7.1 Site Information

Location: MCB Camp Lejeune, North Carolina

Incident Nos.: 3671, 10615, and 22788

Estimated Land Use Classification: Industrial/Commercial

Estimated Risk Classification: Intermediate

Source Type(s): Gasoline, Diesel and Kerosene

Free Product: Yes

7.2 Monitoring Schedule for 2006 Event(s)

Well gauging and sampling was completed on a semi-annual basis by Shaw during 2006.

7.3 Recommended Monitoring Schedule

The recommended groundwater monitoring schedule for 2007 is provided in Appendix A of this document. The next monitoring event is proposed between July 1 and July 31, 2007. The monitoring contractor for the next event will be Shaw.

Modifications to the schedule include:

- Modify sampling frequency from semi-annual to annual.
- Remove EPA Method 610, Method 415.1 (TOC), Method RSK-175, and Method 9056 (Nitrate, Nitrite and Sulfate) from the sampling schedule.
- A significant number of monitoring wells have been added to the sampling schedule (See Figure 7 in Appendix A for monitoring wells to be sampled).

7.4 Site Remediation Method

Due to the size and depth of the free product and dissolved phase groundwater contamination plume various remediation technologies are being implemented at the subject site. These include AS/SVE, Free Product Recovery, AFVR, Bio-Pulsing and Natural Attenuation.

7.5 Recommended Remediation Modifications

There are no recommended modifications to the remediation approach at this site.

7.6 Recommended Steps Toward Site Closure

A reduction in the temporarily assigned risk ranking from "Intermediate" to "Low" is dependent upon removal of the free product from this site and the remediation of the deep dissolved phase groundwater contamination. Once these two criteria are met a reclassification to Low risk should be achievable. Upon reclassification, the Gross Contamination Levels (GCLs) would be applicable and if contaminant levels are below the GCLs, NFA with land use restrictions may be requested.

During 2007 CATLIN recommends selected on-site monitoring wells be sampled on an annual basis per EPA Method 602 and Natural Attenuation Field Parameters (i.e. pH, DO, Turbidity, Temperature, Conductivity and ORP). Please note, historically EPA Method 610 analysis has been performed during sampling events. However, the concentrations of EPA Method 610 compounds (i.e. Naphthalene) are significantly lower than the EPA Method 602 compounds (i.e. Benzene). In addition, the extent of the EPA Method 602 dissolved phase plume encompasses the EPA Method 610 dissolved phase plume. Therefore, CATLIN believes that the dissolved phase groundwater contamination can be delineated by using EPA Method 602 only.

For future monitoring events (i.e. 2008 and beyond), CATLIN recommends semi-annual groundwater sampling of a minimal number of monitoring wells (i.e. 25-30) per EPA Method 602 and 610 and Natural Attenuation Field Parameters. Also, comprehensive groundwater sampling events (i.e. approximately 75 wells) should be performed on a biennial basis (every two years) per EPA Method 602 only.

SECTION 8.0
Of The
MANAGEMENT RECOMMENDATIONS REPORT
MCB CAMP LEJEUNE UST MANAGEMENT PROGRAM

YEAR 2006
(JANUARY 2006 – DECEMBER 2006)

SITE-SPECIFIC MANAGEMENT RECOMMENDATIONS REPORT
FOR

SITE PP-3311



8.0 SITE PP-3311

8.1 Site Information

Location: MCB Camp Lejeune, North Carolina

Incident No.: 24007

Estimated Land Use Classification: Residential

Estimated Risk Classification: Low

Source Type(s): 285 gallon Fuel Oil UST

Free Product: No

8.2 Monitoring Schedule for 2006 Event(s)

Well gauging and sampling was not conducted during 2006.

8.3 Recommended Monitoring Schedule

The recommended groundwater monitoring schedule for 2007 is provided in Appendix A of this document. The next monitoring event is proposed between July 1 through July 31, 2007. The monitoring contractor for the next event needs to be determined.

Modifications to the schedule include:

- Install a temporary monitoring well and collect a groundwater sample for analysis per EPA Method 602 (including Naphthalene) and MADEP VPH/EPH.

8.4 Site Remediation Method

Soil excavation was the remediation approach implemented at this site.

8.5 Recommended Remediation Modifications

There are no recommended modifications to the remediation approach at this site.

8.6 Recommended Steps Toward Site Closure

The subject site qualifies for NFA with LURs based on the risk classification and contaminant levels. However, currently the MCB Camp Lejeune does not have a finalized land use restriction document acceptable to the state of North Carolina. Therefore, CATLIN recommends that a groundwater sample be collected in July 2007 to determine if contaminant levels have naturally attenuated to below the 2L GWQS. If contaminant levels are below the 2L GWQS then a request for NFA should be submitted to the NCDENR.

SECTION 9.0
Of The
MANAGEMENT RECOMMENDATIONS REPORT
MCB CAMP LEJEUNE UST MANAGEMENT PROGRAM

YEAR 2006
(JANUARY 2006 – DECEMBER 2006)

SITE-SPECIFIC MANAGEMENT RECOMMENDATIONS REPORT
FOR

SITE PP-3322



9.0 SITE PP-3322

9.1 Site Information

Location: MCB Camp Lejeune, North Carolina

Incident No.: 24008

Estimated Land Use Classification: Residential

Estimated Risk Classification: Low

Source Type(s): 285 gallon Heating Oil UST

Free Product: No

9.2 Monitoring Schedule for 2006 Event(s)

Well gauging and sampling was not conducted during 2006.

9.3 Recommended Monitoring Schedule

The recommended groundwater monitoring schedule for 2007 is provided in Appendix A of this document. The next monitoring event is proposed between July 1 through July 31, 2007. The monitoring contractor for the next event needs to be determined.

Modifications to the schedule include:

- Install a temporary monitoring well and collect a groundwater sample for analysis per EPA Method 602 (including Naphthalene) and MADEP VPH/EPH.

9.4 Site Remediation Method

Soil excavation was the remediation approach implemented at this site.

9.5 Recommended Remediation Modifications

There are no recommended modifications to the remediation approach at this site.

9.6 Recommended Steps Toward Site Closure

The subject site qualifies for NFA with LURs based on the risk classification and contaminant levels. However, currently the MCB Camp Lejeune does not have a finalized land use restriction document acceptable to the state of North Carolina. Therefore, CATLIN recommends that a groundwater sample be collected in July 2007 to determine if contaminant levels have naturally attenuated to below the 2L GWQS. If contaminant levels are below the 2L GWQS then a request for NFA should be submitted to the NCDENR.

SECTION 10.0
Of The
MANAGEMENT RECOMMENDATIONS REPORT
MCB CAMP LEJEUNE UST MANAGEMENT PROGRAM

YEAR 2006
(JANUARY 2006 – DECEMBER 2006)

SITE-SPECIFIC MANAGEMENT RECOMMENDATIONS REPORT
FOR

SITE PP-3340



10.0 SITE PP-3340

10.1 Site Information

Location: MCB Camp Lejeune, North Carolina

Incident No.: 24012

Estimated Land Use Classification: Residential

Estimated Risk Classification: Low

Source Type(s): 285 gallon Heating Oil UST

Free Product: No

10.2 Monitoring Schedule for 2006 Event(s)

Well gauging and sampling was not conducted during 2006.

10.3 Recommended Monitoring Schedule

The recommended groundwater monitoring schedule for 2007 is provided in Appendix A of this document. The next monitoring event is proposed between July 1 through July 31, 2007. The monitoring contractor for the next event needs to be determined.

Modifications to the schedule include:

- Install a temporary monitoring well and collect a groundwater sample for analysis per MADEP VPH/EPH only.

10.4 Site Remediation Method

Soil excavation was the remediation approach implemented at this site.

10.5 Recommended Remediation Modifications

There are no recommended modifications to the remediation approach at this site.

10.6 Recommended Steps Toward Site Closure

The subject site qualifies for NFA with LURs based on the risk classification and contaminant levels. However, currently the MCB Camp Lejeune does not have a finalized land use restriction document acceptable to the state of North Carolina. Therefore, CATLIN recommends that a groundwater sample be collected in July 2007 to determine if contaminant levels have naturally attenuated to below the 2L GWQS. If contaminant levels are below the 2L GWQS then a request for NFA should be submitted to the NCDENR.

SECTION 11.0
Of The
MANAGEMENT RECOMMENDATIONS REPORT
MCB CAMP LEJEUNE UST MANAGEMENT PROGRAM

YEAR 2006
(JANUARY 2006 – DECEMBER 2006)

SITE-SPECIFIC MANAGEMENT RECOMMENDATIONS REPORT
FOR

SITE PP-3343



11.0 SITE PP-3343

11.1 Site Information

Location: MCB Camp Lejeune, North Carolina

Incident No.: 24013

Estimated Land Use Classification: Residential

Estimated Risk Classification: Low

Source Type(s): 285 gallon Heating Oil UST

Free Product: No

11.2 Monitoring Schedule for 2006 Event(s)

Well gauging and sampling was not conducted during 2006.

11.3 Recommended Monitoring Schedule

The recommended groundwater monitoring schedule for 2007 is provided in Appendix A of this document. The next monitoring event is proposed between July 1 through July 31, 2007. The monitoring contractor for the next event needs to be determined.

Modifications to the schedule include:

- Install a temporary monitoring well and collect a groundwater sample for analysis per MADEP VPH/EPH only.

11.4 Site Remediation Method

Soil excavation was the remediation approach implemented at this site.

11.5 Recommended Remediation Modifications

There are no recommended modifications to the remediation approach.

11.6 Recommended Steps Toward Site Closure

The subject site qualifies for NFA with LURs based on the risk classification and contaminant levels. However, currently the MCB Camp Lejeune does not have a finalized land use restriction document acceptable to the state of North Carolina. Therefore, CATLIN recommends that a groundwater sample be collected in July 2007 to determine if contaminant levels have naturally attenuated to below the 2L GWQS. If contaminant levels are below the 2L GWQS then a request for NFA should be submitted to the NCDENR.

SECTION 12.0

Of The

MANAGEMENT RECOMMENDATIONS REPORT

MCB CAMP LEJEUNE UST MANAGEMENT PROGRAM

YEAR 2006
(JANUARY 2006 – DECEMBER 2006)

SITE-SPECIFIC MANAGEMENT RECOMMENDATIONS REPORT
FOR

SITE PP-3354



12.0 SITE PP-3354

12.1 Site Information

Location: MCB Camp Lejeune, North Carolina

Incident No.: 24015

Estimated Land Use Classification: Residential

Estimated Risk Classification: Low

Source Type(s): 285 gallon Heating Oil UST

Free Product: No

12.2 Monitoring Schedule for 2006 Event(s)

Well gauging and sampling was not conducted during 2006.

12.3 Recommended Monitoring Schedule

The recommended groundwater monitoring schedule for 2007 is provided in Appendix A of this document. The next monitoring event is proposed between July 1 through July 31, 2007. The monitoring contractor for the next event needs to be determined.

Modifications to the schedule include:

- Install a temporary monitoring well and collect a groundwater sample for analysis per EPA Method 602 (including Naphthalene) and MADEP VPH/EPH.
- A soil sample should be collected in the vicinity of the previous sample, USTPP3354-SB03(3-4'), and analyzed per MADEP VPH/EPH only.

12.4 Site Remediation Method

Soil excavation was the remediation approach implemented at this site.

12.5 Recommended Remediation Modifications

There are no recommended modifications to the remediation approach.

12.6 Recommended Steps Toward Site Closure

The subject site qualifies for NFA with LURs based on the risk classification and contaminant levels. However, currently the MCB Camp Lejeune does not have a finalized land use restriction document acceptable to the state of North Carolina. Therefore, CATLIN recommends that soil and groundwater samples be collected in July 2007 to determine if contaminant levels have naturally attenuated to below applicable MSCCs and the 2L GWQS, respectively. If contaminant levels are below the 2L GWQS then a request for NFA should be submitted to the NCDENR.

SECTION 13.0

Of The

MANAGEMENT RECOMMENDATIONS REPORT

MCB CAMP LEJEUNE UST MANAGEMENT PROGRAM

YEAR 2006
(JANUARY 2006 – DECEMBER 2006)

SITE-SPECIFIC MANAGEMENT RECOMMENDATIONS REPORT
FOR

SITE TT-2463-73



13.0 SITE TT-2463-73

13.1 Site Information

Location: MCB Camp Lejeune, North Carolina

Incident No.: 21139

Estimated Land Use Classification: Residential

Estimated Risk Classification: Low

Source Type(s): Six, 500 gallon Heating Oil USTs

Free Product: No

13.2 Monitoring Schedule for 2006 Event(s)

Well gauging and sampling was not conducted during 2006.

13.3 Recommended Monitoring Schedule

Site TT-2463-73 will not be monitored during 2007 under the UST Program as NFA with land use restrictions has been approved.

13.4 Site Remediation Method

A Soil Vapor Extraction and Biosparge remediation system was installed at the subject site and began operation in August 1996. The system operated at the site until it was shutdown in 2002. Subsequent to system shutdown soil excavations were completed in 2003 and 2004.

13.5 Recommended Remediation Modifications

There are no recommended modifications to the remediation approach.

13.6 Recommended Steps Toward Site Closure

The site has been approved for "NFA with land use restrictions" under the UST Program upon approval of the land use restrictions documentation. MCB Camp Lejeune should consider re-sampling this site within the next five years in an attempt to remove the land use restriction.

SECTION 14.0

Of The

MANAGEMENT RECOMMENDATIONS REPORT

MCB CAMP LEJEUNE UST MANAGEMENT PROGRAM

YEAR 2006
(JANUARY 2006 – DECEMBER 2006)

SITE-SPECIFIC MANAGEMENT RECOMMENDATIONS REPORT
FOR

SITE TT-3165



14.0 SITE TT-3165

14.1 Site Information

Location: MCB Camp Lejeune, North Carolina

Incident No.: 23971

Estimated Land Use Classification: Residential

Estimated Risk Classification: Low

Source Type(s): 550 gallon Heating Oil UST

Free Product: No

14.2 Monitoring Schedule for 2006 Event(s)

Well gauging and sampling was not conducted during 2006.

14.3 Recommended Monitoring Schedule

The recommended groundwater monitoring schedule for 2007 is provided in Appendix A of this document. The next monitoring event is proposed between July 1 through July 31, 2007. The monitoring contractor for the next event needs to be determined.

Modifications to the schedule include:

- Install a temporary monitoring well and collect a groundwater sample for analysis per MADEP VPH/EPH only.

14.4 Site Remediation Method

Soil excavation was the remediation approach implemented at this site.

14.5 Recommended Remediation Modifications

There are no recommended modifications to the remediation approach.

14.6 Recommended Steps Toward Site Closure

The subject site qualifies for NFA with LURs based on the risk classification and contaminant levels. However, currently the MCB Camp Lejeune does not have a finalized land use restriction document acceptable to the state of North Carolina. Therefore, CATLIN recommends that a groundwater sample be collected in July 2007 to determine if contaminant levels have naturally attenuated to below the 2L GWQS. If contaminant levels are below the 2L GWQS then a request for NFA should be submitted to the NCDENR.

SECTION 15.0

Of The

MANAGEMENT RECOMMENDATIONS REPORT

MCB CAMP LEJEUNE UST MANAGEMENT PROGRAM

YEAR 2006
(JANUARY 2006 – DECEMBER 2006)

SITE-SPECIFIC MANAGEMENT RECOMMENDATIONS REPORT
FOR

SITE TT-3233



15.0 SITE TT-3233

15.1 Site Information

Location: MCB Camp Lejeune, North Carolina

Incident No.: 23970

Estimated Land Use Classification: Residential

Estimated Risk Classification: Low

Source Type(s): 550 gallon Heating Oil UST

Free Product: No

15.2 Monitoring Schedule for 2006 Event(s)

Well gauging and sampling was not conducted during 2006.

15.3 Recommended Monitoring Schedule

The recommended groundwater monitoring schedule for 2007 is provided in Appendix A of this document. The next monitoring event is proposed between July 1 through July 31, 2007. The monitoring contractor for the next event needs to be determined.

Modifications to the schedule include:

- Install a temporary monitoring well and collect a groundwater sample for analysis per EPA Method 602 only.

15.4 Site Remediation Method

The remediation approach at the subject site was excavation.

15.5 Recommended Remediation Modifications

There are no recommended modifications to the remediation approach.

15.6 Recommended Steps Toward Site Closure

The subject site qualifies for NFA with LURs based on the risk classification and contaminant levels. However, currently the MCB Camp Lejeune does not have a finalized land use restriction document acceptable to the state of North Carolina. Therefore, CATLIN recommends that a groundwater sample be collected in July 2007 to determine if contaminant levels have naturally attenuated to below the 2L GWQS. If contaminant levels are below the 2L GWQS then a request for NFA should be submitted to the NCDENR.

Appendix A

Year 2007 - Proposed Monitoring Plan

**MCB CAMP LEJEUNE
UST MANAGEMENT PROGRAM**



LEGEND

- | | | |
|--|---|---|
| <p>Monitoring Wells</p> <ul style="list-style-type: none"> ⊕ Type I ⊕ Type II ⊕ Type III ⊕ Pumping Well ⊗ Unknown Well Type ● Water Supply Wells ■ Above Ground Storage Tank ■ Underground Storage Tank — Railroad Tracks ⊗ FENCE △ GATE — WALL | <p>Buildings and Structures</p> <ul style="list-style-type: none"> ■ Buildings and Structures ■ Demolished Structures ■ Oil/Water Separators ■ Slabs ■ Roads ■ Driveways ■ Parking Lots ■ Surface Water Bodies ■ Creeks and Streams ■ Groundwater Flow Direction | <p>Vegetation Cover</p> <ul style="list-style-type: none"> ■ Forestland ■ Scrubland ■ Wetland <p>Airfield Pavement</p> <ul style="list-style-type: none"> ■ HELIPAD ■ RAMP ■ RUNWAY ■ SHLDR_OVERRUN ■ TAXIWAY |
|--|---|---|

NOTES

1. Monitoring currently being conducted by Sovereign. Site should be gauged semi-annually and sampled biennial. Therefore, as the site was sampled in July 2006 the next sampling event will not be conducted until July 2008.
2. Site to be gauged between January 1 and January 31, 2007. Results due to CATLIN in EDD format by March 1, 2007.
3. Site to be gauged between July 1 and July 31, 2007. Results due to CATLIN in EDD format by September 1, 2007.



**SITE AS-843
MONITORING PLAN
YEAR 2007**

FIGURE

1

Job No.: 205-002	Date: DEC 2006	Scale: AS SHOWN	Drawn By: SAC	Checked By: MEM
---------------------	-------------------	--------------------	------------------	--------------------

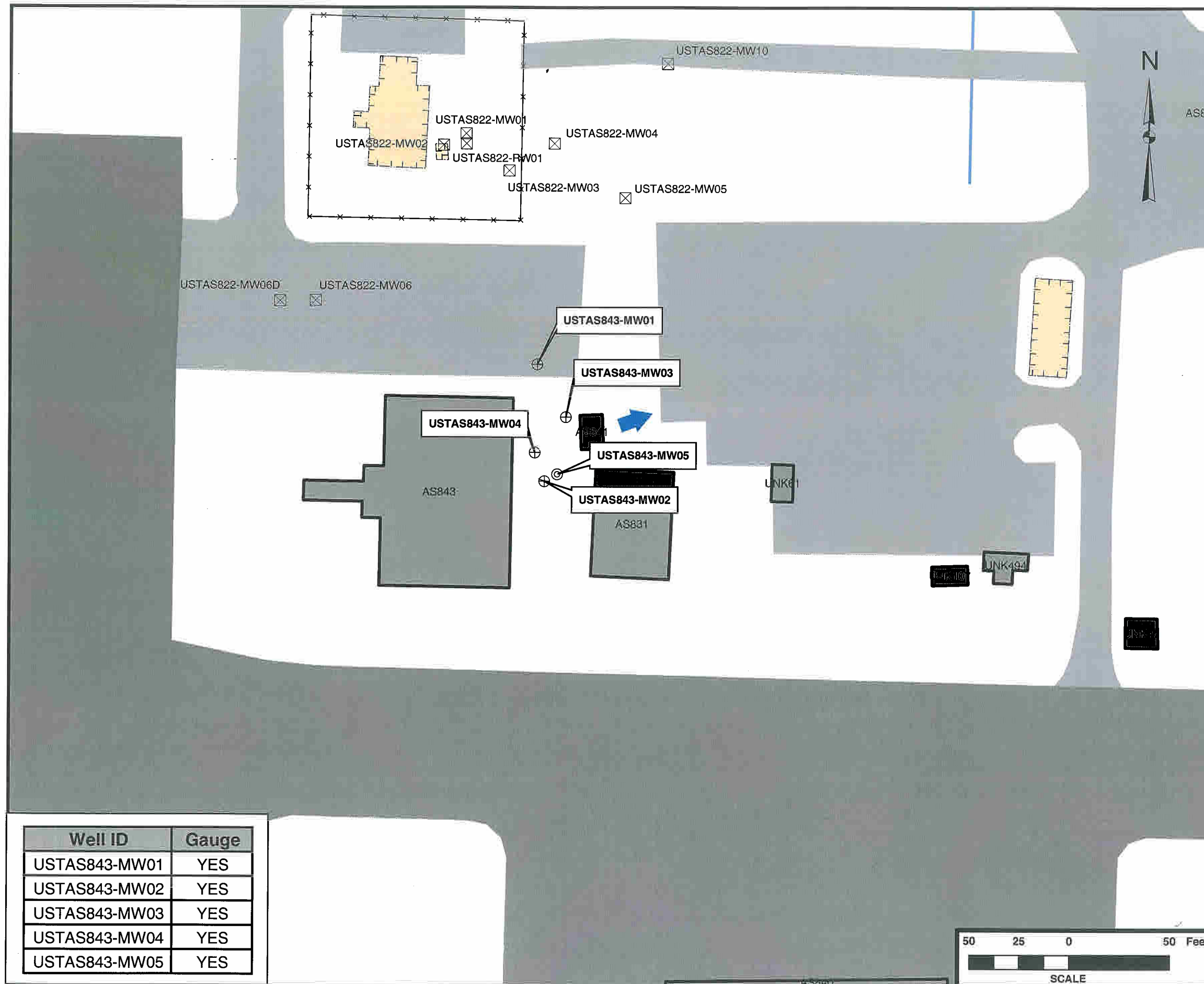

Well ID	Gauge
USTAS843-MW01	YES
USTAS843-MW02	YES
USTAS843-MW03	YES
USTAS843-MW04	YES
USTAS843-MW05	YES

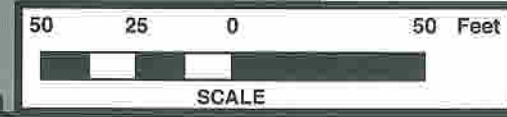

MCB CAMP LEJEUNE UST MANAGEMENT PROGRAM



LEGEND

- | | | |
|---------------------------|--------------------------|--------------------------|
| Monitoring Wells | Buildings and Structures | Vegetation Cover |
| ⊙ Type I | Demolished Structures | Forestland |
| ⊕ Type II | Oil/Water Separators | Scrubland |
| ⊗ Type III | Slabs | Wetland |
| ⊖ Pumping Well | Roads | Airfield Pavement |
| ⊠ Unknown Well Type | Driveways | HELIPAD |
| Water Supply Wells | Parking Lots | RAMP |
| Above Ground Storage Tank | Surface Water Bodies | RUNWAY |
| Underground Storage Tank | Creeks and Streams | SHLDR_OVERRUN |
| Railroad Tracks | | TAXIWAY |
| Walls and Fences | | |
| FENCE | | |
| GATE | | |
| WALL | | |

NOTES

1. Site not currently being sampled (Last sampled November 2004). Site should be sampled in July 2007. Monitoring contractor needs to be determined.
2. Samples to be collected between July 1 and July 31, 2007. Results due to CATLIN in EDD format by September 1, 2007.

NOTE: The previous groundwater sample collected was from a temporary well which has been subsequently abandoned. Therefore, it is recommended that another temporary well be installed to collect the proposed groundwater sample.



**SITE FC-40-3
MONITORING PLAN
YEAR 2007**

FIGURE

5

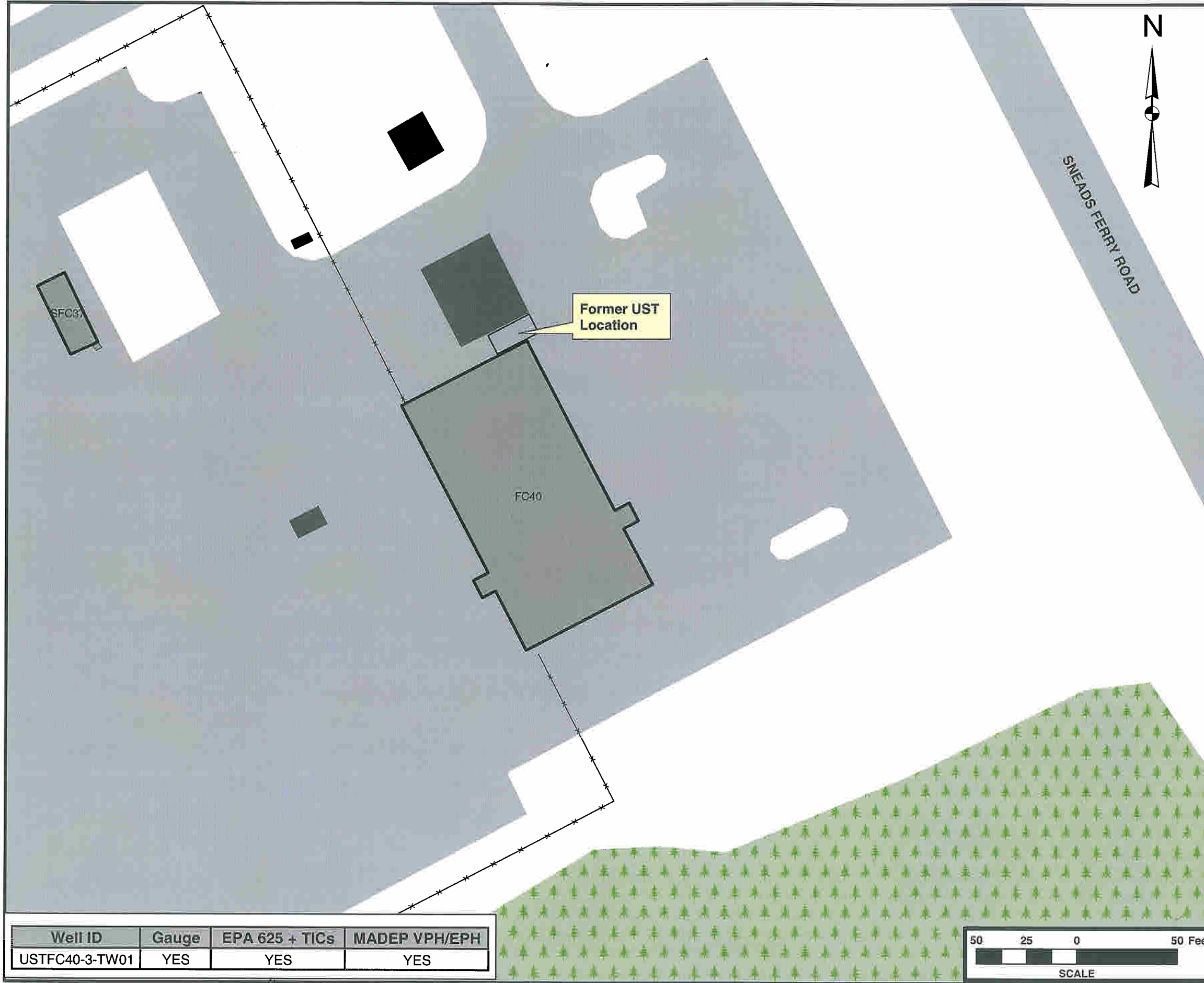

Well ID	Gauge	EPA 625 + TICs	MADEP VPH/EPH
USTFC40-3-TW01	YES	YES	YES

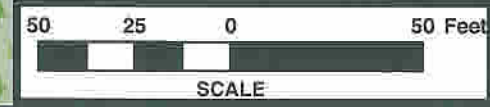

Job No.: 205-002	Date: DEC 2006	Scale: AS SHOWN	Drawn By: SAC	Checked By: MEM
---------------------	-------------------	--------------------	------------------	--------------------

MCB CAMP LEJEUNE UST MANAGEMENT PROGRAM



LEGEND

- | | | |
|---|---|--|
| Monitoring Wells
Type I
Type II
Type III
Pumping Well
Unknown
Water Supply Wells
Above Ground Storage Tank
Underground Storage Tank
Railroad Tracks | Buildings and Structures
Demolished Structures
Oil/Water Separators
Slabs
Roads
Driveways
Parking Lots
Surface Water Bodies
Creeks and Streams
Groundwater Flow Direction
FENCE
GATE
WALL | Vegetation Cover
FORESTLAND
SCRUBLAND
WETLAND
Airfield Pavement
HELIPAD
RAMP
RUNWAY
SHLDR_OVERRUN
TAXIWAY |
|---|---|--|

NOTES

- Monitoring currently being conducted by Shaw. Site should be sampled annually.
- Site to be sampled between July 1 and July 31, 2007. Results due to CATLIN in EDD format by September 1, 2007.
- In addition to EPA 602, the following field parameters should be collected from each well sampled: Conductivity, Dissolved Oxygen, Oxidation-Reduction Potential, pH, Temperature, and Turbidity.



SITE HPFF MONITORING PLAN YEAR 2007

FIGURE

7

Job No.: 205-002	Date: DEC 2006	Scale: AS SHOWN	Drawn By: SAC	Checked By: MEM
---------------------	-------------------	--------------------	------------------	--------------------

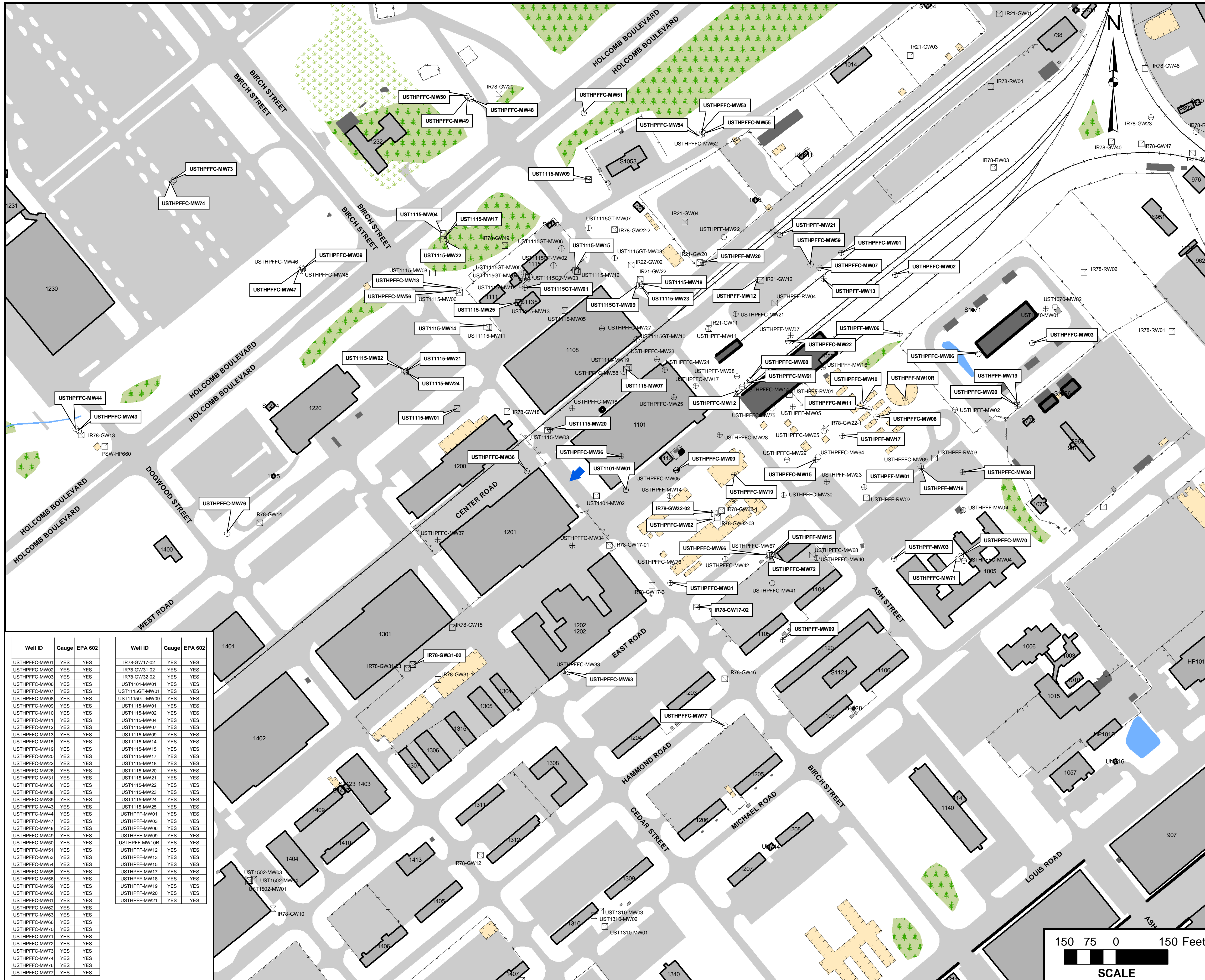

Well ID	Gauge	EPA 602	Well ID	Gauge	EPA 602
USTHPFFC-MW01	YES	YES	IR78-GW17-02	YES	YES
USTHPFFC-MW02	YES	YES	IR78-GW31-02	YES	YES
USTHPFFC-MW03	YES	YES	IR78-GW32-02	YES	YES
USTHPFFC-MW06	YES	YES	UST1101-MW01	YES	YES
USTHPFFC-MW07	YES	YES	UST115GT-MW01	YES	YES
USTHPFFC-MW08	YES	YES	UST115GT-MW09	YES	YES
USTHPFFC-MW09	YES	YES	UST1115-MW01	YES	YES
USTHPFFC-MW10	YES	YES	UST1115-MW02	YES	YES
USTHPFFC-MW11	YES	YES	UST1115-MW04	YES	YES
USTHPFFC-MW12	YES	YES	UST1115-MW07	YES	YES
USTHPFFC-MW13	YES	YES	UST1115-MW09	YES	YES
USTHPFFC-MW15	YES	YES	UST1115-MW14	YES	YES
USTHPFFC-MW19	YES	YES	UST1115-MW15	YES	YES
USTHPFFC-MW20	YES	YES	UST1115-MW17	YES	YES
USTHPFFC-MW22	YES	YES	UST1115-MW18	YES	YES
USTHPFFC-MW26	YES	YES	UST1115-MW20	YES	YES
USTHPFFC-MW31	YES	YES	UST1115-MW21	YES	YES
USTHPFFC-MW36	YES	YES	UST1115-MW22	YES	YES
USTHPFFC-MW38	YES	YES	UST1115-MW23	YES	YES
USTHPFFC-MW39	YES	YES	UST1115-MW24	YES	YES
USTHPFFC-MW43	YES	YES	UST1115-MW25	YES	YES
USTHPFFC-MW44	YES	YES	USTHPFF-MW01	YES	YES
USTHPFFC-MW47	YES	YES	USTHPFF-MW03	YES	YES
USTHPFFC-MW48	YES	YES	USTHPFF-MW06	YES	YES
USTHPFFC-MW49	YES	YES	USTHPFF-MW09	YES	YES
USTHPFFC-MW50	YES	YES	USTHPFF-MW10R	YES	YES
USTHPFFC-MW51	YES	YES	USTHPFF-MW12	YES	YES
USTHPFFC-MW53	YES	YES	USTHPFF-MW13	YES	YES
USTHPFFC-MW54	YES	YES	USTHPFF-MW15	YES	YES
USTHPFFC-MW55	YES	YES	USTHPFF-MW17	YES	YES
USTHPFFC-MW56	YES	YES	USTHPFF-MW18	YES	YES
USTHPFFC-MW59	YES	YES	USTHPFF-MW19	YES	YES
USTHPFFC-MW60	YES	YES	USTHPFF-MW20	YES	YES
USTHPFFC-MW61	YES	YES	USTHPFF-MW21	YES	YES
USTHPFFC-MW62	YES	YES			
USTHPFFC-MW63	YES	YES			
USTHPFFC-MW66	YES	YES			
USTHPFFC-MW70	YES	YES			
USTHPFFC-MW71	YES	YES			
USTHPFFC-MW72	YES	YES			
USTHPFFC-MW73	YES	YES			
USTHPFFC-MW74	YES	YES			
USTHPFFC-MW76	YES	YES			
USTHPFFC-MW77	YES	YES			

MCB CAMP LEJEUNE
UST MANAGEMENT PROGRAM



LEGEND

- | | | |
|-----------------------------|---------------------------------|--------------------------|
| Monitoring Wells | Buildings and Structures | Vegetation Cover |
| ○ Type I | ■ Demolished Structures | ■ Forestland |
| ⊕ Type II | ■ Oil/Water Separators | ■ Scrubland |
| ⊙ Type III | ■ Slabs | ■ Wetland |
| ⊖ Pumping Well | ■ Roads | Airfield Pavement |
| ⊗ Unknown Well Type | ■ Driveways | ■ HELIPAD |
| ● Water Supply Wells | ■ Parking Lots | ■ RAMP |
| ■ Above Ground Storage Tank | ■ Surface Water Bodies | ■ RUNWAY |
| ■ Underground Storage Tank | ■ Creeks and Streams | ■ SHLDR_OVERRUN |
| — Railroad Tracks | | ■ TAXIWAY |
| Walls and Fences | | |
| ⊗ FENCE | | |
| △ GATE | | |
| — WALL | | |

NOTES

1. Site not currently being sampled (Last sampled November 2004). Site should be sampled in July 2007. Monitoring contractor needs to be determined.
2. Samples to be collected between July 1 and July 31, 2007. Results due to CATLIN in EDD format by September 1, 2007.

NOTE: The previous groundwater sample collected was from a temporary well which has been subsequently abandoned. Therefore, it is recommended that another temporary well be installed to collect the proposed groundwater sample.



SITE PP-3311
MONITORING PLAN
YEAR 2007

FIGURE
8

Job No.: 205-002	Date: DEC 2006	Scale: AS SHOWN	Drawn By: SAC	Checked By: MEM
------------------	----------------	-----------------	---------------	-----------------

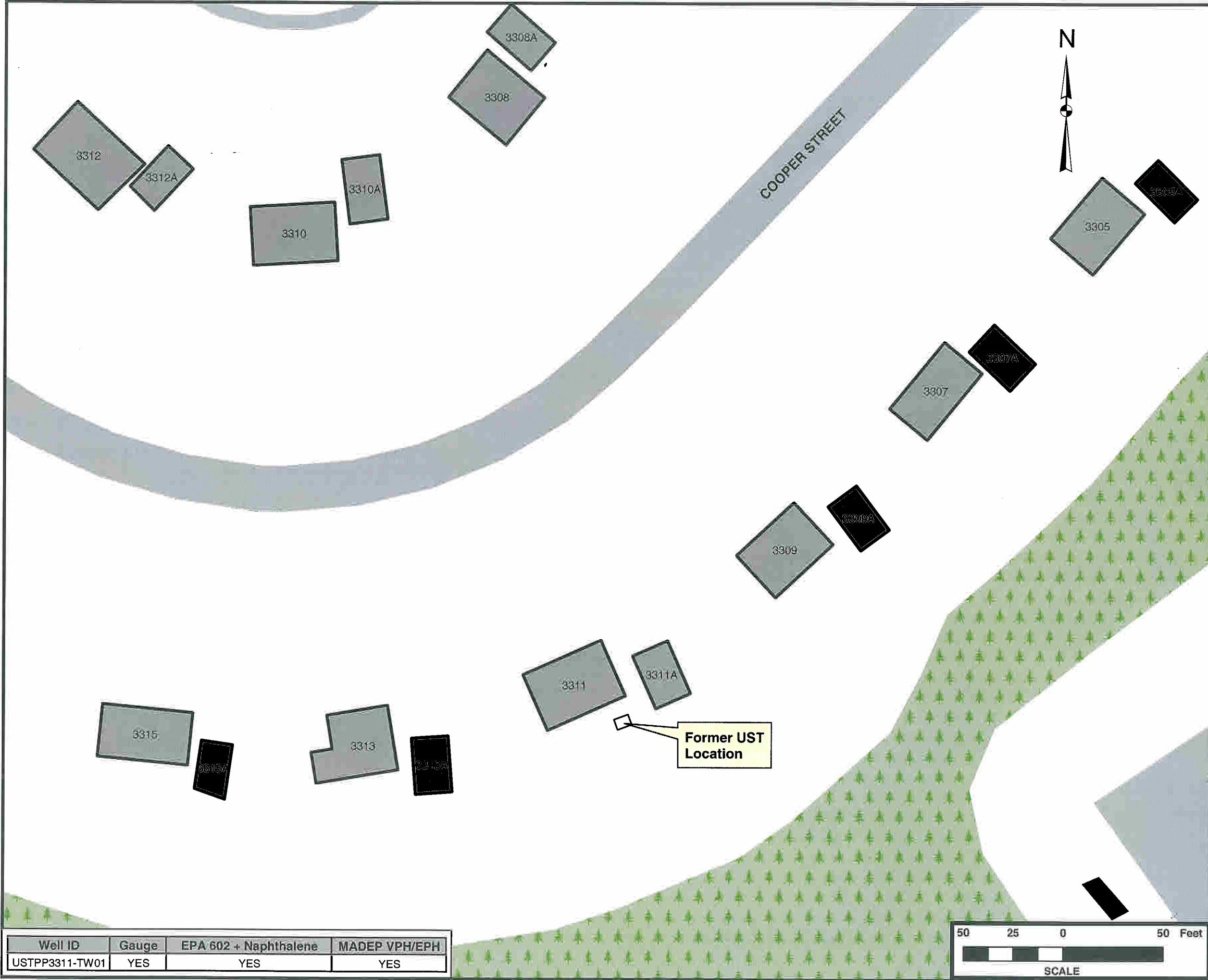

Well ID	Gauge	EPA 602 + Naphthalene	MADEP VPH/EPH
USTPP3311-TW01	YES	YES	YES

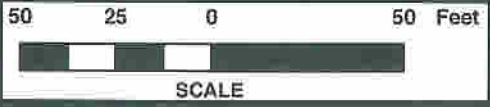

MCB CAMP LEJEUNE UST MANAGEMENT PROGRAM



LEGEND

- | | | |
|-----------------------------|---------------------------------|--------------------------|
| Monitoring Wells | Buildings and Structures | Vegetation Cover |
| ○ Type I | ■ Buildings and Structures | ■ Forestland |
| ⊕ Type II | ■ Demolished Structures | ■ Scrubland |
| ⊙ Type III | ■ Oil/Water Separators | ■ Wetland |
| ⊙ Pumping Well | ■ Slabs | Airfield Pavement |
| ⊙ Unknown Well Type | ■ Roads | ■ HELIPAD |
| ● Water Supply Wells | ■ Driveways | ■ RAMP |
| ■ Above Ground Storage Tank | ■ Parking Lots | ■ RUNWAY |
| ■ Underground Storage Tank | ■ Surface Water Bodies | ■ SHLDR_OVERRUN |
| — Railroad Tracks | ■ Creeks and Streams | ■ TAXIWAY |
| Walls and Fences | | |
| ⊗ FENCE | | |
| △ GATE | | |
| — WALL | | |

NOTES

1. Site not currently being sampled (Last sampled November 2004). Site should be sampled in July 2007. Monitoring contractor needs to be determined.
2. Samples to be collected between July 1 and July 31, 2007. Results due to CATLIN in EDD format by September 1, 2007.

NOTE: The previous groundwater sample collected was from a temporary well which has been subsequently abandoned. Therefore, it is recommended that another temporary well be installed to collect the proposed groundwater sample.



**SITE PP-3322
MONITORING PLAN
YEAR 2007**

FIGURE
9

Job No.: 205-002	Date: DEC 2006	Scale: AS SHOWN	Drawn By: SAC	Checked By: MEM
------------------	----------------	-----------------	---------------	-----------------

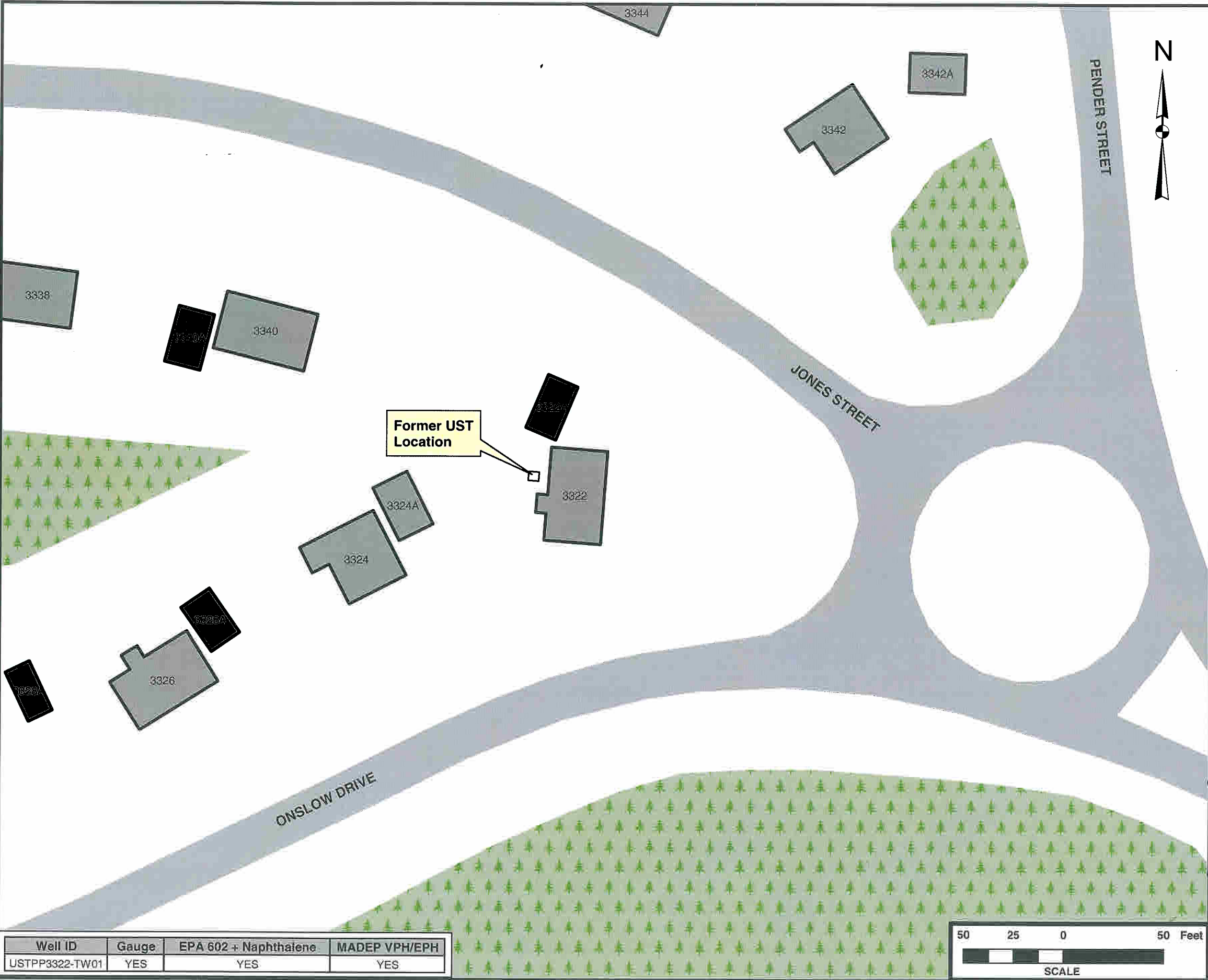

Well ID	Gauge	EPA 602 + Naphthalene	MADEP VPH/EPH
USTPP3322-TW01	YES	YES	YES

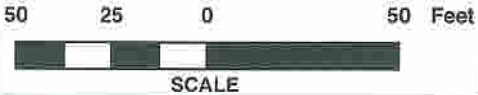

MCB CAMP LEJEUNE
UST MANAGEMENT PROGRAM



LEGEND

- | | | |
|-----------------------------|---------------------------------|--------------------------|
| Monitoring Wells | Buildings and Structures | Vegetation Cover |
| ⊕ Type I | ▭ Demolished Structures | 🌲 Forestland |
| ⊕ Type II | ▭ Oil/Water Separators | 🌳 Scrubland |
| ⊕ Type III | ▭ Slabs | 🌿 Wetland |
| ⊕ Pumping Well | ▭ Roads | Airfield Pavement |
| ⊕ Unknown Well Type | ▭ Driveways | ▭ HELIPAD |
| ⊕ Water Supply Wells | ▭ Parking Lots | ▭ RAMP |
| ▭ Above Ground Storage Tank | ▭ Surface Water Bodies | ▭ RUNWAY |
| ▭ Underground Storage Tank | ▭ Creeks and Streams | ▭ SHLDR_OVERRUN |
| ▭ Railroad Tracks | | ▭ TAXIWAY |
| Walls and Fences | | |
| ▭ FENCE | | |
| ▭ GATE | | |
| ▭ WALL | | |

NOTES

1. Site not currently being sampled (Last sampled November 2004). Site should be sampled in July 2007. Monitoring contractor needs to be determined.
2. Samples to be collected between July 1 and July 31, 2007. Results due to CATLIN in EDD format by September 1, 2007.

NOTE: The previous groundwater sample collected was from a temporary well which has been subsequently abandoned. Therefore, it is recommended that another temporary well be installed to collect the proposed groundwater sample.



SITE PP-3340
MONITORING PLAN
YEAR 2007

FIGURE
10

Job No.: 205-002	Date: DEC 2006	Scale: AS SHOWN	Drawn By: SAC	Checked By: MEM
------------------	----------------	-----------------	---------------	-----------------

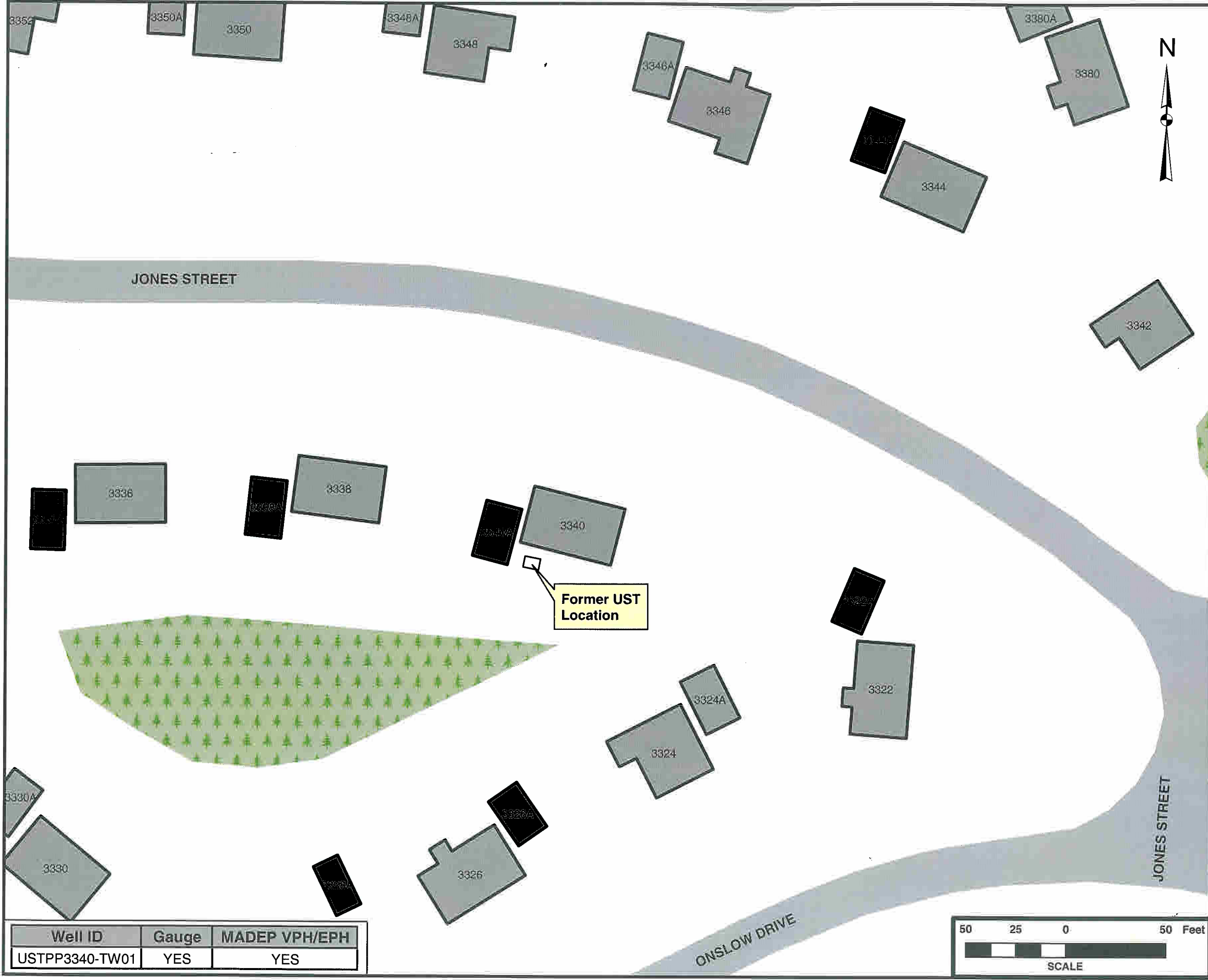

Well ID	Gauge	MADEP VPH/EPH
USTPP3340-TW01	YES	YES

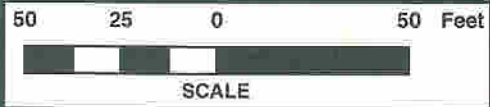

MCB CAMP LEJEUNE UST MANAGEMENT PROGRAM



LEGEND

- | | | |
|--|---|--|
| Monitoring Wells
○ Type I
⊕ Type II
⊙ Type III
⊕ Pumping Well
⊗ Unknown Well Type
● Water Supply Wells
■ Above Ground Storage Tank
■ Underground Storage Tank
— Railroad Tracks
X FENCE
△ GATE
— WALL | Buildings and Structures
■ Buildings and Structures
■ Demolished Structures
■ Oil/Water Separators
■ Slabs
■ Roads
■ Driveways
■ Parking Lots
■ Surface Water Bodies
■ Creeks and Streams | Vegetation Cover
■ Forestland
■ Scrubland
■ Wetland
Airfield Pavement
■ HELIPAD
■ RAMP
■ RUNWAY
■ SHLDR_OVERRUN
■ TAXIWAY |
|--|---|--|

NOTES

1. Site not currently being sampled (Last sampled November 2004). Site should be sampled in July 2007. Monitoring contractor needs to be determined.
2. Samples to be collected between July 1 and July 31, 2007. Results due to CATLIN in EDD format by September 1, 2007.

NOTE: The previous groundwater sample collected was from a temporary well which has been subsequently abandoned. Therefore, it is recommended that another temporary well be installed to collect the proposed groundwater sample.



**SITE PP-3343
MONITORING PLAN
YEAR 2007**

FIGURE

11

Job No.: 205-002	Date: DEC 2006	Scale: AS SHOWN	Drawn By: SAC	Checked By: MEM
------------------	----------------	-----------------	---------------	-----------------

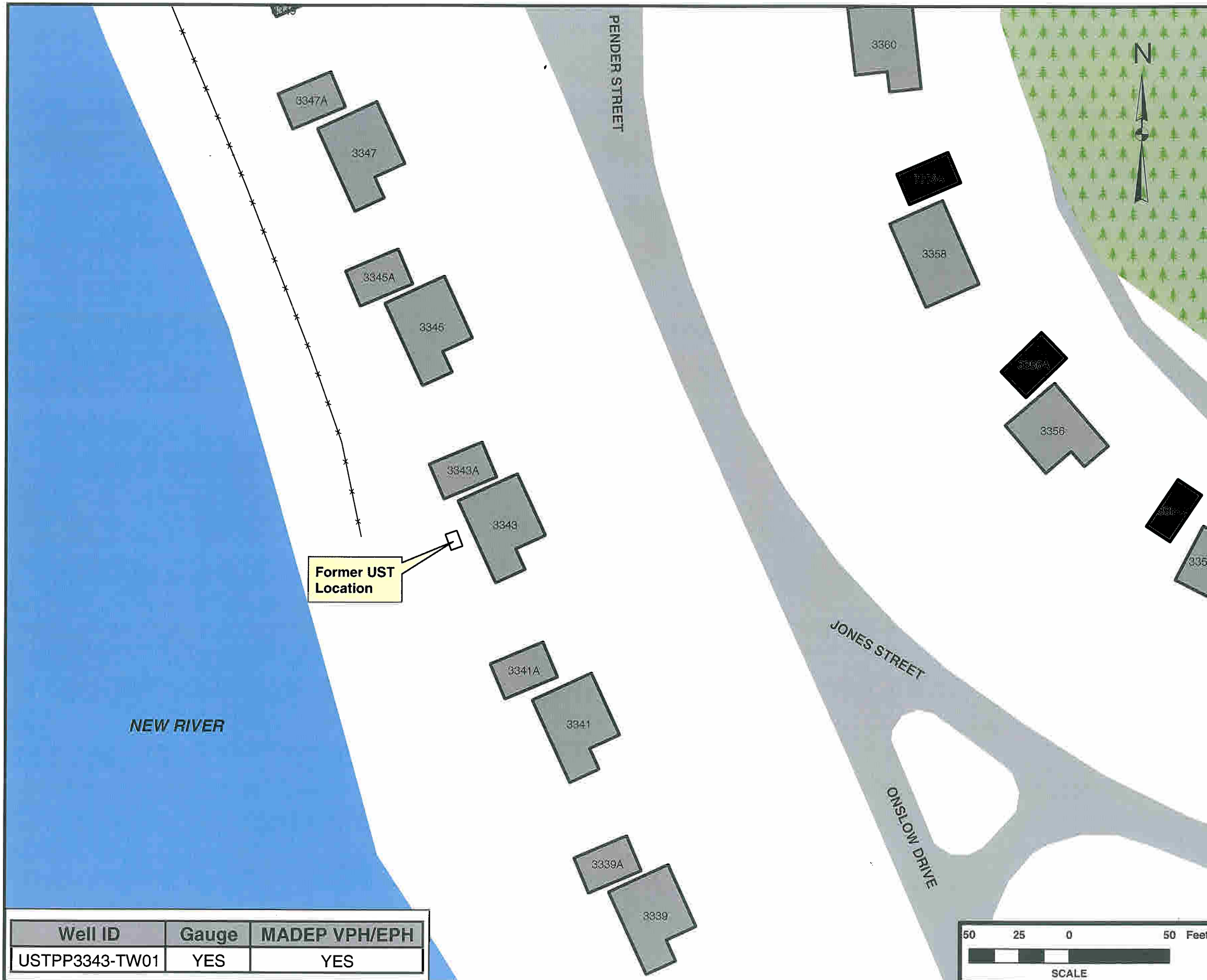

Well ID	Gauge	MADEP VPH/EPH
USTPP3343-TW01	YES	YES

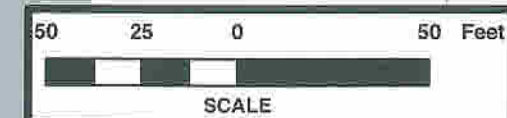

MCB CAMP LEJEUNE UST MANAGEMENT PROGRAM



LEGEND

Monitoring Wells	Buildings and Structures	Vegetation Cover
○ Type I	■ Demolished Structures	■ Forestland
⊕ Type II	■ Oil/Water Separators	■ Scrubland
⊙ Type III	■ Slabs	■ Wetland
⊖ Pumping Well	■ Roads	Airfield Pavement
⊗ Unknown Well Type	■ Driveways	■ HELIPAD
● Water Supply Wells	■ Parking Lots	■ RAMP
■ Above Ground Storage Tank	■ Surface Water Bodies	■ RUNWAY
■ Underground Storage Tank	■ Creeks and Streams	■ SHLDR_OVERRUN
— Railroad Tracks		■ TAXIWAY
Walls and Fences		
⊗ FENCE		
△ GATE		
— WALL		

NOTES

1. Site not currently being sampled (Last sampled November 2004). Site should be sampled in July 2007. Monitoring contractor needs to be determined.
2. Samples to be collected between July 1 and July 31, 2007. Results due to CATLIN in EDD format by September 1, 2007.

NOTE: The previous groundwater sample collected was from a temporary well which has been subsequently abandoned. Therefore, it is recommended that another temporary well be installed to collect the proposed groundwater sample.



**SITE PP-3354
MONITORING PLAN
YEAR 2007**

FIGURE

12

Job No.: 205-002	Date: DEC 2006	Scale: AS SHOWN	Drawn By: SAC	Checked By: MEM
------------------	----------------	-----------------	---------------	-----------------

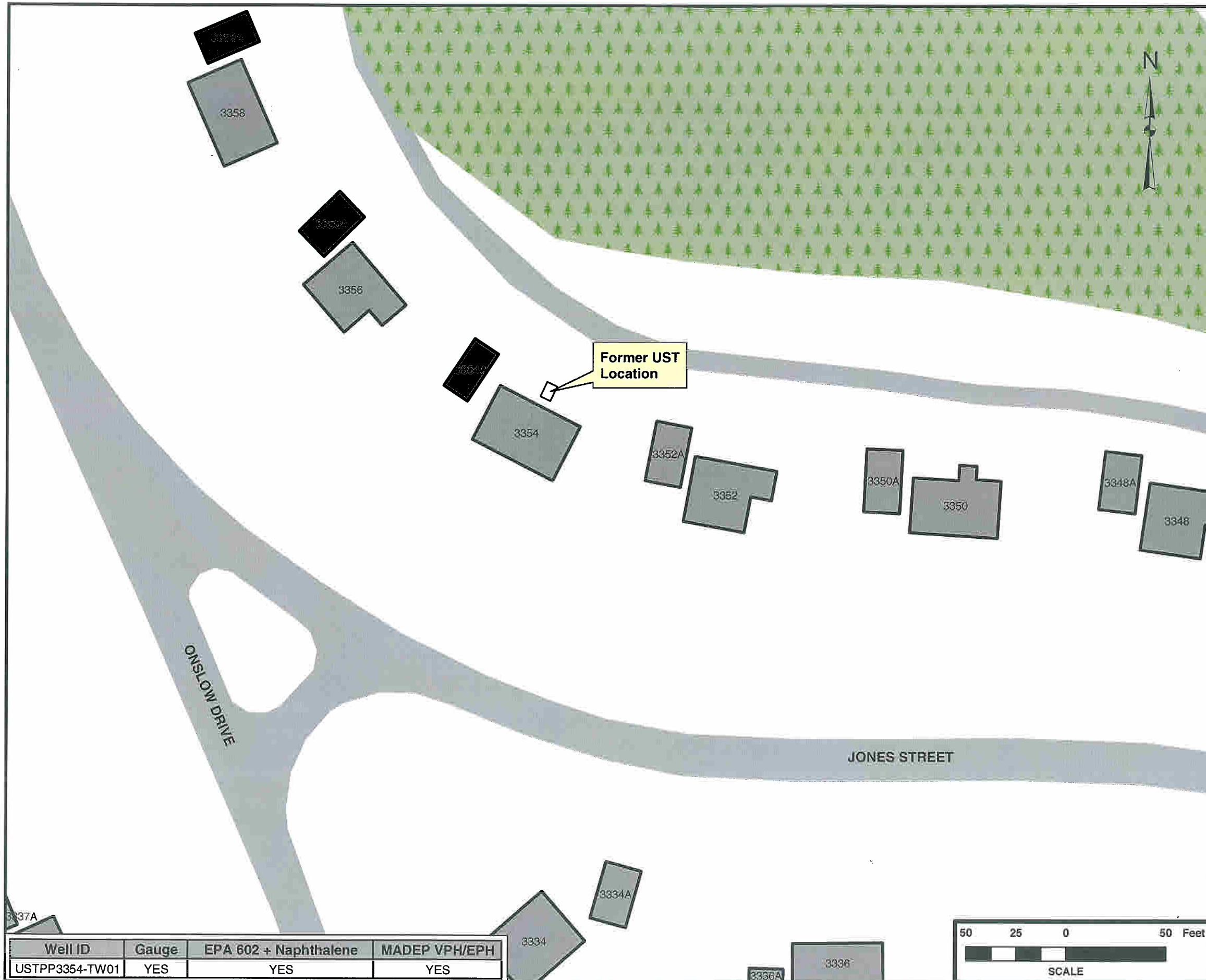

Well ID	Gauge	EPA 602 + Naphthalene	MADEP VPH/EPH
USTPP3354-TW01	YES	YES	YES

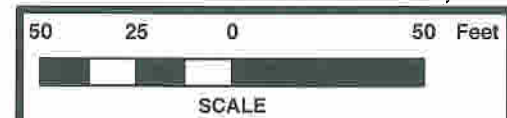

MCB CAMP LEJEUNE UST MANAGEMENT PROGRAM



LEGEND

- | | | |
|-----------------------------|---------------------------------|--------------------------|
| Monitoring Wells | Buildings and Structures | Vegetation Cover |
| ○ Type I | ■ Demolished Structures | ■ Forestland |
| ⊕ Type II | ■ Oil/Water Separators | ■ Scrubland |
| ⊙ Type III | ■ Slabs | ■ Wetland |
| ⊖ Pumping Well | ■ Roads | Airfield Pavement |
| ⊗ Unknown Well Type | ■ Driveways | ■ HELIPAD |
| ● Water Supply Wells | ■ Parking Lots | ■ RAMP |
| ■ Above Ground Storage Tank | ■ Surface Water Bodies | ■ RUNWAY |
| ■ Underground Storage Tank | ■ Creeks and Streams | ■ SHLDR_OVERRUN |
| — Railroad Tracks | | ■ TAXIWAY |
| Walls and Fences | | |
| ⊗ FENCE | | |
| △ GATE | | |
| — WALL | | |

NOTES

1. Site not currently being sampled (Last sampled November 2004). Site should be sampled in July 2007. Monitoring contractor needs to be determined.
2. Samples to be collected between July 1 and July 31, 2007. Results due to CATLIN in EDD format by September 1, 2007.

NOTE: The previous groundwater sample collected was from a temporary well which has been subsequently abandoned. Therefore, it is recommended that another temporary well be installed to collect the proposed groundwater sample.



**SITE TT-3165
MONITORING PLAN
YEAR 2007**

FIGURE
14

Well ID	Gauge	MADEP VPH/EPH
USTTT3165-TW01	YES	YES

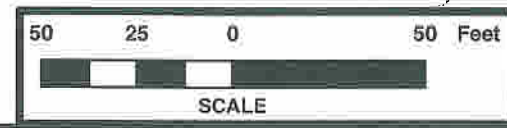

MCB CAMP LEJEUNE UST MANAGEMENT PROGRAM



LEGEND

- | | | |
|--|---|--|
| Monitoring Wells
○ Type I
⊕ Type II
⊗ Type III
⊙ Pumping Well
⊠ Unknown Well Type
● Water Supply Wells
■ Above Ground Storage Tank
■ Underground Storage Tank
— Railroad Tracks
— FENCE
— GATE
— WALL | Buildings and Structures
■ Buildings and Structures
■ Demolished Structures
■ Oil/Water Separators
■ Slabs
■ Roads
■ Driveways
■ Parking Lots
■ Surface Water Bodies
■ Creeks and Streams | Vegetation Cover
■ Forestland
■ Scrubland
■ Wetland
Airfield Pavement
■ HELIPAD
■ RAMP
■ RUNWAY
■ SHLDR_OVERRUN
■ TAXIWAY |
|--|---|--|

NOTES

1. Site not currently being sampled (Last sampled November 2004). Site should be sampled in July 2007. Monitoring contractor needs to be determined.
2. Samples to be collected between July 1 and July 31, 2007. Results due to CATLIN in EDD format by September 1, 2007.

NOTE: The previous groundwater sample collected was from a temporary well which has been subsequently abandoned. Therefore, it is recommended that another temporary well be installed to collect the proposed groundwater sample.



**SITE TT-3233
MONITORING PLAN
YEAR 2006**

FIGURE

15

Job No.: 205-002	Date: DEC 2006	Scale: AS SHOWN	Drawn By: SAC	Checked By: MEM
---------------------	-------------------	--------------------	------------------	--------------------

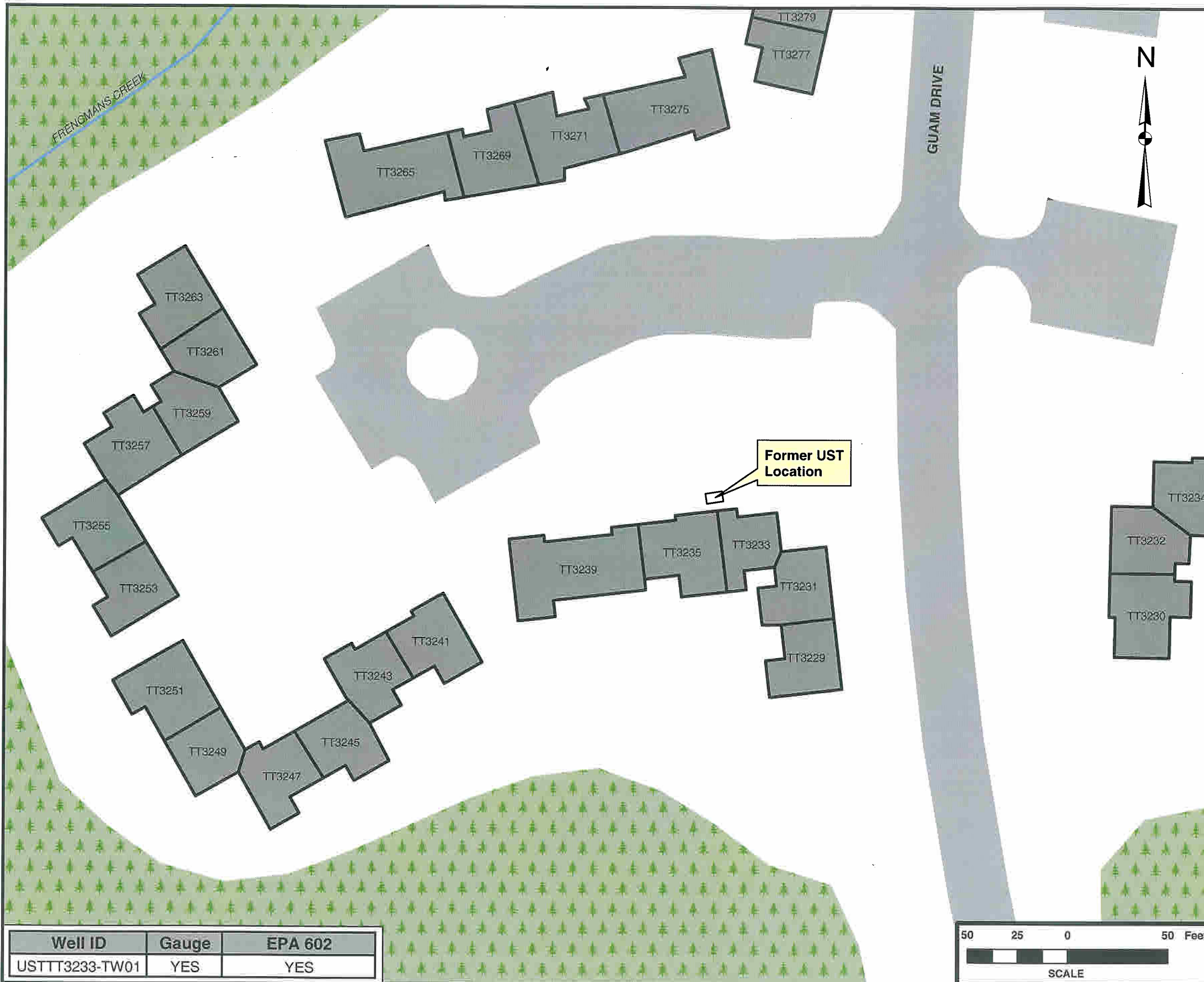

Well ID	Gauge	EPA 602
USTTT3233-TW01	YES	YES